

No 306 ALBANY is situated in the N.W. quarter of S2, T10, R15.

"Ohio Company's purchase".

Atton, Center, Lee, and Williams streets are each 75 links wide at right angles. Clinton and Wilks streets are each 91 links in width at right angles. The bearing of Clinton is N. 83 1/2° E. Wilks bears N. 28° E.

Each lot (except fractional) north of Clinton street is 2 chains 56 links in length North & south, and 91 links in width, parallel to the streets they join.

Lots north of Atton & south of Clinton streets are 2 chains 50 links in length and 91 links in width, parallel to Atton & Clinton (except Nos 29 & 30 which are fractional)

Willow Alley is 25 links in width at right angles.

A stone is set at the S.W. corner of lot No 21 marked "J. H. 21. 1838" also a stone at the S.E. corner of lot No. 24 marked "J. E. 24. 1838"

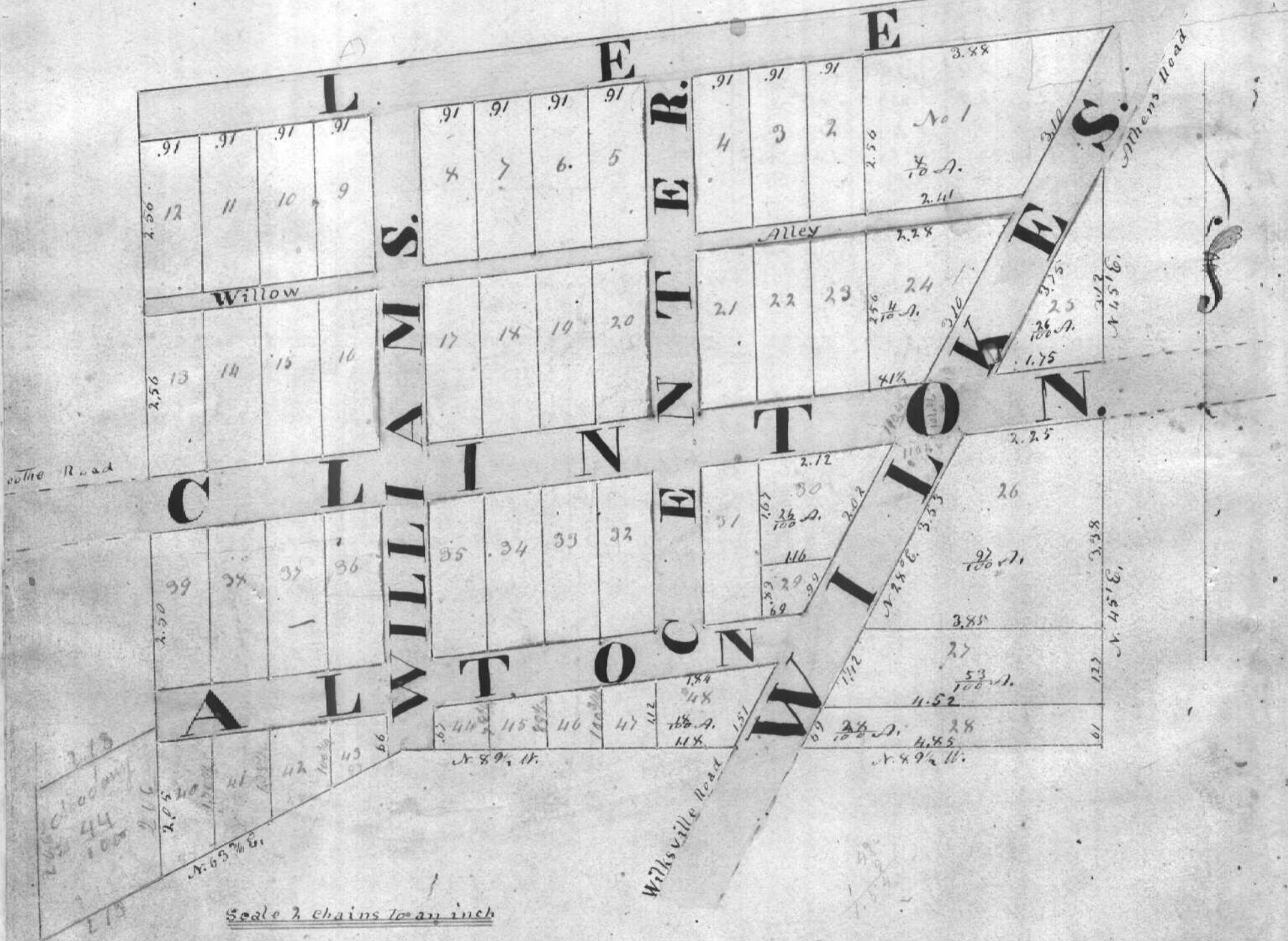

Surveyed April 25th Recorded May 4th 1838 for Mr. Graham.

E. H. Moore D. C. S.
J. B. Pruden C. S.