

W HOUSEHOLDER ET AL

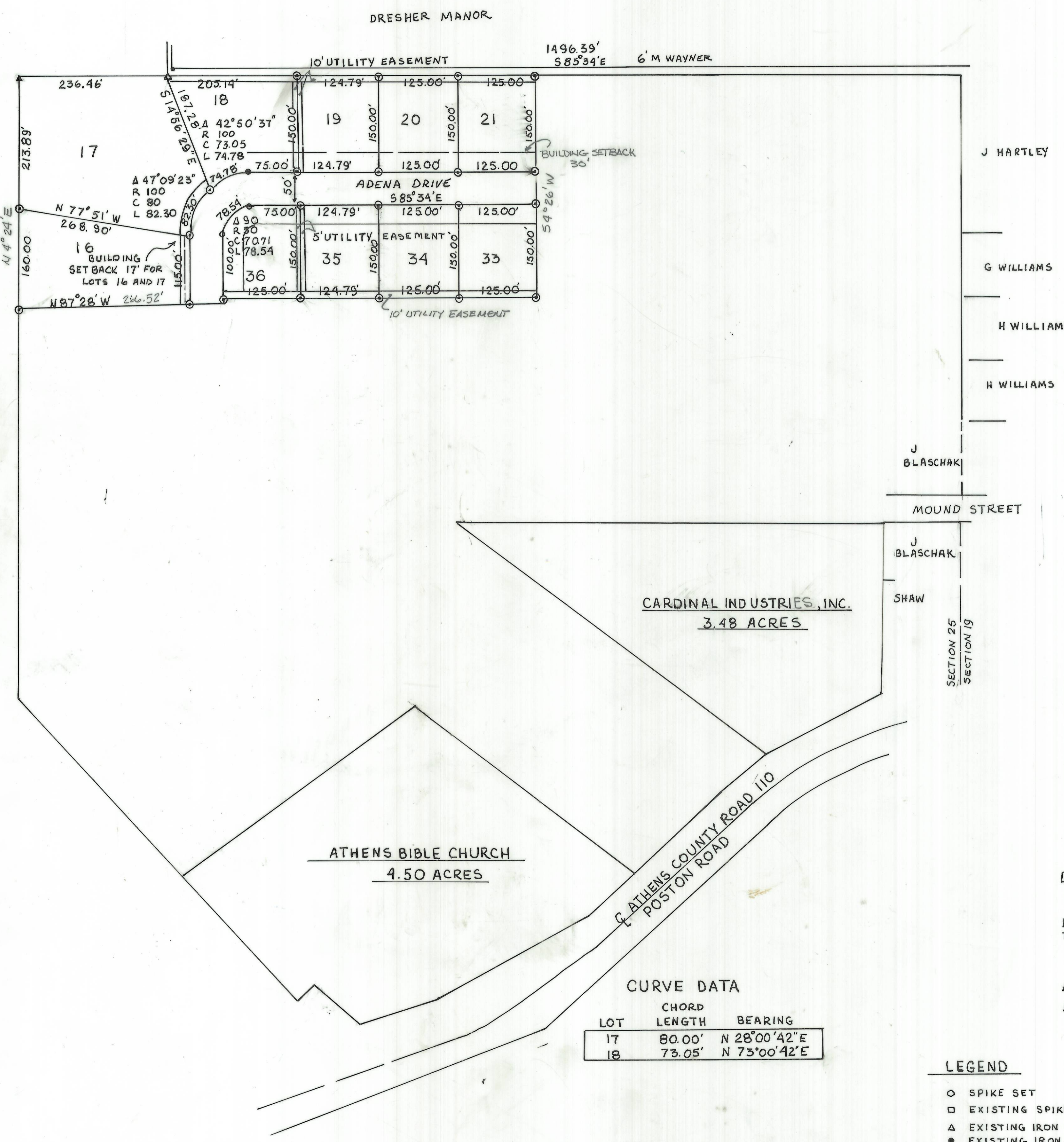

ENVELOPE: 39A

ADENA PARK SUBDIVISION III -
SECTION 25
DOVER TWP

As recorded in Vol. 346 page 1 & Vol. 375 page 569
Situating in the Township of Dover, County of Athens, State of Ohio, and being a part of River Lots 350 and 351 in the southeast quarter of Section 25, Township 10, Range 14, containing 6.69 ACRES.

The undersigned, Craig S. and Ruth A. Hixson, and Gregory Linscott, a single man, do hereby certify that this plat correctly represents their Adena Park Subdivision, Phase III, lots numbered 16, 17, 18, 19, 20, 21, 33, 34, 35 and 36, and do hereby accept this plat of same and dedicate to public use as such all or parts of the roads shown herein and not heretofore dedicated.

The undersigned further agrees that any use of improvements made on this land shall be in conformity with all existing valid zoning, platting, health or other lawful rules and regulations of the City of Athens, Ohio, for the benefit of itself and all other subsequent owners or assigns, taking title from, under, or through the undersigned.

The dimensions of the lots and streets are shown on the plat in feet and decimals thereof. Easements shown on this plat are for the construction, operation, maintenance, repair, replacement or removal of water, sewer, electric, telephone, or other utility lines or services and for providing ingress or egress to the property for said purposes, and are to be maintained as such forever.

In Witness whereof, Craig S. and Ruth A. Hixson have herunto set their hands this 27th day of February, 1984.

Witness Mark Fidler Signed Craig Hixson
Ruth Hixson
Gregory Linscott

Notary Public, State of Ohio
My commission expires Oct. 26, 1985
Commission recorded in Athens Co.

STATE OF OHIO
COUNTY OF ATHENS

Before me, a Notary Public in and for said County, personally came Craig Hixson, Ruth Hixson, Gregory Linscott who acknowledged the signing of the foregoing instrument to be their voluntary act and deed for the purposes therein expressed.

In Witness whereof, I have herunto set my hand and affixed my official seal this 27th day of February, 1984. By Mark Fidler

SURVEYORS AND ENGINEERS CERTIFICATE
Surveyed by Larry S. Riley, P.S. #6838, Wellston, Ohio, and plotted by Tim L. Snider, P.E. #43567, Athens, Ohio.

We do hereby certify that we have surveyed the premises and prepared this plat, and that said plat is correct.

Larry S. Riley
Larry S. Riley
Registered Surveyor Ohio #6838

Tim L. Snider P.E.
Tim L. Snider
Registered Professional Engineer Ohio #43567

Approved this _____ day of _____, 1984. David E. Adams
Chairman, Athens
City Planning Commission

Approved this 17th day of August, 1984. Harpert R. Green
Clerk of City Council

Approved this 17 day of MAY, 1984. James K. ...
Service-Safety Director

Approved this 1 day of MARCH, 1984. Robert ...
Athens County Engineer

Transferred this 4th day of September, 1984. Peter J. Conladis
Athens County Auditor

166475
Filed for Record this 4th day of Sept., 1984 at 10A m.
Recorded this 4th day of Sept., 1984 in Plat Book 10 Page No. 72
Enr. 39A
Wilma Allen
Athens County Recorder

DECLARATION OF PROTECTIVE COVENANTS
ADENA PARK SUBDIVISION

FOR DECLARATION OF PROTECTIVE COVENANTS APPLICABLE
TO THE ADENA PARK SUBDIVISION SEE ATTACHED SHEETS.

AREA OF PHASE 5.91 ACRES
AREA OF ROAD 0.78 ACRES

LEGEND

- SPIKE SET
- EXISTING SPIKE FOUND
- △ EXISTING IRON PIN FOUND
- EXISTING IRON PIN
- CONCRETE MONUMENT SET
- IRON PINS SET
- ▨ EXISTING UTILITY EASEMENT

NOTE ALL IRON PINS SET FOR
LOT BOUNDARIES ARE 3/4" Ø STEEL BEARING
A BRASS TAG STAMPED #6838

ADENA PARK SUBDIVISION

SCALE DRAWN BY
ATHENS COUNTY 1"=100' R.J.L.
REVISED 7-26-83

FINAL PLAT

DATE APPROVED BY DRAWING NUMBER
22 JUNE 83 T. L. SNIDER AP-3