

CENTER LINE SURVEY PLAT

ROCK RIFFLE ROAD
 COUNTY ROAD 25
 ATHENS COUNTY, OHIO
 ATHENS TWP. T9,R14
 OHIO COMPANY PURCHASE

FHWA REGION	STATE	PROJECT
5	OHIO	

24
28

ATHENS COUNTY
 CO. RD. 25
 ISSUE 1 PROJECT

1
5

ENVELOPE: 24B
 COUNTY RD 25 - ROCK RIFFLE ROAD
 ATHENS TWP

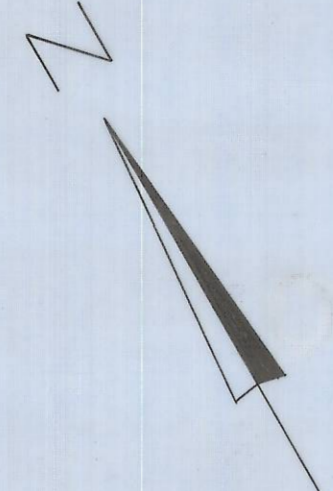

CURVE DATA

P.I. 11+21.94
 $\Delta = 12^{\circ} 33' 00''$ LT.
 $D = 3^{\circ} 00' 00''$
 $R = 1,909.86'$
 $L = 418.33'$
 $T = 210.01'$
 $E = 11.51'$
 *ATH-33-16.17

CURVE DATA

P.I. 24+67.34
 $\Delta = 5^{\circ} 52' 06''$ LT.
 $D = 4^{\circ} 00' 00''$
 $R = 1,432.39'$
 $L = 146.71'$
 $T = 73.42'$
 $E = 1.88'$

CURVE DATA

P.I. = 16+97.43
 $\Delta = 14^{\circ} 05' 10''$ RT.
 $D = 4^{\circ} 00' 00''$
 $R = 1,432.39'$
 $L = 352.15'$
 $T = 176.77'$
 $E = 10.89'$

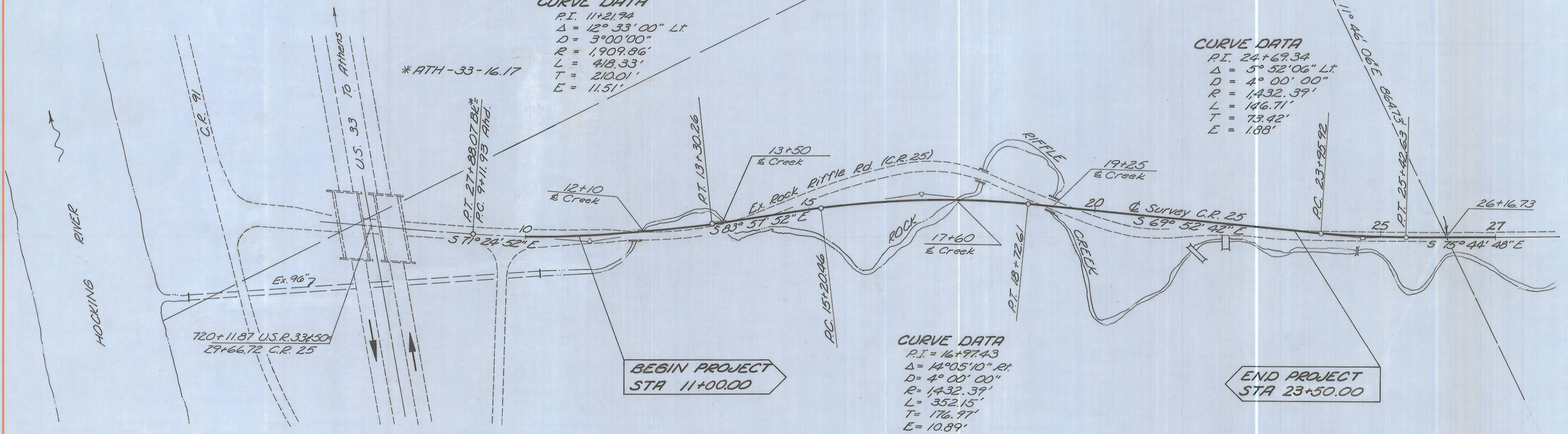

I HEREBY CERTIFY THAT THIS PLAT IS A TRUE DELINEATION OF A SURVEY MADE FOR THE BOARD OF COMMISSIONERS OF ATHENS COUNTY IN 1978 BY Columbus Engineering Consultants, Ltd. *Foralelli Expert* DATE 8-14-1978 Registered Surveyor No. 6045

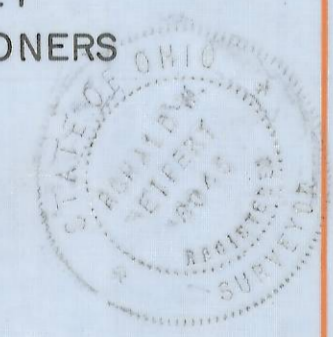

Approved *Rep. Madri*
 Athens County Engineer
 Date 9-20-78

Approved *Glenn C. Smith*
 District 10 Deputy Director
 Date 8-16-78

134210

RECEIVED 9-20-78 AT 2:00 p.m.
 RECORDED September 20, 1978
 PLAT BOOK 10 PAGES 35
 SIGNED *Wilma Allen* ATHENS CO., OHIO
 Recorder *ed.*
 No Fee