

Plat of Subdivision of Out Lots Nos. 117, 118 & 119 with additions thereto in the Village of Athens, Athens Co. Ohio designated "Guthrie Gould & Co's addition". The streets alleys & lots are either parallel or right angles with the original lot lines except where otherwise noted. The distances are marked in feet. Streets are set at N. E. corner of lots Nos. 256, 261, 272, 275, 280, and S. E. corner of lot 295.

The State of Ohio, Athens County ss. Personally appeared before the undersigned a Notary Public for said county, Clakum H. Moore the proprietor of Guthrie Gould and company's addition and acknowledged the above plat to be his voluntary act and deed. Witness my hand and official seal this 15th day of January A. D. 1872.

L. S.

L. W. Jewett, Notary Public.

I certify that the foregoing Plat is correct. John A. Wiley, C. S. & A. C.

Entered and Recorded May 6th 1872.

Attest Josiah B. Allen Recorder.

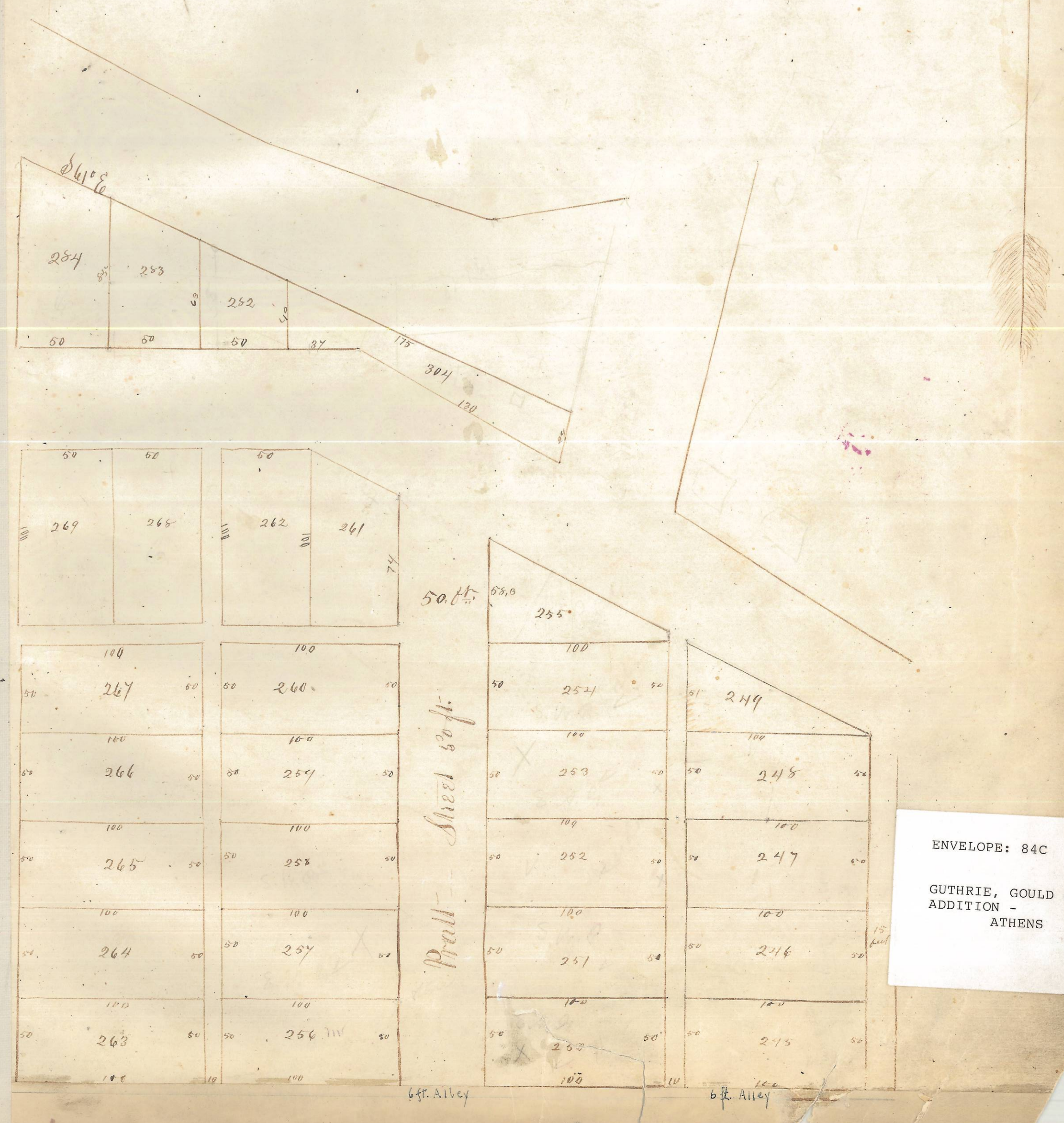

ENVELOPE: 84C
GUTHRIE, GOULD & CO.'S
ADDITION -
ATHENS

6 ft. Alley

6 ft. Alley