

Plat of R. B. Henry's Addition  
 To Amesville, Athens Co., Ohio

ENVELOPE: 135A

R. B. HENRY'S ADDITION  
 AMESVILLE

State of Ohio Athens County Ohio.  
 Be it Remembered, that on the 17 day of  
 May, 1890, before me a Justice of the Peace  
 in and for said County personally came R.  
 Henry who acknowledged the foregoing Plat  
 and notes to be his voluntary act and deed of  
 the use and purpose therein described.  
 Witness my hand at Amesville Ohio this 17  
 day of May A. D. 1890. Geo. E. Henry,  
 Justice of the Peace

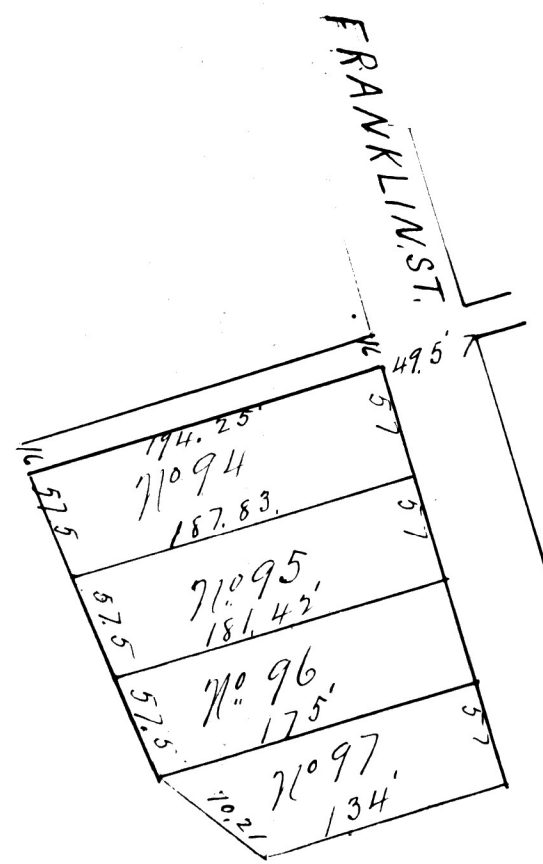

R. B. Henry's Addition to the Village  
 of Amesville, in Ames Township, situated  
 in Sec. 3, in Township 6, Range 13, of  
 the Ohio Company's Purchase. The distances  
 are taken in feet, the courses are magnetic  
 I hereby certify the foregoing Plat and notes  
 to be correct. Pries, Mason & Surveyors

Transferred Sept 26 1890  
 A. J. Fraum  
 Auditor

Received Sept 26 1890  
 Recorded Oct 10 1890  
 E. L. Franke