

ENVELOPE: 57B

WHITLAND WOODS SUBDIVISION -  
SECTION 26  
ATHENS TWP

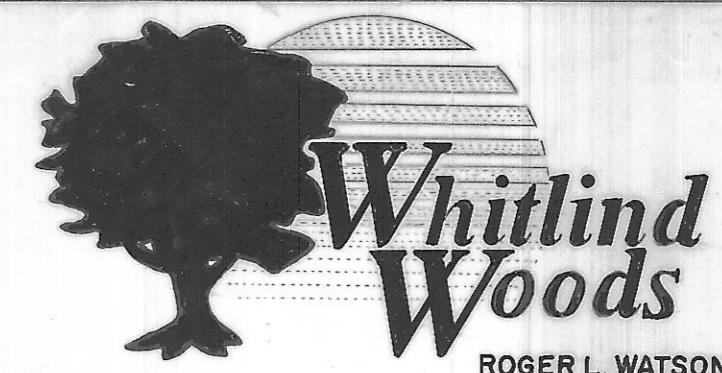

ROGER L. WATSON, OWNER-DEVELOPER

7406 RADFORD ROAD · ATHENS, OHIO 45701 · 614-592-5267

The Athens Country Club  
205-204, 206

62.08 Ac.

See OR 83  
Pg 637 for  
Corrected office

SEC. 22  
SEC. 26

123

Rosser L. & Rachel J. Bateman  
370-215 15.0 Ac.

Donald M. & Mary Anne Flournoy  
364-369 65.0 Ac.

Roger L. & Connie K. Watson  
42-380

(Total Ac by Deed = 71.06 Ac.)

- 69.3253 Acres = Total Ac. by Survey
- 31.7168 Acres = Lots 1-22 in Whitland Woods
- 2.9392 Acres = acreage in dedicated road
- 4.5484 Acres = acreage in Tracts A-D
- 1.9424 Acres = sold in V. 54-P.679
- 28.1785 Acres = Remainder

Thelma Conrath 238-234 & 320-313  
56.0 Ac.

Ronald L. Neal et al.  
12-886  
5.1 Ac.

THOMAS M. & KAREN J. KYLE  
344-773  
0.503 Ac.

WILLIAM H. & MARYS M. McAFEE  
28-143 0.57 Ac.

ROGER A. & RUTH A. MILLER  
12-46  
0.46 Ac.

RAYMOND & MILDRED STEDMAN  
341-103  
0.64 Ac.

PAUL DAVID & BRENDA FINHEARTY STRICKLIN  
307-741  
334-899  
2.51 Ac.  
(2.15 Ac.)  
(0.36 Ac.)

- = iron pin found
- = iron pin set (1/8" capped, rebar)
- = stone found

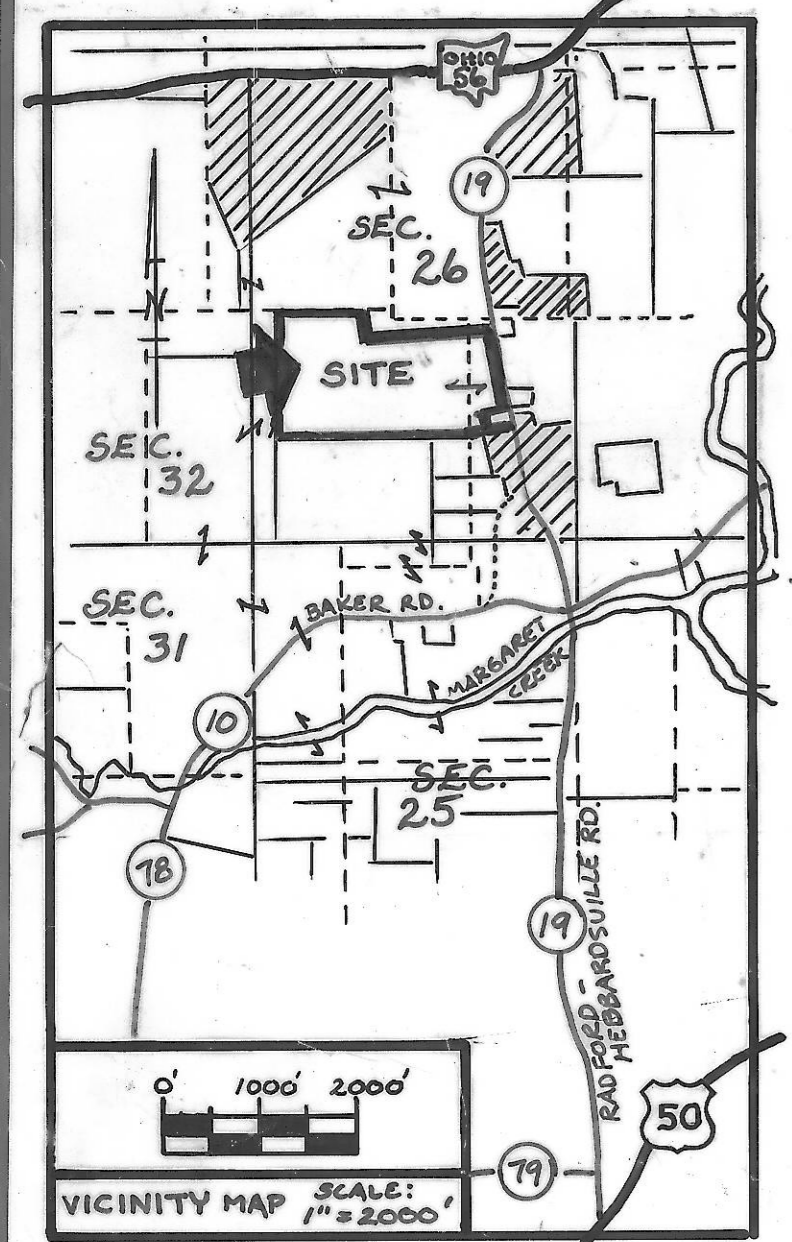

Approved this 6<sup>th</sup> day of March 1989.

Approved this 17<sup>th</sup> day of Feb 1989.

Approved this 17<sup>th</sup> day of May 1989.

Approved this 17<sup>th</sup> day of Feb 1989.

Reviewed this 30<sup>th</sup> day of MARCH 1989.

Approved this 3<sup>rd</sup> day of March 1989

Approved this 4<sup>th</sup> day of April 1989

Approved this 17<sup>th</sup> day of Feb 1989

- Kathy R. ...*  
County Regional Planning Commission
- R. ...*  
Service-Safety Director
- Sharon ...*  
President, City Council
- Laura ...*  
City Planning Commission
- John ...*  
Athens Township Trustees
- Ralph ...*  
County Engineer
- Don ...*  
County Commissioners
- Greg ...*  
City-County Board of Health

Note:  
For Subdivision Restrictions see:  
Vol. 59 Page 437 of the Athens County  
Official Deed Records.

Transferred this 23<sup>rd</sup> day of MAY 1989  
By *Peter B. Conduke*  
Auditor, Athens County, Ohio  
Filed for record this 23<sup>rd</sup> day of May 1989 at 3:29 P.M.

Recorded this day of May 1989 in  
Plat Book 10 Page 113  
File Number 199079  
Recorder, Athens County, Ohio

Note: Sewage Easement is for the flow of effluent from an aerobic sewage system.

Surveyed and Platted by:  
SOUTHEASTERN LAND SURVEYS  
Leonard F. Swoyer, Registered Surveyor  
Phone 614-593-8701  
3428 Pleasant Hill Rd., Athens, Ohio 45701  
February 13, 1989

In witness thereof, Roger L. & Connie K. Watson, owners, hereunto set their hand this 17<sup>th</sup> day of February 1989.  
WITNESS *Gene ...* OWNERS *Roger L. Watson*  
*Gina Dean* *Connie K. Watson*  
STATE OF OHIO s.s.  
COUNTY OF ATHENS  
Before me, a Notary Public in and for said County, personally came Roger L. & Connie K. Watson as owners, who acknowledged the signing of the foregoing instrument to be their voluntary act and deed for the uses and purposes herein expressed.  
In Witness Whereof, I have hereunto set my hand and affixed my official seal this 17<sup>th</sup> day of February 1989.  
Notary Public, Athens County, Ohio  
My commission expires Aug 5, 1992.

We do hereby certify that we have surveyed the above premises and prepared the plat and said plat is correct.  
By: *Leonard F. Swoyer II*  
Leonard F. Swoyer II, Reg. Prof. Land Surveyor Number 6765