

HIGHLAND SURVEYING Ltd.
Registered Professional Land Surveyor

Collins
260-177

N 85°58'01"W 660.41'
N 85°37'15"W 442.83'

Stover
315-604OR

Description checked for
Mathematical Accuracy
ATHENS COUNTY
ENGINEER'S OFFICE
BY: K. Cantelero
DATE: 7/24/02

10.151 Ac.

Description checked for
Mathematical Accuracy
ATHENS COUNTY
ENGINEER'S OFFICE
BY: S. Blausen
DATE: 7-24-02

C & K Investment and
Management Co., Inc
322-2188 OR



N 6°28'22"E 181.39'
N 6°36'47"E 319.36'
N 11°55'28"E 117.83'
S 85°58'01"E 690.00'
N 85°58'03"W 734.24'
694.24'

5.152 Ac.

S 85°58'03"E 40.00'

S.W. corner of
Lease Lot 3

N 6°28'22"E 352.99'
N 9°44'16"E 76.93'
N 83°09'49"W 62.49'
N 85°53'33"W 289.04'
N 44°13'13"E 566.35'

5.082 Ac.

- = Iron Pin Set
- = Iron Pin
Previously Set
- ⊕ = Iron Pin Found
- = Stone Found
- ▲ = Railroad Spike
Found

Pitts
261-986 OR
2.16 Ac.

N 14°26'10"E 283.96'
N 85°30'51"W 66.79'
N 85°21'30"W 202.55'

N 81°56'43"W 194.93'
S 3°28'44"W 728.34'

CR-76

TR-53

Scale 1"=150'

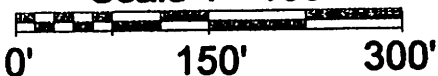

PLAT OF SURVEY OF 3 TRACTS

SURVEYED FOR ALEX COULADIS

SUBDIVISION LEASE LOT 2

TOWNSHIP ALEXANDER SECTION 22 TOWN B RANGE 14

CORPORATION — COUNTY ATHENS STATE OHIO

SCALE 1"= 150' DATE JULY, 2002

Kenneth E. Highland
80 Fayette St.
Nelsonville, Ohio 45764
740-753-1264

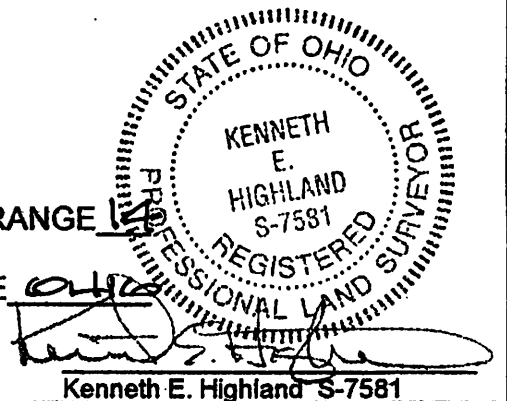

22-17H

Alex-22
5.082 Ac.
5.152 Ac.
10.151 Ac.

SA

1 - Ac. 10.151
2 - Stone Paved
2 - 5.082 Ac. Paved
1 - 5.152 Ac. Paved
1 - 5.082 Ac. Paved

5.082 Ac.

CG-10