

Description Checked for
Mathematical Accuracy
Athens County
ENGINEER'S OFFICE

BY: Brann M. Branner
DATE: 12-31-14

Legal Description Pre-Approval
APPROVED
All transfers are subject to
Athens County Conveyance Standards

JAN 02 2015

Jill Thompson
Athens County Auditor

DESCRIPTION OF A 14.36 ACRE TRACT

Situated in Farm-lot #1, Section 13, T.8, R.14, Alexander Township, Athens County, Ohio and being a part of the Albert V. Blazeivicius Tracts as described in Volume 222, Page 150 of the Official Records of Athens County, Ohio and being more particularly described as follows:

Commencing at an iron pin set at the base of a fence corner post, and bearing
N 86° 27' 05" W, 8.36 chains (deed) from the South-east corner of F.L.#1
Thence, along the West-line of Gorman (205-90 O.R.)
N 4° 40' 45" E, 919.10 feet to a railroad spike set in Cherry Ridge Road and being the point of
beginning for the tract of land herein described:

Thence, along a new line created by this survey:

N 5° 59' 51" E, 876.83 feet to an iron pin set in Grantor's north -line;
thence, along the Southlines of Martin (305-851 D.R.) and Graham (97-603 O.R.)
S 86° 08' 11" E, 697.72 to a point in Cherry Ridge Road, passing an iron pin set at 680.65 feet;
Thence, along Cherry Ridge Road:
S 13° 20' 04" W, 124.49 feet;
S 9° 17' 04" W, 659.89 feet;
S 10° 08' 43" W, 89.62 feet;
S 12° 22' 10" W, 60.93 feet;
S 23° 04' 02" W, 20.68 feet;
S 38° 10' 54" W, 8.60 feet;
S 54° 34' 59" W, 16.30 feet;
N 89° 05' 56" W, 69.92 feet;
N 82° 45' 49" W, 306.29 feet;
N 69° 52' 12" W, 131.13 feet;
N 65° 33' 10" W, 110.01 feet to the point of beginning and containng 14.36 acres of which 5.8 acres are
out of Parcel# B010010042400 and 8.56 acres are out of Parcel # B010010042500

Subject to all easements and ridgts of way of record.

Iron pins set are 5/8 inch by 30 inch long rebar w/ plastic I.D. Cap stamped Branner P.S. 6805

Bearing : Grid North- N.A.D. 83

The above description is based on a field survey completed December 2014 by

John M. Branner P.S. 6805

John M. Branner





Note A:
Alexander Twp. Trustees
Hudnall Cemetery- No deed ref.

double hickory

See Note A

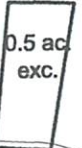

MARTIN WILLIAM CARL
305-851 D.R.

GRAHAM JEFFREY A
97-603 O.R.

BLAZEVICIUS ALBERT V
222-150 O.R.

B010010042500
(33.2 ac.)

14.36 Acres

B010010042500
8.56 ac.

B010010042600
(22.07 ac.)

55.77 Acres
-0.5 ac exception for cemetery
55.27 ac.

Description Checked for
Mathematical Accuracy
Athens County
ENGINEER'S OFFICE

BY: *Perash Withers*
DATE: 12-31-14

Gorman
Legal Description Pre-Approval
APPROVED
All transfers are subject to
Athens County Conveyance Standards

JAN 02 2015

Jill Thompson
Athens County Auditor

Line	Bearing	Distance
1	N 5° 01' 12" W	158.40'
2	N 12° 57' 34" E	44.03'
3	N 38° 51' 30" E	48.79'
4	N 56° 11' 12" E	85.81'
5	N 58° 27' 13" E	71.83'
6	N 38° 11' 45" E	90.46'
7	N 8° 43' 20" E	35.91'
8	N 0° 21' 33" W	417.83'
9	N 5° 04' 53" E	58.46'
10	N 14° 27' 5" E	65.12'
11	N 59° 06' 25" E	240.68'
12	N 4° 09' 38" W	420.54'
13	S 13° 20' 4" W	124.49'
14	S 10° 08' 43" W	89.62'
15	S 12° 22' 10" W	60.93'
16	S 23° 04' 2" W	20.68'
17	S 38° 10' 54" W	8.60'
18	S 54° 34' 59" W	16.30'
19	N 89° 05' 56" W	69.92'
20	N 82° 45' 49" W	306.29'
21	N 69° 52' 12" W	131.13'
22	N 65° 33' 10" W	110.01'

Survey of Two Tracts
in L.L.#1, L.L.#8 in
Section 13, T.8, R.14
Alexander Township
Athens County, Ohio
Surveyed December 2014



John M. Branner
John M. Branner P.S. 6805
62 East First Street
The Plains, Ohio 45780



Scale 1 inch = 300 feet
○ = iron pin set 5/8"x30" rebar w/ plastic l.d. cap
△ = rail road spike set
Bearings: Grid North- N.A.D. 83
Ref. Docs.: Tax Plat-Deeds

Cherry Ridge Rd.
L8

Cherry Ridge Rd.

Cherry Ridge Rd.
L13

Existing fence-line
S 4° 40' 45" W 919.10'

I.P. set@
fence cor.

8.36 ch. (deed)

S.E. Cor of F.L.#1

f.l. #1 Section 13 Alexander Twp.
Meigs County N 86° 27' 5" W

1691.22'

+680.65'

B010010042400
5.8 ac.
F.L.#1
F.L.#8
S 9° 17' 4" W 659.89'

L19
L15
L14
L16
L17
L18

S 5° 59' 51" W 876.83'
N 5° 59' 51" E 876.83'

S 86° 08' 11" E 697.72'

S 86° 01' 44" E 965.49'
L.L.#2
L.L.#1

N 4° 09' 38" W 420.54'

N 63° 29' 5" E 532.01'

L11

L9

L10

L8

L11

L12

L13

L14

L15

L16

L17

L22

L21

L20

L19

L15

L14

L16

L17

L18