

Phone 740-753-1264
Fax 740-753-1264

Description of a 1.123Acre Tract

Situated in Fraction 1, Section 26, T-8, R-14, Alexander Township, Athens County, State of Ohio and being a part of a tract as described in Volume 269, Page 182 of the Official Records of Athens County and being more particularly described as follows:

BEGINNING at an iron pin set that bears South 1°51'27"West, 213.79 feet from the Southwest corner of Fraction 2 of Section 20,
THENCE along grantors east line South 1°51'27"West, 489.04 feet to an iron pin set at a fence corner (passing an iron pin found at 53.25 feet),

THENCE North 86°12'05"West, 94.26 feet to an iron pin set,

THENCE North 0°18'37"East, 482.55 feet to an iron pin set,

THENCE North 90°00'00"East, 107.29 feet to the point of beginning and containing 1.123 acres.

This tract is being transferred to an adjoining owner
This tract must remain continuous and contiguous with the 1.115 acre tract to the north

Bearings are to an assumed meridian and are for angular determination only

Subject to all Easements and Rights of Way of Record

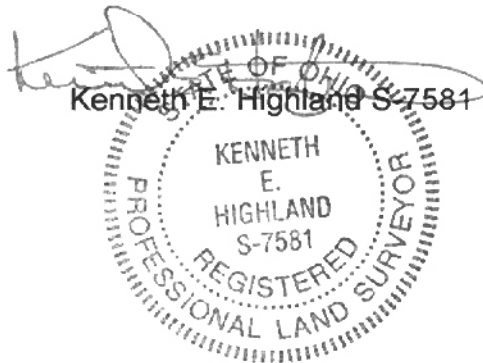

Description Checked for
Mathematical Accuracy
Athens County
ENGINEER'S OFFICE
BY: S. Blaise
DATE: 5-18-04

Point	Direction	Distance	Northing	Easting	Elevation
Database opened: Tuesday, May 18, 2004 6:01 am.					
Assigned point					
1			5000.00000	5000.00000	0.000
Start					
1			5000.00000	5000.00000	0.000
Raw:	s01.5127w	489.04			
TR	S 1°51'27.0" W	489.040			
2			4511.21697	4984.14835	0.000
Raw:	n86.1205w	94.26			
TR	N 86°12'05.0" W	94.260			
3			4517.46167	4890.09543	0.000
Raw:	n00.1837e	482.55			
TR	N 0°18'37.0" E	482.550			
4			5000.00460	4892.70860	0.000
Raw:	n90.0000e	107.29			
TR	N 90°00'00.0" E	107.290			
5			5000.00460	4999.99860	0.000
IN	S 16°53'06.8" E	0.005			
1			5000.00000	5000.00000	0.000

Area = 48921.834 Sq. Feet or 1.123 Acres

Database Saved: Tuesday, May 18, 2004 6:03 am.

HIGHLAND SURVEYING Ltd.
Registered Professional Land Surveyor

Scott
269-182 OR

Jones
130-773 OR



N 90°00'00"E
107.29'

1.123 Ac.

N 0°18'37"E
482.55'

S 1°51'27"W
489.04'

+53.25'

This point bears
S 1°51'27"W, 213.79'
from the S.W. corner of
Fraction 2 of Section 20

NOTE: This is a
transfer between
adjoining owners

- = Iron Pin Set
- = Iron Pin Found

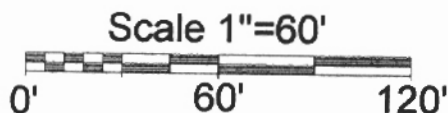

Russ
216-327

N 86°12'05"W
94.26'

Description Checked for
Mathematical Accuracy
Athens County
ENGINEER'S OFFICE

BY: S. Blausch
DATE: 5-18-04

PLAT OF SURVEY OF A 1.123 AC. TRACT

SURVEYED FOR VALERDA SCOTT

SUBDIVISION FRACTION 1

TOWNSHIP ALEXANDER SECTION 26 TOWN 8 RANGE 14

CORPORATION - COUNTY ATHENS STATE OHIO

SCALE 1"= 60' DATE MAY 2004

Kenneth E. Highland
80 Fayette St.
Nelsonville, Ohio 45764
740-753-1264

Kenneth E. Highland S-7581



ALY # 26