

Larry Keirns

Description of 11.158 Acres

Situated in Section 33, Town 6, Range 13, Ames Township, Athens County, Ohio and being more particularly described as follows;

Commencing at the southeast corner of Said Section 33; thence N 4°54'20" E 2169.42 feet to a point in the center of McDougal Road (Co Rd 28); thence along the center of said road N 70°50'10" W 289.40 feet; thence N 78°20'10" W 576.18 feet; thence N 87°34'10" W 298.00 feet to the intersection with LaFollette Road; thence along the center of LaFollette Road N 2°18'41" E 87.42 feet to the point of beginning of the tract herein described;

Thence leaving the road N 80°01'10" W 1127.01 feet to a stone found; thence N 3°30'00" E 425.45 feet to an iron pin set; thence S 78°44'58" E 1248.27 feet to a point in the center of LaFollette Road (passing an iron pin set at 1218.09 feet); thence along the center of said road S 5°00'00" W 35.65 feet to an iron pin found; thence S 23°28'40" W 320.26 feet; thence S 11°29'48" W 48.15 feet to the point of beginning containing 11.158 acres.

Prior deed reference; Volume 19, Page 523 Official Records of Athens County.

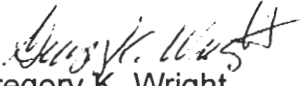
Gregory K. Wright
Registered Surveyor S-6535
11684 Channingway Blvd.
The Plains, OH 45780

Description checked for
Mathematical Accuracy
ATHENS COUNTY
ENGINEER'S OFFICE
BY: S. Blawie
DATE: 1-5-2000

000150

AMS # 33

Roberty & Rita Keirns
19-523

Plat of Survey of 11.158 Acres
Sited in Section 33, Town 6, Range 13,
Ames Township, Athens County, Ohio
Surveyed Dec 1999 for:
Larry Keirns

Oscar
Carson
342-155

Gregory K. Wright
Gregory K. Wright

LaFollette
Road

N 03°30'00" E
425.45'

- ▲ = Railroad Spike Found
- ▲ = Railroad Spike Set
- ⊙ = Iron Pin Found
- = Iron Pin Set
- = Stone Found
- ⊙ = Monument Found

David
Richards
379-819

486,044 sq.ft.
11.158 acres

Roberty & Rita Keirns
19-523

1127.01'
N 80°01'10" W

Roberty & Rita Keirns
19-523

Description checked for
Mathematical Accuracy
ATHENS COUNTY
ENGINEERS OFFICE
BY: *S. Blausen*
DATE: 1-5-2000

LINE TABLE		
LINE	BEARING	LENGTH
L1	S05°00'00"W	35.65'
L2	S11°29'48"W	48.15'

GRAPHIC SCALE



(IN FEET)
1 inch = 100 ft.

000152

McDougal Rd
Co Rd 28

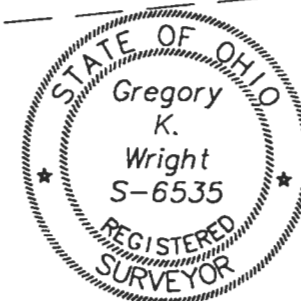

Gregory K. Wright
Professional Engineer
Professional Surveyor

11684 Channingway Blvd
The Plains, Ohio 45780
740-797-4142
FAX 740-797-8623

P-000249