

Situate in Fraction 12, Section 9, and Fraction 12, Section 10, T6, R13, Ames Township, Athens County, Ohio. Being a part of the Betty Calentine parcel as described in D.R. Vol. 371, PG. 393, Athens County Recorder's Office and being more fully described as follows:

Commencing at an iron pin found at the northwest corner of Section 9, thence along the north line of said Section 9 S 86°24'58" E 994.10 feet to an iron pin set, said iron pin being the **Point-of-Beginning** for the parcel herein described;

Thence from this Point-of-Beginning along the north line of Section 9 S 86°25'45" E 647.91 feet to an iron pin set;

Thence leaving north line of Section 9 N 03°34'05" E 157.82 feet to a point in the center of Athens County Road 35 (reference: iron pin set at 127.82 feet);

Thence along the center of said County Road 35 the following six courses:

- S 78°24'42" E 53.36 feet;
- S 88°02'21" E 34.55 feet;
- N 77°19'50" E 158.42 feet;
- N 68°25'39" E 121.23 feet;
- N 55°16'19" E 66.64 feet;
- N 39°57'13" E 181.14 feet to a railroad spike set;

Thence leaving said County Road 35 along the center of an existing unimproved road the following 10 courses:

- S 07°09'29" E 62.33 feet to an iron pin set;
- S 23°34'40" W 325.78 feet;
- S 10°19'39" E 117.67 feet;
- S 52°18'52" E 111.43 feet;
- S 79°14'43" E 263.92 feet to an iron pin set;
- S 88°10'11" E 90.16 feet;
- N 76°55'08" E 91.05 feet;
- S 86°52'51" E 100.31 feet;
- S 72°15'28" E 163.32 feet;
- S 60°03'59" E 78.01 feet to an iron pin set;

Description checked for  
 Mathematical Accuracy  
 ATHENS COUNTY  
 ENGINEER'S OFFICE  
 BY: R. Cantor  
 DATE: 10/29/01

Ames # 5

Thence S 22° 50' 08" E 935.02 feet to an iron pin set;

Thence N 87° 16' 50" W 2323.37 feet to an iron pin set (reference: iron pin found at 796.17 feet);

Thence N 01° 31' 02" E 1060.47 feet to the Point-of-Beginning.

Containing 50.01 acres (2.27 acres of Section 10 and 47.77 acres of Section 9) as surveyed October, 2001 under the direction of Robert C. Canter, P.S. 7226.

Subject to all legal easements and right and ways.

Plat of Survey is attached herewith and made a part thereof.

Iron pins set are 5/8"x30" rebar with plastic cap stamped "CANTER 7226".

*Robert C. Canter*



# PLAT of SURVEY

SITUATE IN FRAC. 12, SECTION 9 AND FRAC. 12, SECTION 10, T6, R13, AMES TOWNSHIP, ATHENS COUNTY, OHIO. BEING A PART OF THE BETTY CALENTINE PARCEL AS DESCRIBED IN D.R. 371, PG. 393, ATHENS COUNTY RECORDER'S OFFICE.

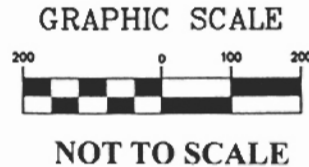

LINE TABLE		
LINE	LENGTH	BEARING
L1	157.82	N03°34'05"E
L2	53.36	S78°24'42"E
L3	34.55	S88°02'21"E
L4	158.42	N77°19'50"E
L5	121.23	N68°25'39"E
L6	66.64	N55°16'19"E
L7	181.14	N39°57'13"E
L8	62.33	S07°09'29"E
L9	325.78	S23°34'40"W
L10	117.67	S10°19'39"E
L11	111.43	S52°18'52"E
L12	263.92	S79°14'43"E
L13	90.16	S88°10'11"E
L14	91.05	N76°55'08"E
L15	100.31	S86°52'51"E
L16	163.32	S72°15'28"E
L17	78.01	S60°03'59"E

2,178,612 Sq. Ft.  
 (2.24 Acres in Section 10)  
 (47.77 Acres in Section 9)  
 51.01 Acres Total

- IRON PIN FOUND
- IRON PIN SET
- △ R/R SPIKE SET

REFERENCES:  
 PRIOR SURVEY BY KUNZE & ASSOC., INC.  
 (LOCATED AT COUNTY AUDITOR'S MAP OFFICE)  
 NGS MONUMENT PID#AB2453

Description checked for  
 Mathematical Accuracy  
 ATHENS COUNTY  
 ENGINEERS OFFICE  
 BY: R. C. Canter  
 DATE: 10/12/01

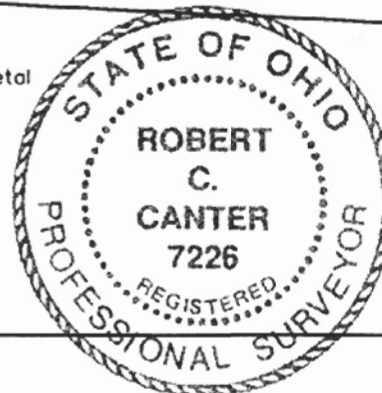

BASIS OF BEARINGS: BASED ON  
 STATE PLANE GRID OHIO-SOUTH 83(95)

SUBJECT TO ALL LEGAL EASEMENTS AND RIGHT OF WAYS.

IRON PINS SET ARE 5/8"x30" REBAR W/CAP  
 STAMPED "CANTER 7226".

IRON PIN FOUND  
 AT 796.17'

ROBERT KING et al  
 370-1021

SURVEYED OCT. 2001 UNDER THE  
 DIRECTION OF ROBERT C. CANTER, P.S. 7226

Robert C. Canter

BETTY CALENTINE  
 371-393

MICHAEL T. & ANN H.  
 CUNNINGHAM  
 O.R. 255-875

DRAWN BY: M. Schloss	DATE: 10-24-01
CHECKED BY: RCC	DRAWING NO.: 21072
DATE: 21072	PAGE: 1 of 1