

Exhibit A

Situate in Lease Lot 40, Township 9, Range 14, Ohio Company Purchase; Section 9, City of Athens, Athens County, Ohio. Being a 1.015 acre part of Charles A. Richmond's Official Record 446 Page 2362 (A02-90800001.00) more particularly described as follows;

Commencing and **Beginning** at the South Corner of Tract Number 6, also the Northwest Corner of Lot 106 of the D.E. Allen Bungalow Addition to Athens (Allendale) as recorded in Plat Cabinet Envelope 269 B.

Thence S51°34'21"W, 278.21' along the North Line of Lot 106 to an iron pin found on the East Line of Mulligan Road.

Thence N32°58'00"W, 161.02' along the East Line of Mulligan Road to a point.

Thence N02°15'00"W, 33.25' along the East Line of Oak Street (30 feet wide) to an iron pin found.

Thence N56°22'57"E, 202.91' leaving the road along a new through Charles A. Richmond's O.R. 446 Pg. 2362 (A02-90800001.00) to an iron pipe found.

Thence S52°00'00"E, 175.00' along the South Line of Tract Number 6 to the Point of Beginning.

Containing 1.015 acres as surveyed under my direct supervision in April 2013.

Basis of Bearings being the South Line of Tract Number 6 being S52°00'00"E and are to be used to determine angular relationships only.

Plat of Survey is attached herewith and made a part thereof.

Subject to all legal easements and rights of way.

Description Checked for  
Mathematical Accuracy  
Athens County  
ENGINEER'S OFFICE  
BY: C.M. Williams  
DATE: 4-30-13



A handwritten signature in blue ink, appearing to be "C.M. Williams", written below the seal.

# Plat of Survey

Situate in Lease Lot 40, Township 9, Range 14, Ohio Company Purchase; Section 9, City of Athens, Athens County, Ohio.

Being 2 new parcels from Charles A. Richmond's Official Record 446 Page 2362.

Parcel 1 having 1.015 acres from A02-90800001.00.

Parcel 2 having 0.825 acres; of which 0.489 acres from A02-90800001.00 and 0.336 acres from A02-90800002.00.

**Notes:**

Basis of bearings being the West Line of Tract No. 6 of the Allendale sub being S06°58'00"E and are to be used to determine angular relationships only.

**References:** Deeds listed, Tax Maps, Plat Envelope 269B the D.E. Allen Bungalow Addition to Athens (ALLENDALE).

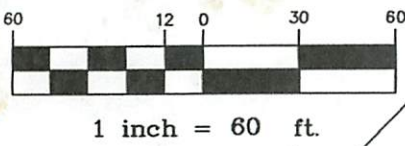

"Ramp J"  
CL Jersey Wall

U.S. RT 33  
ATH-33-16.17  
Sht 94

State of Ohio  
D.R. 321 Pg. 919  
1.01 Ac.

State of Ohio  
D.R. 310 Pg. 7  
0.013 Ac.

190.10'  
N52°39'38"E  
Charles A. Richmond  
O.R. 446 Pg. 2362  
Tract No. 5  
0.29 Ac (deed)

S06°58'00"E  
215.31'

Parcel 2  
0.825 Ac.

(A02-90800002.00) (0.336 Ac.)  
(A02-90800001.00) (0.489 Ac.)

- Legend:**
- Iron Pin Fd
  - Iron Pipe Fd
  - X Fence

James J. Wynn  
O.R. 401 Pg. 69  
Tract No. 6  
4.49 Ac

Charles A. Richmond  
O.R. 446 Pg. 2362  
1.99 Ac (deed)

Parcel 1  
1.015 Ac.

Description Checked for  
Mathematical Accuracy  
Athens County

ENGINEER'S OFFICE

DATE: 5/2/13

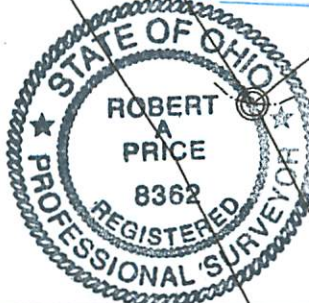

I hereby certify that this Plat and Notes are correct, as surveyed under my direct supervision in April 2013.

Robert A. Price, P.S. 8362

Richard C. Cooley  
D.R. 321 Pg. 923  
Lot 106

2182.Dwg  
Apr 2013

Price Co Land Surveys, LLC.  
Athens, Ohio 740.592.9966

Lot 75

P.o.b. Parcel 2

210.92' Oak St. 30'

N02°15'00"W

202.91'  
N56°22'57"E  
S56°22'57"W

175.00'  
S52°00'00"E  
N52°00'00"W

Commencing  
P.o.b. Parcel 1

N02°15'00"W  
33.25'

Mulligan Rd.

29.2'  
N32°58'00"W  
161.02'

S51°34'21"W  
278.21'

Lot 107