

**DESCRIPTION OF
0.007 Acres**

Situated in Lot 3600, Oakmont Subdivision Phase 1, City of Athens, Town 9, Range 14, Athens Township, Athens County, Ohio, and being more fully described as follows:

Commencing at an iron pin found on the northeast corner of said Lot 3600 on the West Line of Roxbury Drive

Thence, N 66°41'51" W, 17.93 feet to an iron pin set at the point of beginning of the tract herein described;

Thence, N 66°41'51" W, 10.84 feet to an iron pin set;

Thence, N 57°42'15" W, 36.60 feet to an iron pin set;

Thence, N 31°18'13" E, 11.43 feet to an iron pin set;

Thence, S 46°07'35" E, 48.49 feet to an iron pin set;

the **POINT AND PLACE OF BEGINNING.**

CONTAINING: 0.007 acres

Prior Deed Reference _____

Subject to easements, rights-of-way and all covenants and agreements of record.

Charles T. Newman
Charles T. Newman
Registered Surveyor S-8043
66 Elmwood Place
Athens, Ohio 45701



September 25, 2003
C:\My Documents\Descriptions\C Pratt.doc

Description checked for
Mathematical Accuracy
ATHENS COUNTY
ENGINEERS OFFICE
BY: S. Blauser
DATE: 9-29-03

*ATLH
City*

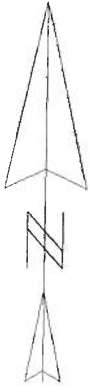

ΣΧΑΛΕ 1 : 195,832

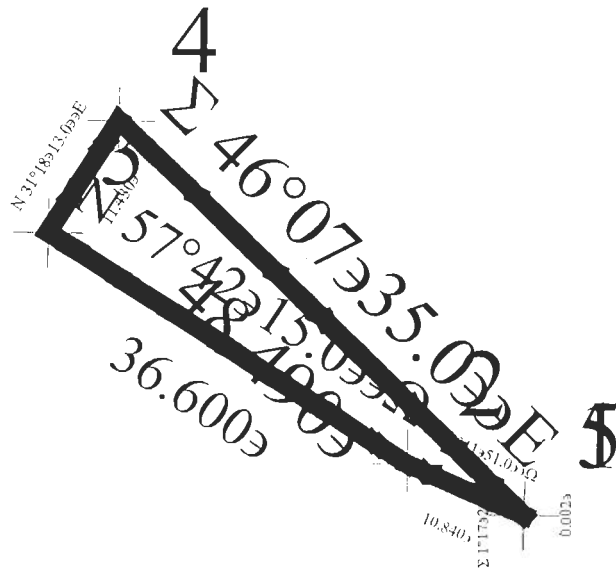

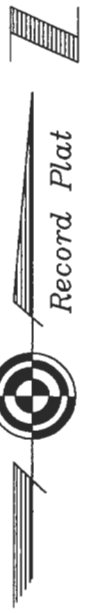

- △ = Railroad Spike Found
- ▲ = Railroad Spike Set
- ⊙ = Iron Pin Found
- = Iron Pin Set
- = Stone Found
- ⊗ = Monument Found

CURVE TABLE				
CURVE	DELTA	RADIUS	CHORD BEARING	CHORD LENGTH
C1	7°41'05"	621.54	S 39°39'34" W	83.36'

LINE TABLE		
LINE	LENGTH	BEARING
L1	10.84	N 66°41'51" W
L2	36.60	N 57°42'15" W
L3	11.43	N 31°18'13" E
L4	48.49	S 46°07'35" E

301 sq. ft.
0.007 acres

Plat of Survey of Lot 3599
Oakmont Subdivision Phase I
City of Athens, Athens County, Ohio
Surveyed August 20, 2001 for:
Larry L. Pratt

Charles T. Newman
Charles T. Newman
66 Elmwood Place
Athens, Ohio 45701

Description checked for
Mathematical Accuracy
ATHENS COUNTY
ENGINEER'S OFFICE
BY: *S. H. Hulse*
DATE: *9-29-03*

