

**BRANNER SURVEYING
12500 N. PEACH RIDGE ROAD
ATHENS, OHIO 45701**

Situated in L. L. 99 and L.L. 128 of Section 27, T.9, R.14, Athens Township, Athens County, Ohio and being more particularly described as follows:

Commencing at the North-east corner of L.L. 99 thence, North 83 degrees 13 minutes 33 seconds West, 658.31 feet to a stone on the North-line of said Lease Lot; thence, South 04 degrees 45 minutes 24 seconds West, 73.34 feet to a point in Lavelle Road, said point being the point of beginning for the tract of land herein described:

Thence, along Grantor's East-line South 04 degrees 45 minutes 24 seconds West, 1205.17 feet to an iron pin set at Grantor's South-east corner;
Thence, along Grantor's South-line, North 83 degrees 18 minutes 10 seconds West, 456.96 feet to existing iron pin at the South-east corner of a 6.49 acre tract (234,768 O.R.);
Thence, with the line of said tract, North 09 degrees 40 minutes 59 Seconds East, 346.29 feet to an existing iron pin;
Thence, South 87 degrees 59 minutes 57 seconds West, 793.02 feet to an existing iron pin;
Thence, along the lines of a 1.884 acre tract; North 73 degrees 20 minutes 54 seconds East, 221.57 feet to an existing iron pin;
Thence, North 38 degrees 25 minutes 19 seconds West, 275.96 feet to a point in Lavelle Road, passing an existing iron pin at 260.49 feet;
Thence, with said road, North 42 degrees 19 minutes 42 seconds East, 90.00 feet to a point at the south-west corner of a 0.982 acre tract;
Thence, leaving said road and along the lines of the aforementioned tract, South 43 degrees 15 minutes 09 seconds East, 28.12 feet to an existing iron pin;
Thence, south 71 degrees 28 minutes 59 seconds East, 185.70 feet to an existing iron pin at the South-east corner of the aforementioned tract;
Thence, along the lines of a 0.359 acre tract, South 71 degrees 28 minutes 59 seconds East, 100.00 feet to an iron pin set;
Thence, North 23 degrees 58 minutes 40 seconds East, 142.67 feet to an iron pin set;
Thence, North 52 degrees 38 minutes 51 seconds West, 100.00 feet to an existing iron pin at the North-east corner of the aforementioned 0.982 acre tract;
Thence, along the North-line of said tract, North 52 degrees 38 minutes 51 seconds West, 209.92 feet to a point in Lavelle Road, passing an existing iron pin at 194.45 feet;
Thence, with Lavelle Road the following bearings and distances:
North 26 degrees 09 minutes 42 seconds East, 212.06 feet
North 36 degrees 32 minutes 29 seconds East, 87.96 feet
North 52 degrees 46 minutes 45 seconds East, 85.23 feet
North 62 degrees 27 minutes 12 seconds East, 103.43 feet
North 71 degrees 38 minutes 07 seconds East, 42.46 feet
North 85 degrees 11 minutes 22 seconds East, 152.86 feet
South 85 degrees 15 minutes 41 seconds East, 114.70 feet
South 78 degrees 45 minutes 35 seconds East, 87.77 feet
South 76 degrees 31 minutes 26 seconds East, 212.21 feet
South 80 degrees 34 minutes 12 seconds East, 182.53 feet to the point of beginning and containing 23.799 acres of which 1.96 acres are in Lease Lot 128 and 21.839 acres are in Lease Lot 99.

Subject to all easements and right of way of record.

The above description is based on a field survey completed March 2001 by John M. Branner P.S. 6805



Description checked for
Mathematical Accuracy
ATHENS COUNTY
ENGINEERS OFFICE
BY: S. Branner
DATE: 3-15-01

ATH # 27

Line	Bearing	Distance
21	N 42°19'42"E	90.00'
22	S 43°15'09"E	28.12'
23	S 71°28'59"E	185.70'
24	S 71°28'59"E	100.00'
25	N 23°58'40"E	142.67'
26	N 52°38'51"W	100.00'
27	N 52°38'51"W	209.92'
28	N 26°09'42"E	212.06'
29	N 36°32'29"E	87.96'
30	N 52°46'45"E	85.23'
31	N 62°27'12"E	103.43'
32	N 71°38'07"E	42.46'
33	N 85°11'22"E	152.86'
34	S 85°15'41"E	114.70'
35	S 78°45'35"E	87.77'
36	S 76°31'26"E	212.21'
37	S 80°34'12"E	182.53'
38	N 4°45'49"E	73.34'

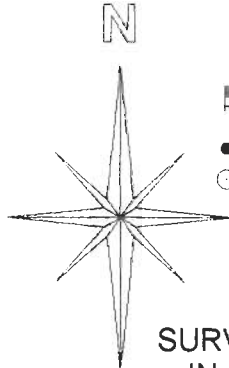

SCALE 1 INCH = 200 FEET
 ● = EXISTING IRON PIN
 ○ = IRON PIN SET

SURVEY OF A 23.799 ACRE TRACT
 IN L.L. 99 AND 128, SECTION 27
 T9. , R.14 , ATHENS TOWNSHIP
 ATHENS COUNTY, OHIO
 SURVEYED MARCH 2001

BY: John M. Branner
 JOHN M. BRANNER P.S. 6805
 12500 N. PEACH RIDGE ROAD
 ATHENS, OHIO 45701
 (740) 592-5778



Description checked for
 Mathematical Accuracy
 ATHENS COUNTY
 ENGINEER'S OFFICE
 BY: S. Blawie
 DATE: 3-15-01