

Phone 740-753-1264
Fax 740-753-1264

Description of a 1.503 Acre Tract

Situated in Lease Lot 150, Section 30, T-9, R-14, Athens Township, Athens County, and State of Ohio and being a part of a tract as described in Volume 278, Page 717 of the Official Records of Athens County and being more particularly described as follows:

BEGINNING at an iron pin set on grantors east line that bears North 82°42'31"West, 248.88 feet and South 5°32'00"West, 256.73 feet from the northeast corner of Lease Lot 150,

THENCE along grantors east line South 5°32'00"West, 400.00 feet to a point in the center of TR-246, (passing an iron pin found at 380.00 feet),

THENCE along said road South 88°16'00"West, 165.00 feet to a point,

THENCE leaving said road and along a new line North 5°32'00"East, 400.00 feet to an iron pin set, (passing an iron pin set at 20.00 feet),

THENCE along another new line North 88°16'00"East, 165.00 feet to the point of beginning and containing 1.503 acres.

Bearings are to an assumed meridian and are for angular determination only

Subject to all Easements and Rights of Way of record

Kenneth E. Highland
Kenneth E. Highland S-7581
KENNETH E. HIGHLAND S-7581
REGISTERED PROFESSIONAL LAND SURVEYOR

Description checked for
Mathematical Accuracy
ATHENS COUNTY
ENGINEERS OFFICE
BY: *S. Blause*
DATE: *9-6-02*

Chapman
323-151

Tritipo
278-717 OR

5.000 Ac.
-1.503 Ac.
3.497 Ac. Remainder

N 82°42'30"W
248.88'

N.E. corner of
L.L. 150

S 5°32'00"W
256.73'

N 88°16'00"E
165.00'

1.503
Acres

N 5°32'00"E
400.00'

S 5°32'00"W
400.00'

House

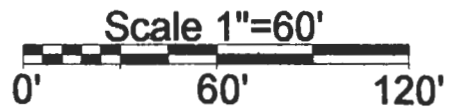

○ = Iron Pin Set

● = Iron Pin Found

Description checked for
Mathematical Accuracy
ATHENS COUNTY
ENGINEER'S OFFICE

BY: *S. Blawie*
DATE: *9-6-02*

45.00'

+20.00'

+380.00'

S 88°16'00"W
165.00'

TR-246

PLAT OF SURVEY OF A 1.503 AC. TRACT

SURVEYED FOR KELLY TRITIPO

SUBDIVISION L.L. 150

TOWNSHIP ATHENS SECTION 30 TOWN 9 RANGE 14

CORPORATION — COUNTY ATHENS STATE OHIO

SCALE 1"= 60' DATE JUNE 2002

Kenneth E. Highland
80 Fayette St.
Nelsonville, Ohio 45764
740-753-1264

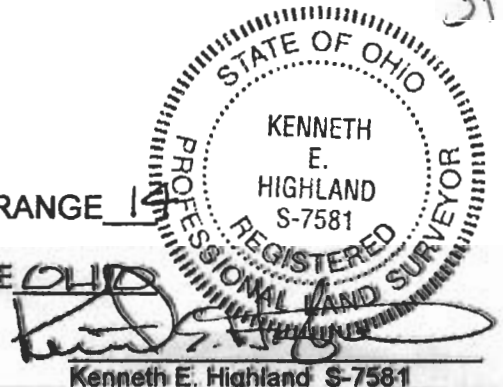

31

ATHENS 30

Kenneth E. Highland S-7581

SCALE 1 : 568.408

