

MARY T. REED
290-529 O.R.

S 85°00'00"E
88.25'

0.287 Acres

(New Survey of Existing
Lot of Record - 422-1181 O.R.)

RING STREET

83'
+ S 5°00'00"W 100.00'

12' ALLEY
N 41°15'30"E
124.01'

0.226 Ac
0.061 Ac

INLOT 1703
INLOT 1704

P.O.B.

N 85°00'00"W
63.39'

161.60'
98.21'

Description Checked for
Mathematical Accuracy
Athens County
ENGINEER'S OFFICE

BY: *S. Blause*
DATE: *8-15-08*

N 41°15'30"E
133.94'

S.W. COR
OF INLOT 1705
CALC.

MORRIS
99-803

MARINELLI
310-283



SURVEY OF A 0.287 ACRE TRACT
BEING PARTS OF INLOTS 1703 AND 1704
OF W.R. PHILLIPS 2ND ADDITION TO
THE CITY OF ATHENS, ATHENS TWP.
ATHENS CO., OHIO
SURVEYED AUGUST 2008

John M. Branner
John M. Branner P.S. 6805
12500 N. Peach Ridge Road
Athens, Ohio 45701
740-592-5778

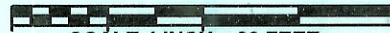
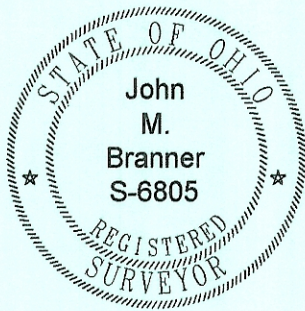

SCALE 1 INCH = 30 FEET
○ = IRON PIN FOUND
● = IRON PIN SET

Reference Documents
Prior Surveys
Tax -Plat
Deeds
ASSUMED BEARING TO
BE USED FOR INTERIOR ANGLES ONLY