

Drawn:	SURVEYED FOR: MR. HARRY F. EGAN	SCALE: 1" = 50'
	<h1>PLAT OF SURVEY</h1> <p>BEING ALL OF LOTS Nos. 113 + 114 AND PART OF TRACT No. 11 OF THE D. E. ALLEN BUNGALOW ADDITION TO ATHENS (ALLEN 1912), P.B. 6, Pg. 142, FL. 39 + 40, CITY OF ATHENS, ATHENS CO., OHIO.</p>	
	By: GERALD W. BAYHA, P.S. Route No. 2, Box No. 43-C Athens, Ohio - 45701 614-858-4303 REGISTERED SURVEYOR 11/6/13	

(90)

ATH-CMY
 588(Y-22)

... and also ...
... and also ...
... and also ...

... and also ...
... and also ...
... and also ...

... and also ...
... and also ...
... and also ...

... and also ...
... and also ...
... and also ...

... and also ...
... and also ...
... and also ...

TRACT No. 6

J.T. & J.R. Goeman
314/313

*1-27
Mechanville*

CURTIS STREET (30' F.W.)



0.1472 Ac.

0.1472 Ac.

PARCEL I

PARCEL II

0.1500 Ac.

0.1386 Ac.

0.0736 Ac.

0.0651 Ac.

16,035.00 Sq. Ft. = 0.3681 ACRES

15,408.865 Sq. Ft. = 0.3537 Ac.

D.E. ALLEN'S
ATHENS
N. GILKEY ET AL
250/89

J.B. & J.A. TUCKER
267/389

LOT III

LOT II

LOT 113

LOT 114

TRACT No. 11

MULLIGAN ROAD

(Joy Bobo)

Den.: S

SURVEYED FOR: MR. HARRY F. FFAW

SCALE: 1" = 50'

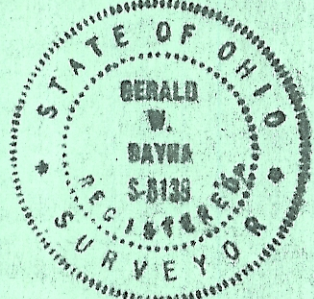

PLAT OF SURVEY

BEING ALL OF LOTS No's. 113 & 114 AND PART OF TRACT No. 11 OF THE D. E. ALLEN BUNGALOW ADDITION TO ATHENS (ALLENDALE), P.B.G., PG. 142, F.L. 39 & 40, CITY OF ATHENS, ATHENS CO., OHIO.

By: **GERALD W. BAYHA, P.S.**
Route No. 1, Box No. 43-C
Athens, Ohio - 45701
614-592-4308
REGISTERED SURVEYOR No. 6139

DATE: 9 SEPT 1974

Gerald W. Bayha

166 871-03