

PLAT of SURVEY

SITUATE IN LEASE LOTS 47 AND 30, ATHENS TOWNSHIP, TOWN 9, RANGE 14, ATHENS CO., OHIO. BEING A PART OF THE PANOPA LTD. PARCEL AS DESCRIBED IN O.R. VOL. 331 PG. 881, ATHENS COUNTY RECORDER'S OFFICE.

CONTAINING 0.617 ACRES (0.581 AC. IN LL 47 AND 0.036 AC IN LL30) AS SURVEYED FEB., 2003 UNDER THE DIRECTION OF ROBERT C. CANTER, P.S. 7226.

BASIS OF BEARINGS: NAD83(95) OHIO SOUTH ZONE STATE PLANE COORDINATES.

REFERENCE: BOUNDARY SURVEY OF 23.466 ACRE PARCEL BY KEN HIGHLAND, P.S. 7581 IN JUNE, 2002.

LAVELLE  
O.R. 191 PG. 143  
REFERENCE MORTGAGE SURVEY  
OF MAY, 2001  
BY KEN HIGHLAND, P.S. 7581.

Description checked for  
Mathematical Accuracy  
ATHENS COUNTY  
ENGINEER'S OFFICE  
BY: *S. Blause*  
DATE: *2-24-03*

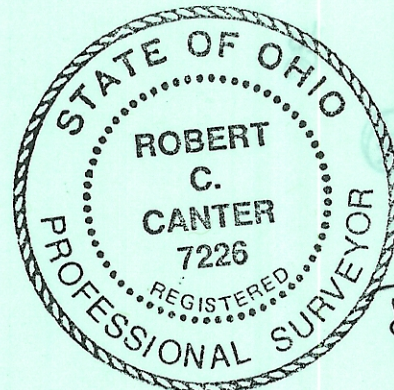

*Robert C. Canter*

P.O.B. BEING N04°24'57"W 1239.09'  
FROM A STONE FOUND  
AT THE SE CORNER OF LL47.

26,863 sq.ft.  
0.617 acres

LL 47  
25,292 sq.ft.  
0.581 acres

LL 30  
1,571 sq.ft.  
0.036 acres

CABLE LANE

LIMITED ACCESS R/W

P.O.B. FOR CL OF 50' WIDE EASEMENT FOR  
INGRESS AND EGRESS BEING N83°35'47"W  
392.03 FEET FROM THE WESTERLYMOST CORNER  
OF SUBJECT 0.617 ACRE PARCEL.

CL of 50' easement for  
ingress and egress

© IRON PIN W/CAP SET

PANOPA LTD.  
O.R. 331 PG. 881

IRON PINS SET ARE 5/8"x30" REBAR  
WITH PLASTIC CAP STAMPED "CANTER 7226".

SUBJECT TO ALL LEGAL EASEMENTS AND  
RIGHT OF WAYS.

DRAWN BY: KMC	DATE: 02/21/2003
RCC	DRAWING NO.: 23005PLAT
3005	SHEET 1 of 1

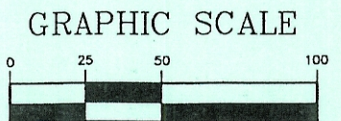

Not to Scale

50/82877X