

Description of 54.528 Acres

Description of a tract of land situate the Ohio Company Purchase Town 9, Range 14, Lease Lot 128, Lease Lot 129, Lease Lot 130, and Lease Lot 132, of Auditor's Section 27, Athens Township, Athens County, Ohio. Being lands deeded to Terrill Eiler and Lyntha Eiler Official Record Book 526, pages 1390-1394, and being more fully described as follows:

Beginning at an iron pin found at the northeast corner of Lease Lot 129 (Pruden's 154) of said Town 9, Range 14;

- 1.) Thence S02°19'24"W 794.88 feet along the east line of Lease Lot 129, being a common boundary to Eiler 526-1690, Embrey 501-1409, and Stoll 314-2482 to an iron pin found;
- 2.) Thence N 42°44'41"W 384.07 feet along a common boundary to Eiler 526-1390 and Eiler 557-182 to an iron pin found and continuing along said common boundary the following (9) courses;
- 3.) Thence N48°37'49"W 344.32 feet to an iron pin set;
- 4.) Thence N87°13'14"W 165.43 feet to an iron pin set;
- 5.) Thence S06°14'39"W 432.84 feet to an iron pin found;
- 6.) Thence S24°51'53"E 118.30 feet to an iron pin found;
- 7.) Thence S57°50'17"E 204.29 feet to an iron pin found;
- 8.) Thence S82°14'48"E 273.42 feet to an iron pin found;
- 9.) Thence S59°43'20"E 169.68 feet to an iron pin found;
- 10.) Thence S47°11'44"E 285.42 feet to an iron pin found;
- 11.) Thence S38°46'30"E 212.89 feet to a point in the center of Township Road 241, (Lavelle Rd.), passing an iron pin set at 182.89 feet;
- 12.) Thence S57°00'44"W 50.14 to a point in the center of Township Road 241;
- 13.) Thence N38°46'30"W 203.49 feet to an iron pin set, passing an iron pin set at 30.00 feet along a common boundary to Eiler 526-1690 between a 7.946 acre tract and a 54.528 acre tract and continuing along said common boundary the following (4) courses;
- 14.) Thence N47°11'44"W 276.31 feet to an iron pin found;
- 15.) Thence N59°43'20"W 154.27 feet to an iron pin found;
- 16.) Thence N82°14'48"W 294.62 feet to an iron pin found;
- 17.) Thence S39°40'49"W 86.56 feet to an iron pin found;
- 18.) Thence N77°25'42"W 211.28 feet along a common boundary to Eiler 526-1690 and Scott 526-1384 to an iron pin set and continuing along said common boundary the following course;
- 19.) Thence N38°09'17"W 2284.37 feet to an iron pin found, passing iron pins set at 358.35 feet, 803.15 feet, 943.17 feet, 1196.94 feet, 1644.10 feet, and 1965.54 feet;
- 20.) Thence S85°10'22"E 1188.14 feet along a common boundary to Eiler 526-1390 and Ohio Franklin 503-2282 to an iron pin found, passing iron pins set at 314.36 feet, and 748.25 feet and continuing along said common boundary the following course;
- 21.) Thence N04°36'48"E 112.08 feet to an iron pin found;
- 22.) Thence S85°11'31"E 1091.26 feet to an iron pin found, passing iron pins set at 250.09 feet, 642.76 feet, and 824.19 feet;
- 23.) Thence S02°19'24"W 727.88 feet to an iron pin found, passing iron pins set at 100.70 feet, and 387.72 feet to the point of beginning containing a total of 54.528 acres.

A010010046800 Lease Lot 128 being 0.432 acres

A040040008600 Lease Lot 129 being 22.924 acres, Lease Lot 130 being 12.729 acres

A010010047400 Lease Lot 132 being 18.443 acres

A040040009006 take of 1.09 acres

Plat of Survey is attached herewith and made a part thereof.

Subject to all easements, rights-of-way, covenants and agreements of record.

Iron pins set are 30 inch length number 5 rebar capped "NEWMAN PS-8043"

Basis of bearings Ohio State Plane, South Zone, NAD 83 (2011)

The above boundary description was based on an actual field survey and completed by Charles T. Newman Professional Surveyor Registered PS-8043 on October 3, 2019.

  
Charles T. Newman  
Professional Surveyor  
66 Elmwood Place  
Athens, Ohio 45701

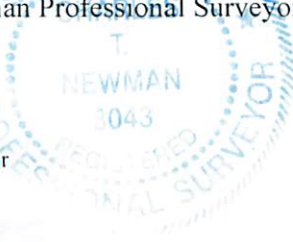

Legal Description Pre-Approval  
APPROVED  
All transfers are subject to  
Athens County Conveyance Standards

OCT 08 2019

Jill Thompson  
Athens County Auditor

C. TIM NEWMAN

Professional Surveyor

66 Elmwood Place  
Athens, Ohio 45701

740-594-1884  
FAX 740-594-9413

Plat of Survey of 54.528 Acres and 7.946 Acres.  
Situating Ohio Company Purchase Town 9, Range 14,  
Lease Lots 125, 128, 129, 130, and 132, of Auditor's Section 27,  
Athens Township, Athens County Ohio.  
Deeded to Lyntha Scott Eiler and Terrill E. Scott,  
Official Record Book 526, pages 1390-1394.  
Official Record Book 526, pages 1690-1694.

Basis of Bearings  
Denoted East Boundary L.L. 129  
Ohio State Plane NAD 83

*Charles T. Newman*  
Charles T. Newman  
Surveyed 2019

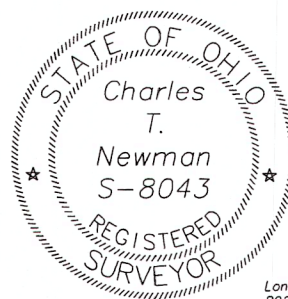

LINE TABLE		
LINE	BEARING	LENGTH
L1	S02°19'24"W	794.88
L2	N42°44'41"W	384.07
L3	N48°37'49"W	344.32
L4	N87°13'14"W	165.43
L5	S06°14'39"W	432.84
L6	S24°51'53"E	118.30
L7	N57°50'17"W	204.29
L8	S82°14'48"E	273.42
L9	S59°43'20"E	169.68
L10	S47°11'44"E	285.42
L11	S38°46'30"E	212.89
L12	S57°00'44"W	50.14
L13	N38°46'30"W	203.49
L14	N47°11'44"W	276.31
L15	N59°43'20"W	154.27
L16	N82°14'48"W	294.62
L17	S39°40'49"W	86.56
L18	N77°25'42"W	211.28
L19	N38°09'17"W	2284.37
L20	S85°10'22"E	1188.14
L21	N04°36'48"E	112.08
L22	S85°11'31"E	1091.26
L23	S02°19'24"W	727.88
L24	S60°38'54"W	159.29
L25	S66°34'37"W	141.19
L26	S71°15'39"W	105.92
L27	S76°13'09"W	94.96
L28	N27°04'44"W	89.93
L29	N37°47'16"W	120.27
L30	N13°28'13"W	51.37
L31	N50°27'35"W	65.91
L32	N13°52'16"W	65.15
L33	N00°52'17"E	51.66
L34	N14°53'07"E	58.62
L35	N33°37'29"W	107.42
L36	N06°50'16"W	116.66
L37	S60°38'54"W	113.66

Description Checked for  
Mathematical Accuracy  
Athens County  
ENGINEER'S OFFICE  
BY: *Bruce Williams*  
DATE: 10/7/19

- Iron Pin Found
- Iron Pin Set
- Stone Found
- ⊗ 30" Diameter Oak

GRAPHIC SCALE



( IN FEET )  
1 inch = 300 ft.

