

Description of a 2.316 Acre Tract

Situated in L.L. 12, Section 2, T.9, R.14, Athens Township, Athens County, Ohio and being the same tract as recorded as Parcel One in Volume 236, Page 587 of the Athens County Deed Records and being more particularly described as follows:

Beginning at the S.E. corner of L.L. 16 where an iron pin was found and reset
Thence, along the East - line of Casey (487-1678 O.R.)
N 3° 08' 36" E, 361.73 feet to an iron pin found;
Thence, along the west-line of Dicken (376-487 O.R.)
S 49° 11' 55" E, 483.61 feet to a mag- nail set in Longview Heights Road;
Thence, along said road:
S 61° 13' 46" W ,206.27 feet;
S 58° 43' 29" W, 120.07 feet;
S 54° 44' 26" W, 49.50 feet;
S 40° 32' 55" W, 50.85 feet;
Thence, leaving said road and along the east line of Casey (487-1678 O.R.)
N 8° 58' 37" W, 185.92 feet (passing an iron pin found at 34.27 feet) to the point of beginning
and containing 2.316 Acres.

Subject to all easements and rights of way of record

Bearings based on Grid North N.A.D. 83

The above description is based on a field survey completed August 2013 by

John M. Branner P.S. 6805

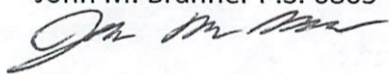

Description Checked for
Mathematical Accuracy
Athens County
ENGINEER'S OFFICE
BY: *John M. Branner*
DATE: 8/22/13



Legal Description Pre-Approval
APPROVED
All transfers are subject to
Athens County Conveyance Standards

APR 23 2018

Jill Thompson
Athens County Auditor

Description Checked for
 Mathematical Accuracy
 Athens County
ENGINEER'S OFFICE
 BY: Paula Mitchell
 DATE: 8/22/13



Dicken
 376-487

Casey
 487-1678 O.R.

Archie Greer
236-587 D.R.
Parcel One

2.316 Ac.

L.L. 16 P.O.B.
 L.L. 11 I.P. fd dislodged
 reset

Longview Heights Rd.
 S 61° 13' 46" W
 206.27'

Survey of a 2.316 acre tract
 in L.L. 12, Section 2, T.9, R.14
 Athens Township, Athens Co., O.
 Surveyed August 2013

John M. Branner
 John M. Branner P.S. 6805
 62 East First Street
 The Plains, Ohio 45780

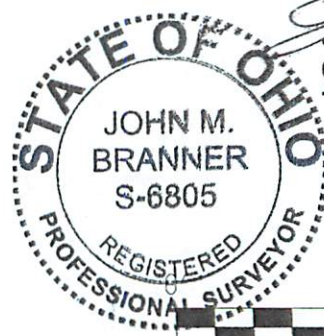

Scale 1 inch = 50 feet
 ○ = iron pin found
 ▽ = mag nail set
 Ref Bearings: N.A.D. 83 Grid North
 Ref. Docs.: Tax Plat- Deeds

