



Robert L. & Shirley A. Williams  
262-545  
16.0 Ac.

Television Cable Company Inc.  
273-466  
6.73 Ac.

Earl H. & Edith W. Stanley  
300-376  
40.42 Ac.

Anna E. & John L. Sheridan  
208-537,539  
80.41 Ac.

Donald E. & Marlene J. Schack  
282-223  
8.01 Ac.

Patricia B. Betz  
315-379  
6.00 Ac. 358-537

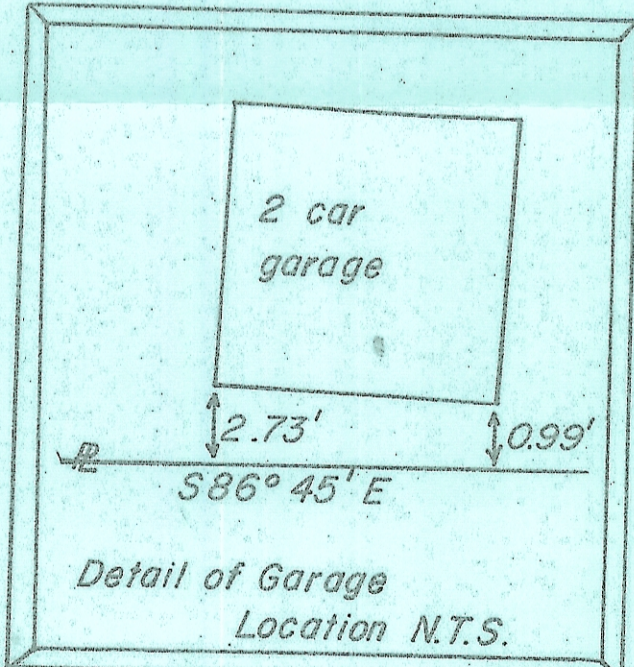

Scale 1" = 60'

- = stone found
- = iron pin found
- = iron pin set
- ▲ = railroad spike set
- = wooden stake set

Plat of Survey of 29805 Acres  
Located in Lease Lot 15, Sections 3 & 2, Town 9,  
Range 14, Athens Township, Athens County, Ohio.  
Divided into 6 Lots  
Lot 1 = 4.8068 Ac.  
Lot 2 = 5.0000 Ac.  
Lot 3 = 5.0000 Ac.  
Lot 4 = 5.0000 Ac.  
Lot 5 = 5.0000 Ac.  
Lot 6 = 5.0000 Ac.

Description checked for  
Mathematical Accuracy  
ATHENS COUNTY  
ENGINEERS OFFICE  
BY: *[Signature]*  
DATE: 5-7-84

Prepared by  
SOUTHEASTERN LAND SURVEYS  
For: Todd & Marty Romig, February 10, 1984

*Leonard F. Swayer II*  
Leonard F. Swayer II Registered Land Surveyor No. 6765