

10.84 ACRES

SURVEY OF A 10.84 ACRE TRACT
 IN F.L. 32, SECTION 7, T9, R14,
 ATHENS TWP, ATHENS CO, OHIO
 FOR LARRY CONRATH

SURVEYED AUGUST 1985

John M Branner
 JOHN M BRANNER
 REG LAND SURVEYOR 6805

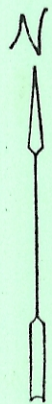
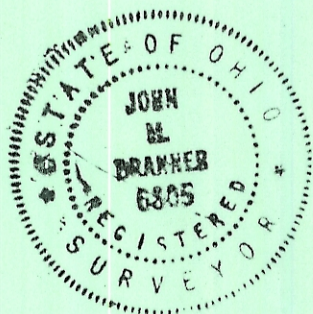

SCALE 1"=100'
 O=IRON PIN SET
 ●=IRON PIN FOUND

BRANNER SURVEYING
 RT 3 PEACH RIDGE RD
 ATHENS OHIO 45701
 614-592-5778

Handwritten notes:
 N
 25
 25