

ENVELOPE: 105B
BUCHTEL
SECTION 6 & 12
YORK TWP

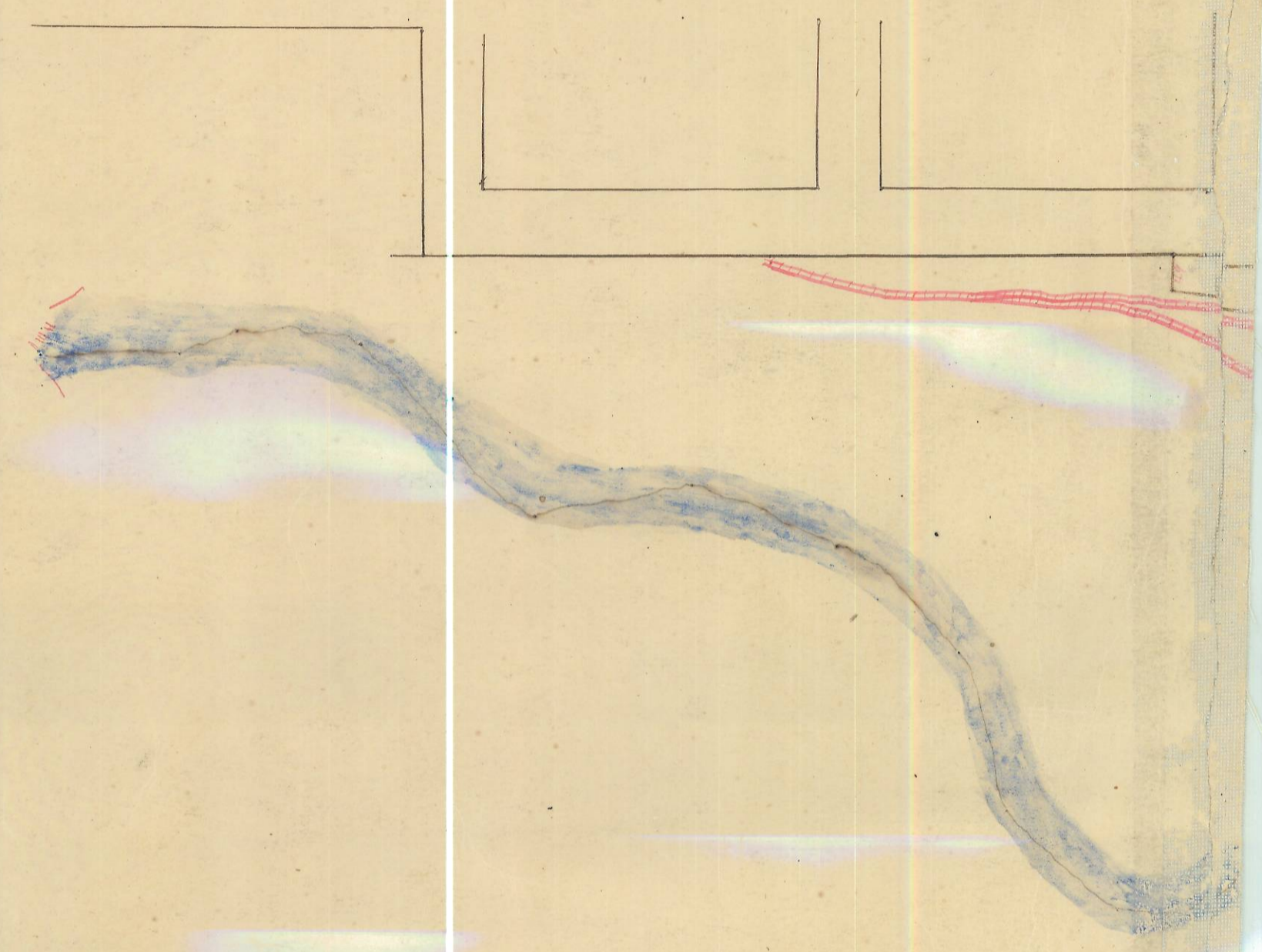

I hereby certify the above to be a correct plat of the Town of Buchtel, situate in Sections No. 6 & 12, Township No. 12, Range No. 15, Ohio Croupcays Purchase, Athens County, Ohio. Beginning at a point on the section line dividing said sections 6 & 12 and 41.34.63 chs. South of the North west corner of section six, thence East 7.10 chs. thence South 1.79 chs. thence S. 78 1/2 W. 1.415 chs. thence S. 72 W. 1.44 chs. thence S. 85 W. 1.42 chs. thence S. 87 1/4 W. 1.42 chs. thence N. 89 1/4 W. 1.42 chs. thence North 1.44 chs. to beginning, containing 1.58 acres, said tract contains five lots, as designated by the plat. Also the following described tract situate in Section No. 6, Beginning at a point from which the north west corner of said section bears west, 17.80 chs. and north 34.63 chs. thence S. 27 1/2 W. 13.68 chs. thence S. 62 1/2 E. 2.87 chs. thence S. 27 1/2 W. 1.84 chs. thence N. 80 1/2 E. 3.53 chs. thence N. 66 1/2 E. 3.47 chs. thence N. 62 1/2 W. 2.45 chs. thence N. 27 1/2 E. 10.64 chs. thence N. 62 1/2 W. 5.39 chs. to beginning, containing 8 1/2 acres, said tract contains thirty three lots, as described by the plat. Also the following described tract, situate in Sections Nos. 6 & 12, Beginning at a point on the section line dividing Sections No. 6 & 12, from which the north west corner of said section six bears north 37.07 chs. thence East 3.65 chs. thence N. 78 1/2 E. 2.32 chs. thence N. 78 1/4 E. 2.58 chs. thence N. 57 1/2 E. 7 1/2 chs. thence N. 72 E. 2.39 chs. thence N. 67 1/2 E. 2.6 chs. thence N. 57 1/2 E. 1.56 chs. thence N. 63 E. 4.15 chs. thence S. 28 W. 4.45 chs. thence S. 28 W. 6.20 chs. thence S. 32 W. 9.0 chs. thence S. 45 1/4 W. 2.84 chs. thence S. 36 W. 1.27 chs. thence S. 56 1/2 W. 2.74 chs. thence West 5.55 chs. thence south 7.6 chs. thence west 2.5 chs. thence S. 62 W. 2.49 chs. thence West 7.6 chs. thence N. 84 W. 2.28 chs. thence West .25 chs. thence N. 56 W. 3.65 chs. thence S. 33 1/2 W. 3.00 chs. thence N. 23 1/2 W. 7.43 chs. thence N. 87 1/2 W. 3.25 chs. thence S. 80 E. 6.64 chs. thence East 3.28 chs. thence S. 76 1/2 E. 2.34 chs. thence S. 45 E. 1.07 chs. thence East 1.90 chs. to beginning, containing 25 3/8 acres. The said tract contains one hundred and eight lots, as described by the plat. Also the following described tract situate in Section No. 12, Township and Range aforesaid, Beginning at a point from which the north east corner of said section bears 2.50 chs. and north 34.93 chs. thence West 14.12 chs. thence South .49 chs. thence S. 83 E. 14.31 chs. thence North 2.19 chs. to beginning, containing 1 1/2 acres, said tract contains nine lots, as designated by the plat. The whole of the described tracts contains 37 1/2 acres, said tracts contain 156 lots, numbering from 1 to 156. The length, breadth and quantities they contain are written on them respectively, and all other distances, widths and alleys are written in links on the plat and a stone planted at the north west corner of lot No. 103, in said Town of Buchtel, given under my hand this 18th day of June 1884.

John R. Buehler
Given my hand this 30 day of June 1884

James Davis S. H. C. O.
of said Town of Buchtel
John R. Buehler Justice