

CENTER-LINE SURVEY
OF EXISTING GIBSON AND
ELLIOTSVILLE ROAD IN
L.L. 95 AND L.L. 98
SECTION 21 T.9 R.14
ATHENS TOWNSHIP, ATHENS
COUNTY, OHIO .

FOR THE CITY OF ATHENS

SURVEYED JANUARY 1992

BRANNER SURVEYING
 12500 N. PEACH RIDGE RD.
 ATHENS, OHIO 592-5778

JOHN M. BRANNER P.S. 6805

460

Recorded Jan 21, 1993
 11:22 AM

See OR 137 Pg 208

ENU 446-B

VICINITY MAP

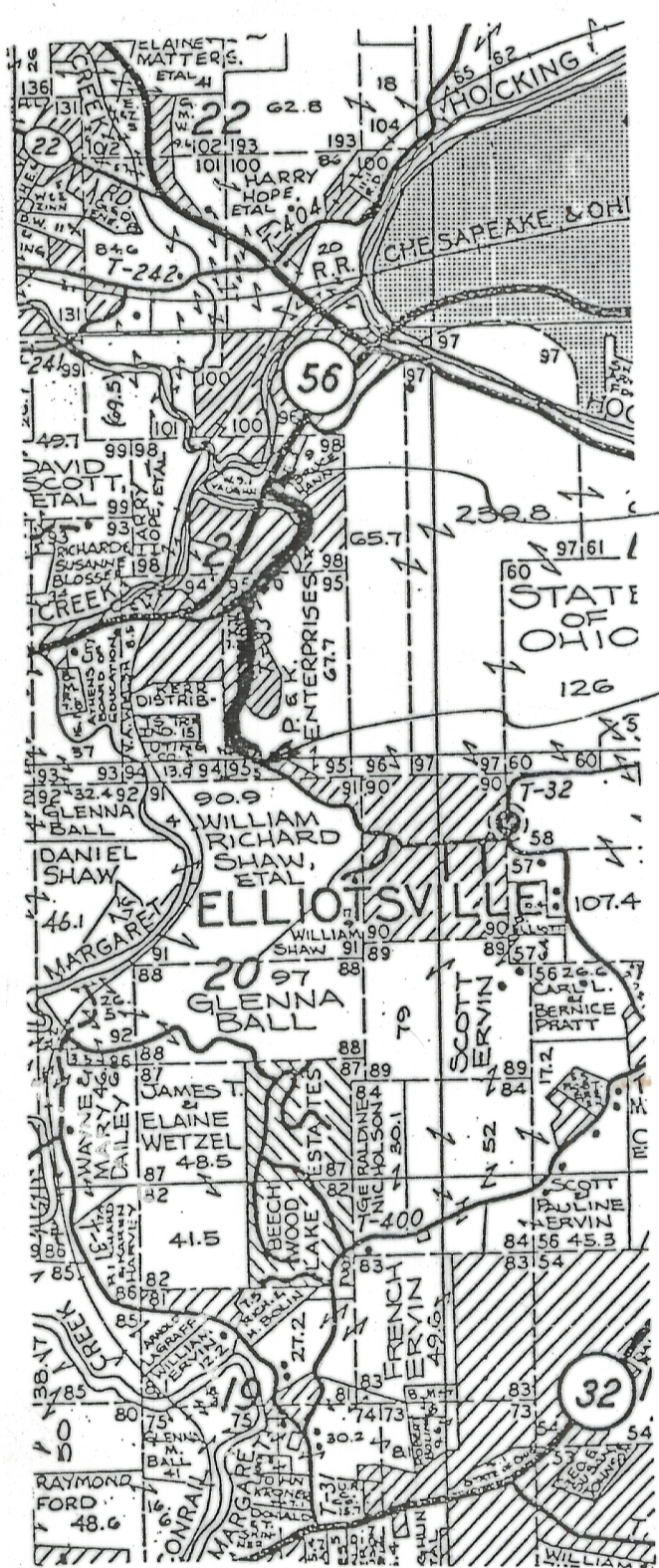

SCALE: 1 INCH = 100 FEET
 ○ = IRON PIN
 ○ = P.K. NAIL
 △ = RAILROAD SPIKE

CURVE	DELTA ANGLE	RADIUS	ARC	TANGENT	CHORD	CHORD BEARING
C 1	87°57'58"	179.75'	275.97'	173.48'	249.66'	S 05°39'57"W
C 2	26°32'00"	125.80'	58.26'	29.66'	57.74'	S 24°36'10"W
C 3	35°03'35"	141.64'	86.67'	44.74'	85.32'	S 25°44'47"W
C 4	33°49'11"	312.17'	184.26'	94.90'	181.60'	S 08°49'09"E
C 5	17°29'33"	262.18'	80.04'	40.34'	79.73'	S 34°30'42"E

LINE	BEARING	DISTANCE
L 1	S 32°00'15"E	74.77'
L 2	S 37°41'20"E	84.69'
L 3	S 40°41'42"E	67.98'
L 4	S 38°24'32"E	91.03'
L 5	S 39°18'58"E	30.67'
L 6	S 43°14'01"W	79.99'
L 7	S 13°45'04"W	73.35'
L 8	S 44°55'25"W	76.72'
L 9	S 51°39'43"W	95.71'
L 10	S 43°16'23"W	78.52'
L 11	S 08°12'58"W	59.95'
L 12	S 25°43'15"E	85.25'
L 13	S 43°13'02"E	86.74'
L 14	S 43°12'01"W	71.38'
L 15	S 88°58'18"E	54.92'
L 7-R	S 04°55'27"W	66.16'
L 7-B	S 17°27'42"W	63.74'
L 7-C	S 27°50'36"W	76.11'

ENVELOPE: 446B
 CENTERLINE SURVEY -
 ATHENS TWP
 P&K ENTERPRISES

