

# CENTER LINE SURVEY PLAT

## TOWNSHIP ROAD 278

### CITY OF NELSONVILLE, YORK TWP. ATHENS COUNTY, OHIO

### T12,R15, SECTIONS 17 & 23

### OHIO COMPANY PURCHASE

FHWA REGION	STATE	PROJECT
5	OHIO	

ATHENS COUNTY  
TOWNSHIP ROAD 278  
ISSUE 1 PROJECT

27

1  
7

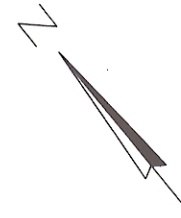

CURVE DATA  
P.I. 60+75.51  
Δ = 9° 51' 11" Lt.  
D = 3° 00' 00"  
R = 1909.86'  
L = 328.43'  
T = 164.62'  
E = 7.08'

CURVE DATA  
P.I. 41+89.38  
Δ = 38° 40' 36" Lt.  
D = 8° 00' 00"  
R = 716.20'  
L = 483.46'  
T = 251.35'  
E = 42.82'

CURVE DATA  
P.I. 50+84.40  
Δ = 11° 41' 42" Lt.  
D = 3° 00' 00"  
R = 1909.86'  
L = 389.83'  
T = 195.60'  
E = 9.99'

CURVE DATA  
P.I. 73+84.01  
Δ = 1° 28' 43" Lt.  
D = 0° 30' 00"  
R = 11459.15'  
L = 295.72'  
T = 147.87'  
E = 0.95'

CURVE DATA  
P.I. 66+93.89  
Δ = 43° 25' 52" Rt.  
D = 8° 00' 00"  
R = 716.20'  
L = 542.89'  
T = 285.24'  
E = 54.71'

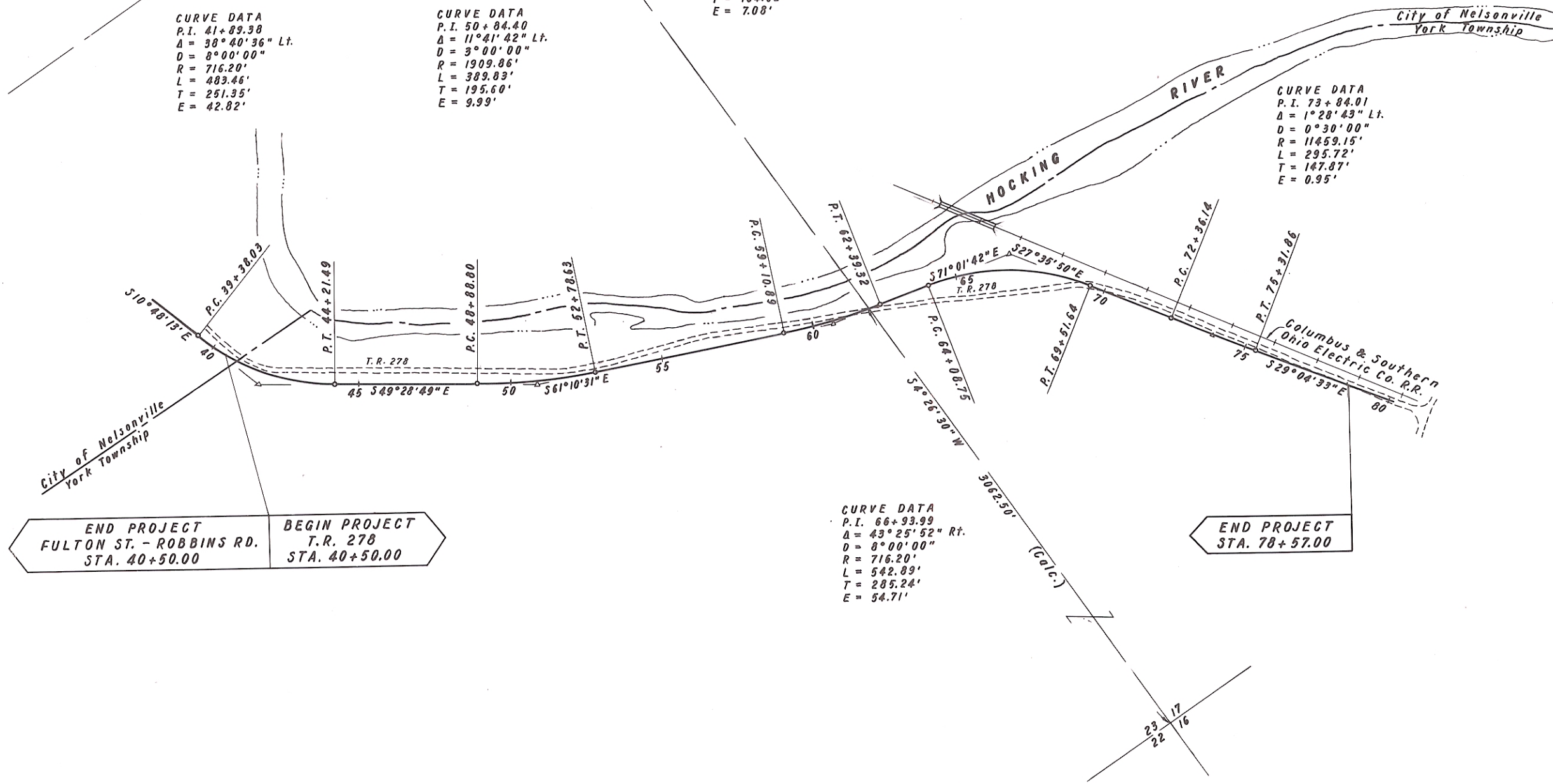

I HEREBY CERTIFY THAT THIS PLAT IS A TRUE DELINEATION OF A SURVEY MADE FOR THE BOARD OF COMMISSIONERS OF ATHENS COUNTY IN 1979 BY Columbus Engineering Consultants, Ltd. Donald W. Allen DATE 8-2-79 Registered Surveyor No. 6045

Approved John W. Allen  
Athens County Engineer  
Date 8-8-79

Approved Thomas A. Smith  
District 10 Deputy Director  
Date 8-8-79

#139271  
RECEIVED 8-16-79 AT 9:00 A.M.  
RECORDED 8-16-79  
PLAT BOOK 10 PAGES 45  
SIGNED William Allen ATHENS CO., OHIO  
Recorder NO REC

END PROJECT  
FULTON ST. - ROBBINS RD.  
STA. 40+50.00

BEGIN PROJECT  
T.R. 278  
STA. 40+50.00

END PROJECT  
STA. 78+57.00

COLUMBUS ENGINEERING CONSULTANTS, LTD.

⊕ SURVEY PLAT ⊕

ENVELOPE: 429B

CENTERLINE SURVEY -  
NELSONVILLE CITY  
TOWNSHIP ROAD 278