

107.00 ACRES

CALENTINE
305-675

HOUSKA
315-321
S 87°09'21"E
821.49'

STONE
N.E. COR
FR.#3

HOUSKA
263-109

+38.11
RAVINE

STONE

SEC. 9
SEC. 3

PHILLIPS

S.W. COR.
HENRY'S
CEMETERY

R/W
TWP RD 605

GRAHAM
263-109
5.03 AC.

7.221 AC.

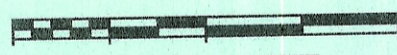

- SCALE 1 INCH = 400 FEET
- = IRON PIN SET
- = IRON PIN FD.
- ASSUMED BEARINGS TO BE USED TO DENOTE INTERIOR ANGLE ONLY

Description Checked for
Mathematical Accuracy
Athens County
ENGINEER'S OFFICE

BY: S. Blause
DATE: 3-1-04

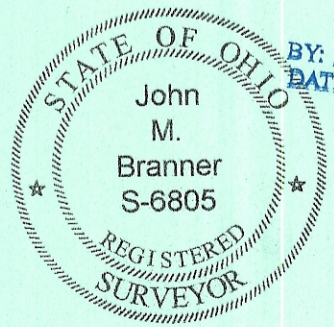

**SURVEY OF A 107.00 AC ACRE TRACT
IN FR. #3, SECTION 9 , T.5 , R.13 ,
CANNAN TOWNSHIP
ATHENS COUNTY, OHIO
SURVEYED FEB. 2004**

BY: [Signature]
**JOHN M. BRANNER P.S. 6805
12500 N. PEACH RIDGE ROAD
ATHENS, OHIO 45701
(740) 592-5778**