

DESCRIPTION OF A 3.47 ACRE TRACT

Situated in Section 1, T.5, R.12, Carthage Township, Athens County, Ohio and being a part of 20.14 acre tract as described in Volume 340, Page 703, Athens County Deed Records and being more particularly described as follows:

Commencing at the South-east corner of Section 1, thence, along the South-line of said section South 87 Degrees 05 Minutes 16 Seconds West, 3771.57 feet (deeds) to an iron Pin set at the South-west corner of Grantor's tract, said Pin being the Point of beginning for the tract of land herein described:

Thence, North 54 Degrees 06 Minutes 26 Seconds East, 735.00 feet to an iron Pin set; thence, South 21 Degrees 59 Minutes 54 Seconds East, 423.38 feet to an iron Pin set in the South-line of Section 1, thence, South 87 Degrees 05 Minutes 16 Seconds West, 755.00 feet to the Point of beginning and containing 3.47 acres.

Subject to all easements and rights of way of record.

John M. Branner R.L.S. 6805

*Transfer between adjacent owners
AUG 15 1986*

Reading checked for
Mathematical Accuracy
ATHENS COUNTY
ENGINEERING OFFICE
BY: Arli Stutz
DATE: 6-18-86

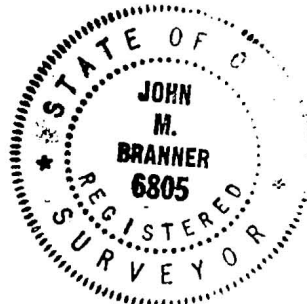

VANNIETER

FENCE COR.

DOMIGAN

N 86° 25' E 516.94'

+490.31'

S 61° 15' 38" E 372.80'

+26.67'

S 31° 41' 34" W 250.21'

2.38 AC.

N 49° 37' 38" W 121.67'

S 66° 55' 47" E 111.24'

11.24'

214.34'

1.79 AC.

S 58° 38' 57" W

N 53° 40' 40" W 11.30'

N 43° 47' 30" W 120.83'

CHARLES DAVID BARTON
349/331
18.28 AC.

COUNTY ROAD 65

22.11 AC.

N 02° 33' 25" W 1444.65'

S 4° 01' 13" W 651.04'

N 54° 06' 26" E 867.86'

S 54° 06' 26" W 735.00'

3.47 AC.

S 21° 53' 54" E 423.38'

S 87° 05' 16" W 755.00'

35

LINDA SUE BARTON RITCHIE
340/703

SEC. 1 ATHENS COUNTY
MORGAN COUNTY
1951.44 (DEED & SURVEY)

CA 651 30.00'
SEC. COR. SEC. 1
170.12' (DEED)
1650' (DEED)

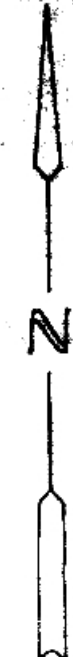

SCALE 1"=100'
● IRON PIN FOUND
○ IRON PIN SET
▲ RRS. FOUND
SOUTH-LINE SEC. 1
USED AS BASIS OF BRGS

PLAT OF SURVEY
OF FOUR TRACTS IN
SECTION 1 T5 R.12
CARTHAGE TWP. ATHENS
COUNTY OHIO
SURVEYED JUNE 86
John M. Branner
JOHN M BRANNER
REGISTERED LAND SURVEYOR 6805
RT 3, ATHENS, O. - 592-5778



36