

Phone 740-753-1264
Fax 740-753-1264

Description of a 20.046 Acre Tract

Situated in Section 19, T-5, R-12, Carthage Township, Athens County, State of Ohio and being a part of a tract as described in Volume 27, Page 244 of the Official Records of Athens County and being more particularly described as follows:

BEGINNING at a cut stone found at grantors northeast corner that bears North 7°38'54"West, 4253.05 feet (calculated) from the southeast corner of Section 19,

THENCE along grantors east line South 13°46'44"East, 1322.38 feet to a point in the center of CR-53, (passing an iron pin set at 1297.38 feet),

THENCE along the center of said road the following six courses,
South 45°42'08"West, 184.92 feet to a point,
South 48°17'46"West, 116.22 feet to a point,
South 54°57'17"West, 98.40 feet to a point,
South 64°12'06"West, 124.40 feet to a point,
South 65°16'05"West, 114.28 feet to a point,
South 60°40'12"West, 30.00 feet to a point,

THENCE leaving said road and along a new line North 10°34'19"West, 1699.69 feet to an iron pin set on grantors north line, (passing iron pins set at 30.00 feet, 130.00 feet, 230.00 feet and at 1499.69 feet),

THENCE along said line South 89°15'57"East, 538.56 feet to the point of beginning and containing 20.046 acres.

Bearings are to an assumed meridian and are for angular determination only

Subject to all Easements and Rights of Way of record

Description checked for
Mathematical Accuracy
ATHENS COUNTY
ENGINEER'S OFFICE
BY: S. Blausen
DATE: 12-8-00

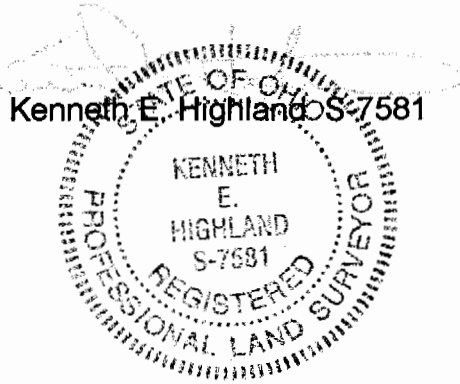

000001

