

Description Checked for  
Mathematical Accuracy  
Athens County  
ENGINEER'S OFFICE  
BY: Brandon Williams  
DATE: 6/3/16

Exhibit A  
23.040 Acres

Description of a Tract of land situate Ohio Company Purchase, Town 5, Range 12, Fraction 30,  
(Section 21) Carthage Township, Athens County, Ohio.  
Being a part of the lands deeded to Mary L. Allen, and referenced in Official Record Book 517, pages  
2428-2434 (Tract 3).

Commencing at a point at the northeast corner of said Fraction 30;  
Thence S90°00'00"W 412.00 feet (deed) to an iron pin found at the point of beginning of the tract herein  
described;

- 1.) Thence S01°23'50"W 1309.51 feet along a common boundary to Allen 512/2428, and  
Buckley 472/546 to an iron pin found;
- 2.) Thence S43°08'06"W 127.38 feet along said common boundary to a mag-nail found in the center of  
County Road 53 (Lottridge Rd.);
- 3.) Thence N71°27'52"W 62.37 feet to a point in the center of County Road 53;
- 4.) Thence N53°36'13"W 68.36 feet to a point in the center of County Road 53;
- 5.) Thence N44°46'18"W 75.26 feet to a point in the center of County Road 53;
- 6.) Thence N37°05'36"W 93.22 feet to a point in the center of County Road 53;
- 7.) Thence N40°21'42"W 82.89 feet to a point in the center of County Road 53;
- 8.) Thence N50°18'41"W 64.07 feet to a point in the center of County Road 53;
- 9.) Thence N60°10'28"W 40.51 feet to a point in the center of County Road 53;
- 10.) Thence N70°07'57"W 80.31 feet to a point in the center of County Road 53;
- 11.) Thence N77°52'13"W 86.06 feet to a point in the center of County Road 53;
- 12.) Thence N79°29'50"W 105.19 feet to a point in the center of County Road 53;
- 13.) Thence N07°02'17"E 391.01 feet, (passing an iron pin set at 14.58 feet), and being over the lands of  
Allen 512/2428 to an iron pin set;
- 14.) Thence N40°20'50"W 835.90 feet, and continuing over the lands of Allen 517/2428 to an iron pin  
found;
- 15.) Thence N90°00'00"E 1236.91 feet along the north line of Fraction 30, and being a common  
boundary to Allen 512/2428, and Church 170/870, 85/149 to the point of beginning containing a total of  
23.040 acres.

Plat of said survey is attached herewithin and made a part thereof.  
Subject to all easements, rights-of-way, covenants, and agreements of record.  
Iron pins set are 30 inch length of number 5 rebar, and capped "NEWMAN PS-8043".  
Basis of bearings was of a prior survey, and being the north line of Fraction 30.

  
Charles T. Newman  
Registered Professional Surveyor S-8043  
66 Elmwood Place  
Athens, Ohio 45701  
Survey completed June 2, 2016

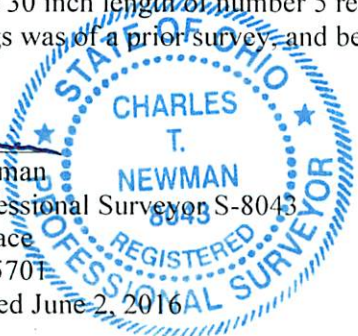

Legal Description Pre-Approval  
**APPROVED**  
All transfers are subject to  
Athens County Conveyance Standards

JUN 07 2016

Jill Thompson  
Athens County Auditor



C. TIM NEWMAN

Professional Surveyor

66 Elmwood Place  
Athens, Ohio 45701

740-594-1884  
740-594-9413  
FAX 740-594-9413

Plat of Survey of 23.040 acres  
Situating Ohio Company Purchase, Town 5, Range 12,  
Fractional Section 30, (Section 21),  
Carthage Township, Athens County, Ohio  
Being part of the lands of Mary L. Allen  
Official Record Book 517, pages 2428-2434, (Tract 3)

*Mark T. Newman*  
Charles T. Newman  
Surveyed June 2, 2016

Description Checked for  
Mathematical Accuracy  
Athens County  
ENGINEER'S OFFICE  
*Renault Williams*  
DATE: 6/3/16

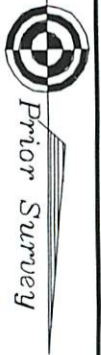

23.040 Acres

**APPROVED**  
Legal Description Pre-Approval  
All transfers are subject to  
Athens County Conveyance Standards  
JUN 07 2016  
Jill Thompson  
Athens County Auditor

Buckley  
472/546

Allen  
517/2428

Lottridge Rd

LINE	BEARING	LENGTH
L1	N71°27'52"W	62.37
L2	N53°36'13"W	68.36
L3	N44°46'18"W	75.26
L4	N37°05'36"W	93.22
L5	N40°21'42"W	82.89
L6	N50°18'41"W	64.07
L7	N60°10'28"W	40.51
L8	N70°07'57"W	80.31
L9	N77°52'13"W	86.06
L10	N79°29'50"W	105.19

GRAPHIC SCALE



( IN FEET )  
1 inch = 200 ft.

