

**MILLER**

**Legal Description**

**Tract 1**

**10.004 Acres**

Situated in the State of Ohio, County of Athens, Township of Carthage, Section 6, Township 5, Range 12, being further described as follows:

Beginning at a stone (found), said stone being the Northwest corner of said Section 6 by previous survey;

Thence, South 88 degrees 58 minutes 03 seconds East 1,227.87 feet to a point in County Road 65, passing a 5/8 inch rebar at 1,192.87 feet;

Thence, with said County Road 65, South 46 degrees 35 minutes 32 seconds West 288.51 feet to a 5/8 inch rebar (set);

Thence, continuing with said County Road 65, South 09 degrees 45 minutes 30 seconds West 209.14 feet to a 5/8 inch rebar (set);

Thence, North 88 degrees 58 minutes 03 seconds West 992.91 feet to a 5/8 inch rebar (set) in the West line of said Section 6;

Thence, along the West line of said Section 6, North 01 degrees 25 minutes 07 seconds East 408.73 feet to the point of beginning, containing 10.004 acres more or less and subject to all legal rights-of-way.

Bearings based on west line being North 01 degrees 25 minutes 07 seconds East by previous survey.

The prior deed being recorded in Deed Volume 268, Page 1546, of the Athens County Recorder's Office.

This description was prepared as the result of a survey performed under the supervision of Richard F. Mathias, Professional Surveyor No. 7798, in December, 1999.

A "Plat of Survey" was made in conjunction with and is considered an integral part of this description.

Description checked for  
Mathematical Accuracy  
ATHENS COUNTY  
ENGINEER'S OFFICE  
BY: S. Blause  
DATE: 12-21-01

RONALD D. DAVIS  
EE 235  
PG. 43

MARY FRANCES CRUM  
EE 236  
PG. 20

STONE FOUND (W/ CHISELED CROSS)  
AT THE NORTHWEST CORNER OF SECTION 6  
(BY PREVIOUS SURVEY OF 155.280 ACRES  
BY JOHN M. BRANNER IN MAY, 1998

SECTION 1, ROME TWP.

5/8" REBAR  
NO CAP

CO. RD. 65

P.O.B. TRACT 1

S 88°58'03" E 1227.87'

35.00'

SECTION 6, CARTHAGE TWP.

TRACT 1  
10.004 ACRES

288.51'  
S46°35'32"W

KATHLEEN KRUEGER BRAHMAN  
PAUL KRUEGER  
OR L 0288  
PG. 1328

SECTION 12

408.73'

SECTION 6

S 88°58'03" E 992.91'

CO. RD. 65

TRACT 2  
8.501 ACRES

BRIAN MILLER  
EE 268  
PG. 1546

N 01°25'07" E 1156.06'

326.70'

P.O.B. TRACTS 2 & 3

S 84°30'38" E 1093.41'

209.14'  
S09°45'30"W

156.13'  
S09°45'30"W

283.36'  
S83°38'38"E

106.13'  
S25°32'52"E

178.94'  
S01°13'40"E

TRACT 3  
9.000 ACRES

S 88°00'27" W 1146.04'

HELEN V. HART  
EE 98  
PG. 876

SECTION 12

S01°25'07" W 812.04'

SECTION 6

Description checked for  
Mathematical Accuracy  
ATHENS COUNTY  
ENGINEER'S OFFICE  
BY: S. Blause  
DATE: 12-21-01

BRIAN MILLER  
EE 268  
PG. 1546

STONE FOUND (W/ CHISELED CROSS)  
CALLED FOR IN PREVIOUS  
SURVEY OF 155.280 ACRES  
BY JOHN M. BRANNER IN MAY, 1998

IRON MONUMENT CALLED FOR IN  
PREVIOUS SURVEY OF 155.280 ACRES  
BY JOHN M. BRANNER IN MAY, 1998  
(DID NOT FIND)

S01°22'32" W 193.94'

BEARINGS BASED ON PREVIOUS SURVEY OF THE  
WEST LINE TO BE N 01° 25' 07" E, BY JOHN BRANNER  
SURVEY OF 155.280 ACRES IN MAY, 1998

THIS SURVEY PERFORMED UNDER THE SUPERVISION OF  
RICHARD F. MATHIAS, PROFESSIONAL SURVEYOR No. 7798  
IN DECEMBER, 1999

*Richard F. Mathias*  
RICHARD F. MATHIAS  
PROFESSIONAL SURVEYOR No. 7798

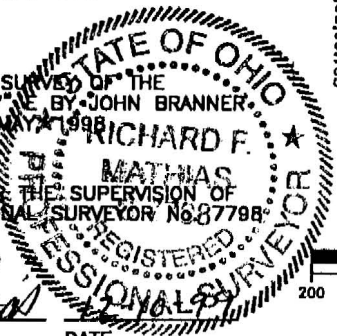

Horizontal Scale: 1 inch = 200 ft.  
Vertical Scale: 1 inch = N/A ft.

- 5/8" REBAR (SET)
- IRON MONUMENT (FOUND)
- ▲ RAILROAD SPIKE (SET)
- △ RAILROAD SPIKE (FOUND)
- CONCRETE MONUMENT (SET)
- ⊠ CONCRETE MONUMENT (FOUND)
- P.K. NAIL (SET)
- P.K. NAIL (FOUND)
- ⊕ BOLT (FOUND)
- ⊙ STONE (FOUND)
- × REFERENCE POINT

7

CAR 76

**PLAT OF SURVEY**  
**B. MILLER PROPERTY**  
SECTION 6, TWP. 5, RANGE 12  
CARTHAGE TOWNSHIP,  
ATHENS COUNTY, OHIO  
27.505 ACRES  
DECEMBER, 1999

**SURVEY PREPARED FOR:**  
  
BRIAN AND ANN MILLER  
6361 SOUTH BLACKBURN  
ATHENS, OHIO 45701  
740 593-7376

*Lockwood and Associates, Inc.*  
Civil Engineers - Land Surveyors  
1955 LANCASTER-NEWARK ROAD, NE  
LANCASTER, OHIO 43130  
(740) 687-5542 • Fax (740) 687-0086

Copyright © 1999, Lockwood and Associates, Inc.  
All rights reserved.

No. 1 OF 1

BRIANMILLER