

Exhibit A
0.103 ACRES

Description of a tract of land situate Ohio Company Purchase, Town 10, Range 14, Village of Chauncey, Ohio, and being more fully described as follows:
Being a part of the lands deeded to Candy M. Taylor
Official Record Book 446, pages 795-796;

Commencing at an iron pin found at the northeast corner of Lot 139 of Birge's Addition to the Village of Chauncey;

Thence S86°27'16"E 250.02 feet to an iron pin found at the northwest corner of Evener;

Thence S03°39'32"W 451.46 feet to an iron pin found at the northwest corner of Sorrell 328-105 and the southwest corner of Taylor 516-1870;

Thence S86°14'04"E 145.10 feet to an iron pin found on the west boundary of Taylor 446-795, and being the point of beginning of the tract herein described;

- 1.) Thence S86°14'04"E 90.00 feet over the lands of Taylor 446-795 to an iron pin found;
- 2.) Thence S03°39'32"W 50.00 feet along a common boundary to Taylor 446-795 and Shuler 459-2515 to an iron pin found;
- 3.) Thence N86° 14'04"W 90.00 feet along a common boundary to Taylor 446-795 and Sorrell 333-850 to a point;
- 4.) Thence N03°39'32"E 50.00 feet along a common boundary to Taylor 446-795 and Sorrell 328-105 to the point of beginning and containing a total of 0.103 acres.

Said 0.103 acres shall remain continuous and contiguous to the parcel to the west now deeded to Sorrell 328-105.

Plat of Survey is attached herewith and made a part thereof.

Subject to all easements, rights-of-way, and covenants and agreements of record.

All Iron Pins set are 30 inches in length #5 rebar capped" NEWMAN PS 8043"

Basis of bearings Ohio State Plane Coordinates, South.

Survey completed by Charles T. Newman, Licensed Professional Surveyor 8043 on June 19, 2020.

Charles T. Newman PS
66 Elmwood Place
Athens, Ohio 45701

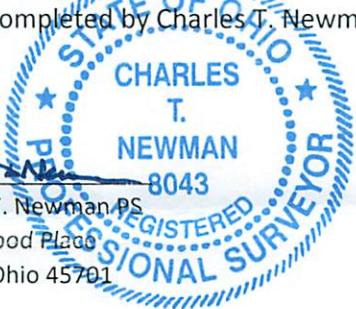

Description Checked for
Mathematical Accuracy
Athens County
ENGINEER'S OFFICE

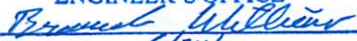
BY: 
DATE: 6/24/20

Legal Description Pre-Approval
APPROVED
All transfers are subject to
Athens County Conveyance Standards

JUN 25 2020

Jill Thompson
Athens County Auditor

C. TIM NEWMAN
Professional Surveyor

66 Elmwood Place
Athens, Ohio 45701

740-594-1884
740-591-5269

Plat of Survey of 0.083 Acres.
Situate Ohio Company Purchase, Town 10, Range 14,
Village of Chauncey, Ohio.
Being a part of the lands deeded to:
Candy M. Taylor
Official Record Book 446, pages 795-796,
Parent Parcel G020030008000

Charles T. Newman
Charles T. Newman
Surveyed 6/19/2020



N510431.708
E2074509.782

S 86°27'16" E
250.02'

NE Corner of Lot 139
Birge's Addition to the
Village of Chauncey

Description Checked for
Mathematical Accuracy
Athens County
ENGINEER'S OFFICE

BY: *Charles T. Newman*
DATE: *6/19/20*

N509965.68
E2074730.89

S 03°39'32" W
451.46'

Taylor C.
516-1870

Taylor C.
446-795

S 86°14'04" E
145.10'

Sorrell
328-105

0.103 ACRES

Shuler 459-2515

- ▲ = Iron Pin Found 5/8"
- ⊙ = Iron Pin Found PS 6765
- = Iron Pin Set PS 8043

LINE TABLE		
LINE	BEARING	LENGTH
L1	S86°14'04"E	90.00
L2	S03°39'32"W	50.00
L3	N86°14'04"W	90.00
L4	N03°39'32"E	50.00

Sorrell
335-487

Sorrell
333-850

May 371-979

Birge Drive 261-25

White Drive (unimproved)

Donald K. & Brenda S. Douglas
OR 60-588

0.207 Acres
497-40

Athens Friends Meeting Inc.
OR 161-239

Mason County E Corp
OR 295-913

GRAPHIC SCALE



(IN FEET)
1 inch = 50 ft.