

The tract from which the 3.75 acre tract is conveyed has been described as follows in a survey by John M. Branner, reg. surveyor #6805.

Situated in Section 13, T. 11, R. 14, Trimble Township and Section 18, T. 10, R. 14, Dover Township, Athens County, Ohio, and being part of the Greens Run Branch of the Kanawha and Michigan Railroad and being all of the Railroad Right of Way that is between the centerline of State Route 685 and the West-line of Section 18 of T. 10, R. 14, Dover Township and being more particularly described as follows:

Beginning at the intersection of the south right of way line of the railroad and the center-line of State Route 685, (said point also being the South-west corner of the right of way purchased by Clifford Martin from Penn Central Corp.), thence, along the south right of way line, South 80 degrees 02 minutes 22 seconds West, 1890.00 feet to a point; thence, along a curve to the right (L=508.51 feet; radius=1005.37 feet; L.C.=N 85 degrees 28 minutes 10 seconds West, 503.11 feet) to a point; thence, N 70 degrees 58 minutes 47 seconds West, 356.00 feet to a point; thence, along a curve to the left (L=242.16 feet; Radius=1880.08 feet; L.C.=North 74 degrees 40 minutes 19 seconds West, 242.00 feet) to a point; thence, North 78 degrees 21 minutes 36 seconds West, 704.70 feet to a point; thence, along a curve to the right (L=421.90 feet, Radius=1332.5 feet; L.C.=North 69 degrees 17 minutes 22 seconds West, 420.13 feet) to a point in the West-line of Section 18, of Dover Township; thence, along said Section Line, North 4 degrees 00 minutes East, 67.01 feet to the North-line of said railroad right of way; thence along the north-line of railroad right of way, along a curve to the left (L=432.05; Radius=1272.5 feet; L.C.=South 68 degrees 38 minutes 00 seconds East, 429.98 feet; to a point; thence, South 78 degrees 21 minutes 36 seconds East, 704.70 feet to a point; thence, along a curve to the right (L=249.89 feet; Radius=1940.08 feet; L.C.=South 74 degrees 40 minutes 19 seconds East, 249.71 feet) to a point; Thence, South 70 degrees 58 minutes 47 seconds East, 230.00 feet to a point; thence North 19 degrees 00 minutes 36 seconds East, 40.00 feet to a point; thence, South 70 degrees 58 minutes 36 seconds East, 126.00 feet to a point; thence, along a curve to the left (L=457.92 feet; Radius=905.36 feet; L.C.=South 85 degrees 28 minutes 13 seconds East, 453.06 feet) to a point; thence, North 80 degrees 02 minutes 22 seconds East, 2035.06 feet to the North-west corner of the Clifford Martin Tract; thence, along the West-line of said tract, South 45 degrees 27 minutes 35 seconds West, 176.19 feet to the point of beginning and containing 8.1 acres more or less of which 0.8 acres are in Section 13 of Trimble Township and 7.3 acres are in Section 18 of Dover Township.

Subject to all easements and rights of way of record.

This description was prepared from existing documents and was not based on a survey in the field.

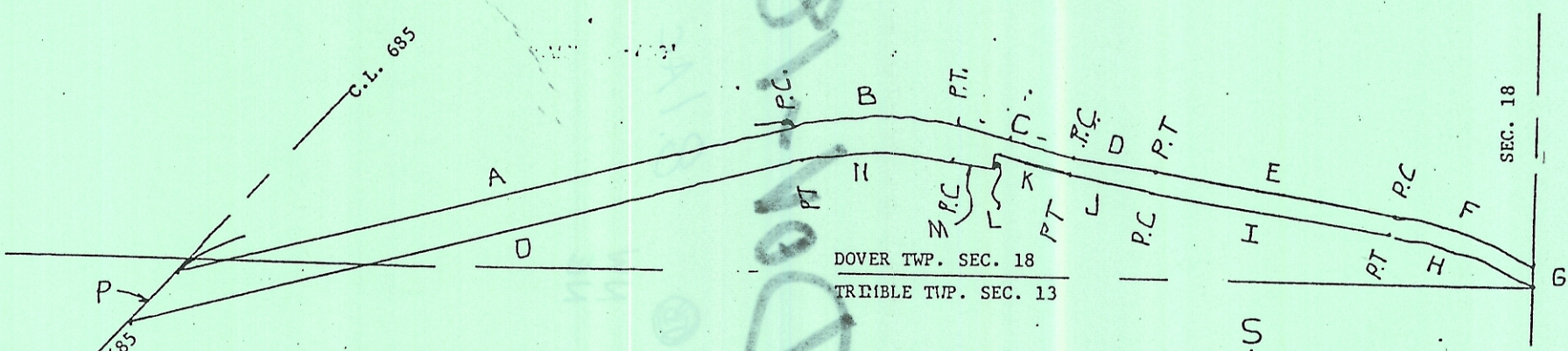

SURVEY DATA

- A-S 80°02'22"W, 1890.00'
- B-Curve to Right (L=508.51';Radius=1005.37';L.C.= N85°28'10"W,503.11')
- C-N 70°58'47"W,356.00'
- D-Curve to Left (L=242.16'; Radius=1880.08';L.C.=N 74°40'19"W,242.00')
- E-N 78°21'36"W, 704.70'
- F-Curve to Right (L=421.90'; Radius=1332.5'; L.C.=N 69°17'22"W, 420.13')
- G-N 04°00'E, 67.01'
- H-Curve to Left (L=432.05';Radius= 1272.5';L.C.=S 68°38'00"E,429.98')
- I-S 78°21'36"E, 704.70'
- J-Curve to Right (L=249.89'; Radius=1940.08';L.C.= S74°40'19"E,249.71')
- K-S 70°58'47"E, 230.00'
- L-N 19°00'36"E, 40.00'
- M-S 70°58'36"E, 126.00'
- N-Curve to Left (L=457.92';Radius= 905.36';L.C.= S 85°28'13"E, 453.06')
- O-N 80°02'22"E, 2035.06'
- P-S 45°27'35"W, 176.19'

ABOVE DATA BASED ON EXISTING DOCUMENTS AND NOT ON A FIELD SURVEY

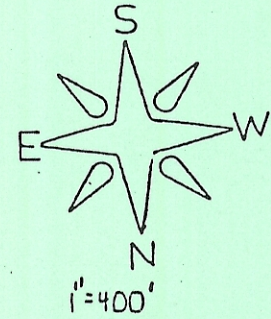

Description checked for
Mathematical Accuracy
ATHENS COUNTY

ENGINEER'S OFFICE
BY: *Arthur W. Stanley*
DATE: 2/20/85

SURVEY OF A 8.1 ACRE TRACT IN
SECTION 13,T.11, R. 14, TRIMBLE
TOWNSHIP, (0.8 ac.); and SECTION 18
T.10,R.14,DOVER TOWNSHIP (7.3ac.)
ATHENS COUNTY,OHIO.

FOR ANN STANLEY
FEB. 1985

John M. Branner
JOHN M. BRANNER
REGISTERED LAND SURVEYOR 6805

