

APPROVED THIS 18 DAY OF JAN
 COUNTY REGIONAL PLANNING COMM
 RIGHT-OF-WAY APPROVED FOR PUBLIC USE
 AND DEDICATION ON THE PART OF ANY OWNER
 APPROVED THIS 18 DAY OF JAN
 RECORDING DOES NOT CONSTITUTE
 ANY PUBLIC STREET ROAD, OR H
 SECTION 711.04, OHIO REVISED

James L. Hennings
James L. Hennings

COUNTY COMMISSIONERS

TRANSFERRED THIS July 8
 COUNTY AUDITOR

FILED FOR RECORD THIS July 9

RECORDED THIS 9 DAY OF JULY
Julia Michael Scott
 COUNTY RECORDER

NOTE: If public sewer and
 be signed by the County Bo

CONSTRUCTION OF ROAD
 SUBDIVISION REGULATIO

ANY SUBSEQUENT DIV
 RETROACTIVELY REQU
 ATHENS COUNTY SUBD

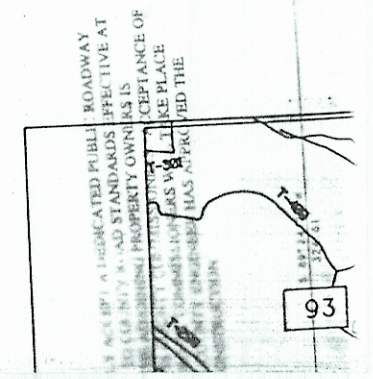

S 89° 24' 26" W
 324.61'

295.80'
 50' WIDE PUBLIC EASEMENT
 N 04° 46' 00" E
 391.79'
 EASEMENT FOR INGRESS AND EGRESS
 387.78'

301.32' S 04° 46' 00" W

30' BUILDING LINE

LOT 2
 2.33 ACRES

8706004757 Record in
 ATHENS COUNTY, OHIO
 JULIA MICHAEL SCOTT
 On: 07-09-1997 R# 0132 pr.
 PLAT #3.50
 ENU #76-B

SITUATED IN SECTION 30, AMES TOWNSHIP, T. 6. R. 13., ATHENS CO., OHIO,
 CONTAINING 2.33 ACRES AND BEING THE SAME THE TRACT AS CONVEYED
 TO, TRIVALE AND DESCRIBED IN THE DEED RECORDED IN DEED BOOK 2, PL 119
 ATHENS COUNTY, OHIO

THE UNDERSIGNED JAMES L. HENNINGE HEREBY CERTIFY THAT THE ATTACHED PLAT
 CORRECTLY REPRESENTS THEIR HENNINGE SUBDIVISION PHASE 2, A SUBDIVISION
 OF LOT 2 TO 2 INCLUSIVE, DO HEREBY ACCEPT THIS PLAT OF SAME AND
 DEDICATE TO PUBLIC (PRIVATE) USE AS SUCH ALL OR PARTS OF THE
 ROAD, BOULEVARDS, CUL-DE-SACS, PAVES, PLANTING STRIPS, ETC.
 SHOWN HEREON AND NOT HERETOFORE DEDICATED.

THE UNDERSIGNED FURTHER AGREES THAT ANY USE OF IMPROVEMENTS MADE
 ON THIS LAND SHALL BE IN CONFORMITY WITH ALL EXISTING VALID
 ZONING, PLATTING, HEALTH, OFF-STREET PARKING AND LOADING
 REQUIREMENTS OF THE APPLICABLE ATHENS COUNTY, OHIO FOR THE BENEFIT OF
 HIMSELF AND ALL OTHER SUBSEQUENT OWNERS OR ASSIGNS TAKING TITLE
 FROM UNDER OR THROUGH THE UNDERSIGNED.

300.00'
 DAY OF July, 1997

IN WITNESS WHEREOF

STATE OF OHIO

Before me a Notary Public in and for said County personally sees
 who acknowledged the signing of the
 foregoing instrument to be their voluntary act and deed for the
 purposes therein expressed.

In Witness whereof I have hereunto set my hand and affixed by
 official seal this Day of July, 1997

WE DO HEREBY CERTIFY THAT WE HAVE SURVEYED THE PREMISES AND
 PREPARED THE ATTACHED PLAT AND THAT SAID PLAT IS CORRECT

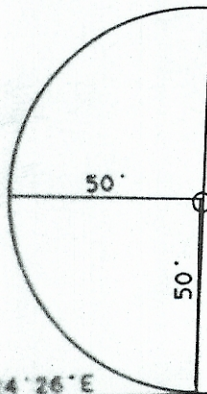

89° 24' 26" E
 150.00'

50.22'

S 89° 24' 26" W 351.79'

LOT 1 HENNINGE SUBDIVISION
 17.006 ACRES

HENNINGE
 CRES RESIDUAL
 VE OF RIGHT OF WAY

