

Scale : 1" = 200'

SUBJECT TO ALL LEGAL RIGHT-OF-WAYS, EASEMENTS, RESTRICTIONS, RESERVATIONS, AND ZONING REGULATIONS OF RECORD. SUBJECT TO 100 YEAR FLOOD PLAIN RESTRICTIONS, IF APPLICABLE. SUBJECT TO ANY FACTS THAT MAY BE DISCLOSED IN A FULL AND ACCURATE TITLE SEARCH.

SITUATED IN THE STATE OF OHIO, COUNTY OF ATHENS, PART BEING IN THE TOWNSHIP OF ROME IN THE SOUTHEAST QUARTER OF SECTION 31, RANGE 11 WEST, TOWNSHIP 6 NORTH, AND PART PART BEING IN THE TOWNSHIP OF TROY IN THE NORTHEAST CORNER OF THE NORTHEAST QUARTER OF SECTION 36, RANGE 11 WEST, TOWNSHIP 5 NORTH OF "OHIO COMPANY PURCHASE".

Survey Plat for DONALD J. BOYER KIKO AUCTIONS

THE BEARINGS ON THIS PLAT ARE FOR ANGLE CALCULATIONS ONLY AND ARE BASED ON THE EAST LINE THE SOUTHEAST QUARTER OF SECTION 31 USED AS A GRID BEARING OF SOUTH 02°16'56" WEST AS CALCULATED FROM A GPS OBSERVATION NAD 83 OHIO SOUTH ZONE.

CURVE	RADIUS	ARC LENGTH	CHORD LENGTH	CHORD BEARING	DELTA ANGLE
C1	4367.28'	29.73'	29.73'	N 48°45'50" W	0°23'24"
C2	4357.28'	74.74'	74.74'	N 49°36'32" W	0°58'58"

LINE	BEARING	DISTANCE
L1	S 39°53'59" W	10.00'
L2	N 24°03'21" E	247.48'
L3	N 00°33'21" E	166.98'
L4	N 46°41'39" W	92.40'
L5	N 39°20'34" W	111.85'
L6	N 87°43'51" W	20.95'
L7	N 13°05'09" W	51.85'
L8	S 87°43'51" E	84.68'
L9	S 39°58'04" W	258.94'
L10	S 55°14'48" E	342.49'
L11	S 07°11'04" W	216.23'
L12	S 28°35'41" E	204.18'
L13	S 87°48'41" E	172.69'
L14	N 73°03'12" E	399.07'
L15	S 02°00'34" W	345.44'
L16	N 88°40'49" W	15.67'

- = 5/8" x 30" I.P. Set "Biedenbach Surveying, LLC. PS 7881"
- ▲ = Railroad Spike Set
- ⊙ = 5/8" I.P.F. Capped "Finley 7222"
- ⊕ = 2" Pipe Found
- = 3/4" I.P.F. Uncapped
- ⊞ = Marked Stone Found
- ⊕ = Existing Tree
- ⊞ = 5/8" I.P.F. "Buckley Group 8676"
- ▲ = 5/8" I.P.F. "Claus 6456"
- ⊕ = Wooden Lath Set Online
- ⊞ = Post Found
- ⊞ = Railroad Spike Found
- ⊞ = Railroad Tie Found
- ⊕ = 1 1/2" PVC Found

Larry G. Klinglesmith
TRACT ONE
O.R.V. 415 PG. 701
4.530 ACRES

Bruce A. Johnson
O.R.V. 206 PG. 171
112.910 ACRES

DONALD J. BOYER
O.R.V. 261 PG. 703
60.340 AC. (Deed)

NEW SURVEY OF
O.R.V. 261 PG. 703
O.R.V. 16 PG. 854
83.656 ACRES TOTAL

The Athens County
Board of Commissioners
O.R.V. 548 PG. 2053
17.910 ACRES

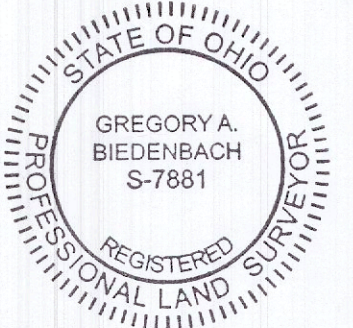

Description Checked for
Mathematical Accuracy
Athens County
ENGINEER'S OFFICE
BY: *Gregory A. Biedenbach*
DATE: 1/7/21

SURVEYORS CERTIFICATION:

I HEREBY CERTIFY THAT THIS PLAT IS TRUE AND CORRECT TO THE BEST OF MY KNOWLEDGE AND THAT IT WAS PREPARED FROM AN ACTUAL FIELD SURVEY OF THE PREMISES. TITLE IS NOT GUARANTEED BY THIS SURVEY.

Gregory A. Biedenbach Dec 22, 2020
DATE:

GREGORY A. BIEDENBACH
OHIO REG. SURVEYOR PS 7881
BIEDENBACH SURVEYING, LLC.
114 ADAMS AVENUE
WOODSFIELD, OHIO 43793
1.740.472.1262 OFFICE
1.740.472.5298 FAX

PERTINENT DOCUMENTS

- (1) ALL DEEDS AS SHOWN.
- (2) COUNTY TAX MAPS.
- (3) U.S.G.S. QUAD. MAP CUTLER.
- (4) SURVEY PLATS BY BUCKLEY GROUP.

NOTE: THIS MAP IS AN ORIGINAL COPY ONLY WITH ORIGINAL SIGNATURE AND SEAL.

SCOTT P. ADAMS
O.R.V. 405 PG. 1891
159.305 ACRES

Survey File No.: GB-3643F

