

Phone 740-753-1264  
Fax 740-753-1264

**Description of a 0.034 Acre Tract**

Situated in Section 15, T-10, R-15, Lee Township, Athens County, State of Ohio and being a part of a tract as described in Volume 181, Page 169 of the Deed records of Athens County, and being more particularly described as follows:

BEGINNING at an iron pin set on the north Right of Way line of CR-14 that bears North 29°02'48"West, 2704.10 feet (calculated from deed) from the southeast corner of Fraction 36,

THENCE along said Right of Way line South 86°13'03"West, 50.00 feet to an iron pin set,

THENCE leaving said line North 3°46'57"West, 30.00 feet to an iron pin set,

THENCE North 86°13'03"East, 50.00 feet to an iron pin set,

THENCE South 3°46'57"East, 30.00 feet to the point of beginning and containing 0.034 acres.

Bearings are to an assumed meridian and are for angular determination only

Subject to all Easements and Rights of Way of record

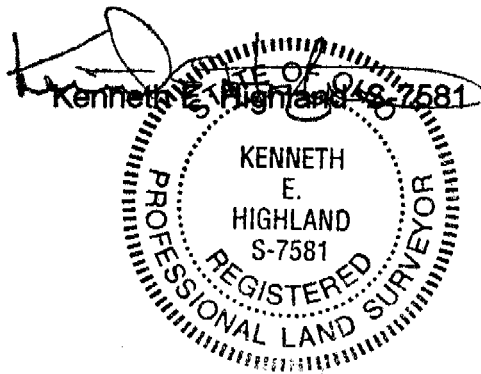

Description checked for  
Mathematical Accuracy  
ATHENS COUNTY  
ENGINEER'S OFFICE  
BY: S. Blausey  
DATE: 8-27-02



West  
181-169

Elevation-top of  
Iron Pin= 813.43

Elevation-top of  
Iron Pin= 811.20

N 86°13'03"E  
50.00'

0.034 Ac.

N 3°46'57"W  
30.00'

S 3°46'57"E  
30.00'

S 86°13'03"W  
50.00'

CR-14  
(40')

Bean  
294-337

N 29°02'48"W  
27.04 10'  
(calculated from deed)

o = Iron Pin Set

Scale 1"=30'

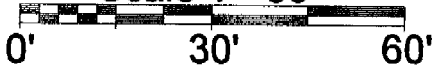

Description checked for  
Mathematical Accuracy  
ATHENS COUNTY  
ENGINEER'S OFFICE  
BY: S. Blause  
DATE: 8-27-02

S.E. corner of  
Fraction 36

PLAT OF SURVEY OF A 0.034 Ac. TRACT

SURVEYED FOR LE-AX

SUBDIVISION —

TOWNSHIP LEE SECTION 15 TOWN 10 RANGE

CORPORATION — COUNTY ATHENS STATE OHIO

SCALE 1"= 30' DATE AUG, 2002

Kenneth E. Highland  
80 Fayette St.  
Nelsonville, Ohio 45764  
740-753-1264

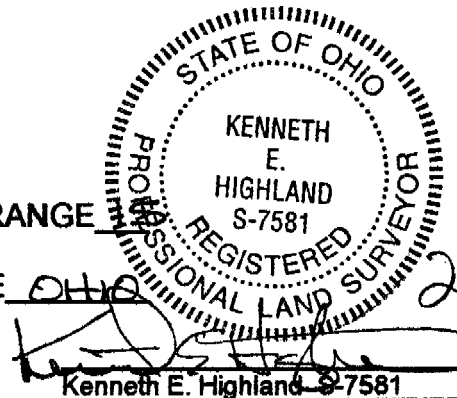

LEE 15  
S 7581