

Caster Giffin
Tract 4

Description of 7.077 acres

Situated in Section 15, Fraction 1, Town 10, Range 15, Lee Township, Athens County, Ohio and being more particularly described as follows;

Commencing at the northwest corner of Said Fraction 1; thence along the north line of the fraction S 86°23'15" E 413.35 feet to an iron pin set; thence continuing S 86°23'15" E 718.55 feet to an iron pin set in the center of County Road 10 (passing an iron pin set at 698.53 feet); thence along the center of Said Road S 5°55'12" W 300.00 feet to an iron pin set; thence continuing S 5°55'12" W 248.13 feet to an iron pin set; thence S 26°25'30" W 51.87 feet to an iron pin set; thence continuing S 26°25'30" W 300.00 feet to an iron pin set at the point of beginning of the tract herein described; thence continuing S 26°25'30" W 234.04 feet to an iron pin set; thence S 39°25'57" W 65.96 feet to an iron pin set; thence leaving the road N 86°23'15" W 1072.90 feet to an iron pin set (passing iron pins set at 24.67 feet and at 750.53 feet); thence N 3°09'56" E 269.23 feet to an iron pin set; thence S 86°23'15" E 1204.34 feet (passing iron pins set at 349.76 feet 461.91 feet and 1182.64 feet) to the point of beginning containing 7.077 acres.

Prior deed reference Volume 238, Page 503 Athens County Deed Records.

Gregory K. Wright

Gregory K. Wright
Registered Surveyor S-6535
17498 South Canaan Road
Athens, Ohio 45701

Description checked for
Mathematical Accuracy
ATHENS COUNTY
ENGINEER'S OFFICE
BY: *Susan O'Reil*
DATE: *2-8-73*

Lee #15

80

TO WHOM IT MAY CONCERN:

The following is a computer printout of the coordinates of the attached description. Copies of the plat, the description, and this sheet should be presented to the County Engineer for approval.

DEED COORDINATES AND AREA CALCULATION

Caster Giffin Tract 4

					NORTH	EAST	AREA DESCRIPTION	
N/S	DEG	'	"	E/W	DIST	1000.000	1000.000	
S	26	25	30	W	234.04	790.413	895.846	0.0000
S	39	25	57	W	65.96	739.467	853.950	0.0399
N	86	23	15	W	1072.90	807.069	-216.818	3.3553
N	3	9	56	E	269.23	1075.888	-201.951	7.0771
S	86	23	15	E	1204.34	1000.005	999.996	7.0771

Dwight K. West

Fr. 31 Fr. 36 Fr. 1

Lawrence W. & Marjorie J. Bean
294-337

William E. & Barbara J. Boggess
327-789

Caster D. & Mary V. Giffin
238-503

Tract 1
217,800 sq. ft.
5.000 acres

Tract 2
217,800 sq. ft.
5.000 acres

Tract 3
217,800 sq. ft.
5.000 acres

TRACT 4
308,275 sq. ft.
7.077 acres

Garry Linn & Jennifer Lynn
Ennis
349-107

Plat of Survey of 4 Tracts
Situating in Section 15, Fraction 1,
Town 10, Range 15, Lee Township,
Athens County, Ohio
Surveyed August 1992 for:

Caster Giffin

Gregory K. Wright
Gregory K. Wright
Registered Surveyor S-6535

Caster D. & Mary V. Giffin
238-503

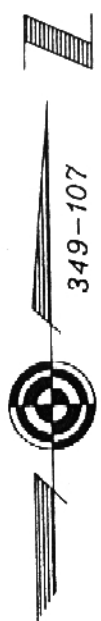

● = Iron Pin Set

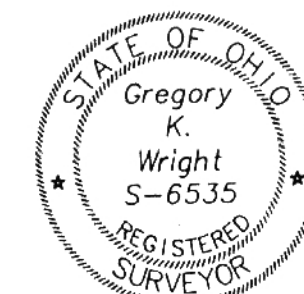

Gregory K. Wright
Professional Engineer
Professional Surveyor
17498 South Canaan Road
Athens, Ohio 45701
614-662-2130

GRAPHIC SCALE

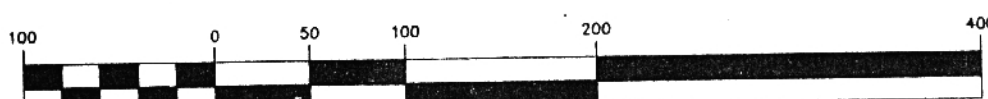

(IN FEET)
1 inch = 100 ft.

58

78

78