

Steven Kovach  
287-597 O.R.

Sec. 13 Waterloo Twp.  
Sec. 18 Lee Twp.

P.O.B.  
Fence Corner  
at N.W. Corner  
of N.E. 1/4 of  
Section 18

S 86° 21' 20" E  
905.64'

23' frontage in R/W

23' frontage in R/W

Sec. 13 Waterloo Twp.  
Sec. 18 Lee Twp.

+878.70'

Sheri L. Crabtree  
435-2636 O.R.

N 3° 42' 16" E  
801.87'

16.75 Acres

803.39'  
S 3° 15' 16" W

Brenda S. Gater  
382-468 O.R.

911.95'  
N 86° 15' 41" W

Brenda S. Gater  
382-468 O.R.

Description Checked for  
Mathematical Accuracy  
Athens County  
ENGINEER'S OFFICE

BY: *D. Stew*  
DATE: 1/17/14



Survey of a 16.75 Acre Tract  
in the N.E. Quarter of Sec. 18  
T.10 N. R.15 W. Lee Twp.  
Athens County, Ohio

*John M. Branner*  
Surveyed January 2014

John M. Branner P.S. 6805  
62 East First Street  
The Plains, Ohio 45780  
740-541-0350

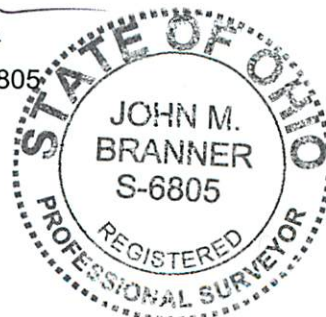

Scale 1 inch = 200 feet  
O = iron pin set 5/8" x 30" long rebar  
Ref. Bearings: N.A.D. 83 Grid North  
Ref. Doc.: Tax Plat-Deeds

### Description of a 16.75 Acre Tract

Situated in the North -East Quarter of Section 18, T.10, R.15 ,Lee Township, Athens County, Ohio and being a part of a tract of land as described in Volume 382, Page 468 of the Official Records of Athens County and being more particularly described as follows:

Beginning at a fence corner taken to be the North-west corner of the the North-East Quarter of Section 18,

Thence, along the North-line of Section 18:

**S 86° 21' 20" E, 905.64 feet** to a point in in the center-line of Tope Road, passing an iron pin set at 878.70 feet;

Thence, along new lines created by this survey:

**S 3° 15' 16" W, 803.39 feet** to an iron pin set;

**N 86° 15' 41" W, 911.95 feet** to an iron pin set in existing fence-line;

Thence, along the East line of Sheri Crabtree (435-2636 O.R.)

**N 3° 42' 16" E, 801.87 feet** to the point of beginning and **containing 16.75 acres**

Subject to all easements and rights of way of record.

Bearings are Grid North. N.A.D. 83.

Iron pins set are 5/8" by 30" long rebar with plastic I.D. Cap Stamped "Branner P.S. 6805"

The above description is based on a field survey completed January 2014 by John M. Branner P.S. 6805

Description Checked for  
Mathematical Accuracy  
Athens County  
ENGINEER'S OFFICE  
BY: *D. Stum*  
DATE: 1/17/14

