

JUN 16 2014

Jill Thompson  
Athens County Auditor

Description Checked for  
Mathematical Accuracy  
Athens County  
ENGINEER'S OFFICE

BY: *Branch Williams*  
DATE: 6/16/14

Exhibit A  
2.946 Acres

Description of a parcel of land situated in Town 10N, Range 15W, Section 24, Lee Township, Athens County, Ohio and being more fully described as follows:

Beginning at an iron pin set at the southwest corner of said Section 24;

- 1.) Thence N04°03'41"E 321.75 feet along the west line of Section 24 to an iron pin found;
- 2.) Thence S86°45'13"E 570.88 feet along a common line to Rosemary Swart 352-281 and Tracie Pittman 170-342 to a point in the center of Township Road 12, passing an iron pin set at 540.88 feet;
- 3.) Thence S41°30'27"W 98.37 feet to a point in said road;
- 4.) Thence S47°51'37"W 69.71 feet to a point in said road;
- 5.) Thence S52°18'29"W 72.68 feet to a point in said road;
- 6.) Thence S58°50'51"W 73.50 feet to a point in said road;
- 7.) Thence S63°39'47"W 113.77 feet to a point in said road;
- 8.) Thence S71°42'32"W 81.47 feet to a point in said road;
- 9.) Thence S77°41'11"W 73.19 feet to a point in said road;
- 10.) Thence N86°45'13"W 104.81 feet along the south line of Section 24 and being a common line to Rosemary Swart 352-281 and William Battrell 430-1052 to the place of beginning of the tract herein described containing 2.946 acres.

Deed Referenced: Rosemary Swart Book 352, Page 281

Referenced Tax Number: H010010036100

Iron pins set are 5/8" x 30" capped "NEWMAN 8043"

Survey subject to all easements, right-of-way and covenants and agreements of record

*Charles T. Newman*  
Charles T. Newman  
Professional Surveyor  
66 Elmwood Place  
Athens, Ohio 45701  
June 16, 2014

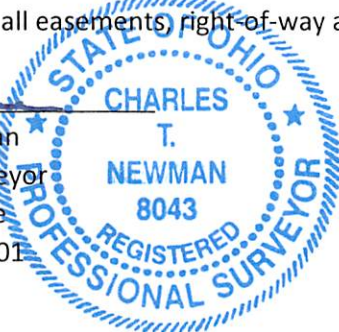

C. TIM NEWMAN

Professional Surveyor

66 Elmwood Place  
Athens, Ohio 45701

740-594-1884  
FAX 740-594-9413



Plat of Survey of 2.946 Acres  
Situated in Town 10, Range 15,  
Section 24, Lee Township, Athens County, Ohio

Description Checked for  
Mathematical Accuracy  
Athens County  
ENGINEER'S OFFICE

BY: *Forrest L. ...*  
DATE: 6/16/14

*Charles T. Newman*  
Charles T. Newman  
Surveyed June 2014

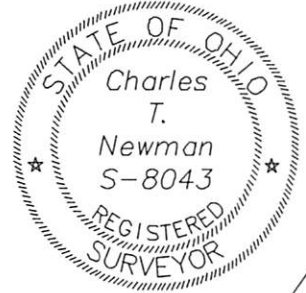

Pittman  
170-342

S86°45'13"E  
570.88' Total

(30.00')

Warner  
145-756

2.946 Acres

Battrell  
430-1052

Southwest  
Corner  
Section 24

N04°03'41"E  
321.75'

N86°45'13"W  
104.81'

Section 24  
Section 23

Lemay Rd.

Battrell  
430-1052

Section 29  
Section 23

LINE TABLE		
LINE	LENGTH	BEARING
L1	98.37	S41°30'27"W
L2	69.71	S47°51'37"W
L3	72.68	S52°18'29"W
L4	73.50	S58°50'51"W
L5	113.77	S63°39'47"W
L6	81.47	S71°42'32"W
L7	73.19	S77°41'11"W

GRAPHIC SCALE



( IN FEET )  
1 inch = 100 ft.

- ▲ = Railroad Spike Set
- ⊙ = Iron Pin Found
- = Iron Pin Set