

Description Checked for
Mathematical Accuracy
Athens County
ENGINEER'S OFFICE

BY: Chris E. Newman
DATE: 7/30/2020

Exhibit A
1.00 ACRES

Description of a parcel of land situate Ohio Company Purchase, Town 10, Range 15, Section 19, Lee Township, Athens County, Ohio and being more fully described as follows:
Being a parcel deeded to Howard Allen Whitcraft and Shelby Whitcraft,
Official Record Book 538, page 1056.
Parcel H010010010800

Commencing at a concrete monument at the northeast corner of the Southwest Quarter of Section 19;
Thence S03°57'30"E 914.33 feet to an iron pin found;
Thence S86°39'57"E 120.78 feet to an iron pin found at the point of beginning of the parcel herein described;

- 1.) Thence S86°39'57"E 179.91 feet along a common boundary to Arbaugh 548-2339 and Whitcraft 538-1058 to a point in Township Road 1, Crabtree Rd;
- 2.) Thence S07°36'45"W 242.79 feet along a common boundary to Wires 457-411 and Whitcraft 538-1058, to an iron pin set, passing an iron pin set at 22.09 feet;
- 3.) Thence N86°39'57"W 179.91 feet along said common boundary to an iron pin found;
- 4.) Thence N07°36'45"E 242.79 feet along a common boundary to Scarmack 483-135 and Whitcraft 538-1058 to the point of beginning containing a total of 1.00 acres.

Plat of Survey is attached herewith and made a part thereof.
Subject to all easements, rights-of-way, and covenants and agreements of record.
All Iron Pins set are 30 inches in length #5 rebar capped" NEWMAN PS 8043"
Basis of bearings the denoted east line of the southwest Quarter of Section 19,
NAD 83 Ohio State Plane, South Grid.
Survey completed by Charles T. Newman, Licensed Professional Surveyor 8043 on July 21, 2020.

Charles T. Newman
Charles T. Newman PS
66 Elmwood Place
Athens, Ohio 45701

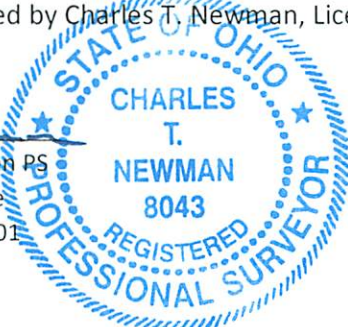

Legal Description Pre-Approval
APPROVED
All transfers are subject to
Athens County Conveyance Standards

JUL 29 2020

Jill Thompson
Athens County Auditor

C. TIM NEWMAN

Professional Surveyor

66 Elmwood Place
Athens, Ohio 45701

740-594-1884
FAX 740-594-9413

Plat of Survey of 1.00 Acres
Sitate Ohio Company Purchase, Town 10, Range 15, Section 19,
Lee Township, Athens County, Ohio.
Deeded to: Howard Allen Whitcraft and Shelby Whitcraft,
Official Record Book 538, page 1056.
Parcel H010010010800
2525 Crabtree Rd., Albany, Ohio



Charles T. Newman
Charles T. Newman
Surveyed 7/21/2020

Description Checked for
Mathematical Accuracy
Athens County
ENGINEER'S OFFICE

BY: *[Signature]*
DATE: 7/30/2020

Legal Description Pre-Approval
APPROVED
All transfers are subject to
Athens County Conveyance Standards

JUL 29 2020

Jill Thompson
Athens County Auditor

NE Corner
SW Quarter
Section 19

NAD 83 OHIO SOUTH

S 03°57'30" E 914.33'

Crabtree Rd. T-1

Arbaugh 548-2339

120.78' S 86°39'57" E 179.91'

S 86°39'57" E 1094.75'

1.000 ACRE

N 07°36'45" E 242.79'

S 07°36'45" W 242.79'

Scarmack 483-135

N 86°39'57" W 179.91'

Wires 457-411

- ▲ Railroad Spike Found
- ▲ Iron Pin Found Pipe 1/2"
- Iron Pin Found capped Bayha
- Iron Pin Set capped NEWMAN
- Iron Pin Found capped Cantina
- ⊙ Concrete Monument Found

GRAPHIC SCALE



(IN FEET)

1 inch = 100 ft.