



# SOUTHEASTERN LAND SURVEYS

THOMAS C. TRANTINA  
REGISTERED PROFESSIONAL LAND SURVEYOR

Instrument Book Page  
200700000444 DR 406 2226

RM.301 SCCA BLDG., 2380 OLD RT.33  
SHADE, OHIO 45776 740/593-8701

Situated in Lots 47, 48 and 65 of the Village of Albany, Section 2, Lee Township, Town 10, Range 15, Athens County, Ohio and described as follows:

Commencing at a set iron pin on the south line of Alton Street at the northeast corner of Lot 46 of the Village of Albany and a tract (Tract I) conveyed to Richard G. and Bernita I. Stotts (386/39) at the northwest corner of Lot 47 of the Village of Albany and a tract conveyed to Robert L. and Sally Jo Wiley (399/2146 O.R.) THE TRUE POINT OF BEGINNING; thence along the north line of Lot 47 and Lot 48 of the Village of Albany and north line of said Wiley Tract (399/2146 O.R.) and the south line of said Alton Street

North 87 Degrees 00 Minutes 00 Seconds East a distance of 86.55 feet to a set iron pin ;  
thence along a new line the following two bearings and distances:

- 1) South 03 Degrees 45 Minutes 00 Seconds West a distance of 48.54 feet to a set iron pin ; thence
- 2) South 33 Degrees 06 Minutes 36 Seconds West a distance of 40.06 feet to a set iron pin

on the southerly line of said Wiley tract (399/2146 O.R.) and Lot 65 of the Village of Albany on the northerly line of a tract conveyed to the General Telephone Company of Ohio (247/579) and northerly line of Lot 66 of the Village of Albany; thence along the southerly line of said Wiley tract (399/2146 O.R.) and Lot 65 of the Village of Albany and the northerly line of said General Telephone Company of Ohio tract (247/579) and northerly line of Lot 66 of the Village of Albany

North 56 Degrees 30 Minutes 19 Seconds West a distance of 13.00 feet to a set iron pin

on the south line of aforesaid Lot 47 at the northwest corner of Lot 65; thence along the westerly line of said General Telephone Company of Ohio tract (247/579), the northerly line of said Lot 66 and the south line of Lot 47 and southerly line of aforesaid Wiley tract (399/2146 O.R.)

North 85 Degrees 53 Minutes 55 Seconds West a distance of 55.02 feet to a set iron pin

at the southwest corner of Lot 47 and said Wiley tract (399/2146 O.R.) and southeast corner of aforesaid Stotts tract (Tract I) (386/39) and Lot 46; thence along the west line of said Lot 47 and Wiley tract (399/2146 O.R.) and the east line of said Lot 46 and Stotts tract (Tract I) (386/39)

North 03 Degrees 45 Minutes 00 Seconds East a distance of 66.50 feet to the point of beginning

and containing 0.138 acres (5992.277 square feet) and being a part of a tract conveyed to Robert L. and Sally Jo Wiley and described in Volume 399 Page 2146 of the Athens County Official Deed Records, consisting of 0.096 acre in Lot 47, 0.04 acre in Lot 48 and 0.002 acre in Lot 65 of the Village of Albany.

Note: Unless otherwise noted, all set iron pins are 5/8-inch diameter rebar and 30 inches in length and capped with a yellow plastic identification marker inscribed " TOM TRANTINA RLS-8320."

The above description was prepared under the supervision of Thomas Trantina, Registered Professional Land Surveyor No. 8320 and based on a survey performed by Southeastern Land Surveys dated December 7, 2006.

Subject to all deeds and right of ways, reservations, restrictive and protective covenants, utility easements and oil, gas and mineral leases of record in the chain of title in Athens County.

Checked for  
Math & Dist Accuracy  
Athens County  
ENGINEER'S OFFICE  
BY: J. Blaus  
DATE: 12-8-06

**Property**

**Boundary**

**Construction**

BY: S. Blawie  
 DATE: 12-8-06



# SOUTHEASTERN LAND SURVEYS

THOMAS C. TRANTINA  
 REGISTERED PROFESSIONAL LAND SURVEYOR

RM. 301 SCCA BLDG., 2380 OLD RT. 33  
 SHADE, OHIO 45776 740/593-8701

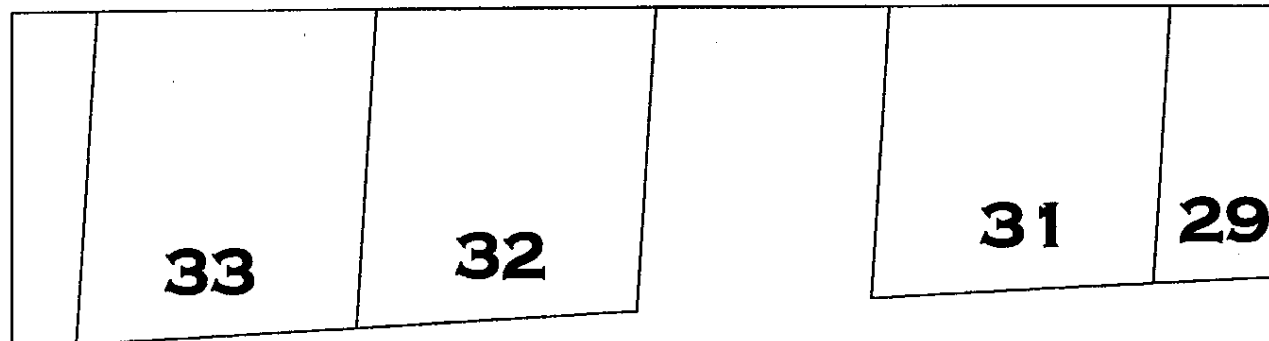

**ALTON ST.**

POINT OF COMMENCEMENT &  
 TRUE POINT OF BEGINNING  
 THE N.W. CORNER OF LOT 47

RICHARD G. &  
 BERNITA I. STOTTS  
 386-39

ROBERT L. & SALLY J.  
 WILEY  
 -2146 D. R.

**0.138 AC. 399**  
**(5992.277 SQ. FT.)**

**46**

**47**

**48**

(TRACT 1)

GENERAL TELEPHONE COMPANY  
 OF OHIO  
 247-579

**65**

**66**

**WASHINGTON ROAD**

LINE	BEARING	DISTANCE
L1	N 87°00'00" E	86.55'
L2	S 03°45'00" W	48.54'
L3	S 33°06'36" W	40.06'
L4	N 56°30'19" W	13.00'
L5	N 85°53'55" W	55.02'
L6	N 03°45'00" E	66.50'

**SURVEY NOTES:**

- 1) ALL SET IRON PINS ARE 5/8" DIA. REBAR, 30" LONG WITH YELLOW PLASTIC I. D. CAP INSCRIBED: "TOM TRANTINA RLS-8320"
- 2) BASIS OF BEARING IS N 87°00' E ALONG ALTON STREET.
- 3) BEARINGS ARE TO AN ASSUMED MERIDIAN AND USED TO DENOTE ANGULAR RELATIONSHIP ONLY.
- 4) REFERENCES USED: SURVEYS BY HAROLD WHALEY, GERALD BAYHA, MICHAEL KINNISON, E. H. MOORE & S. B. PRUDEN AND A SURVEY MADE IN APRIL 23, 1907 BY S. H. HIBBARD, ATHENS COUNTY SURVEYOR, & OTHER COUNTY SURVEYS OF RECORD. -TAX PLATS AND DEEDS OF RECORD -EXISTING MONUMENTATION

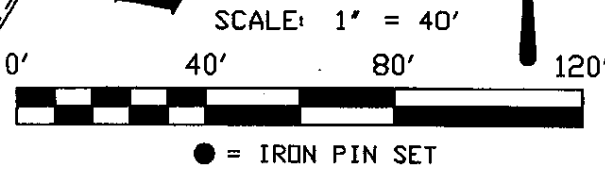

THIS SURVEY WAS PERFORMED WITHOUT THE BENEFIT OF A LAWYER'S TITLE SEARCH IN REGARD TO UTILITY LINES AND RIGHT OF WAYS. BEFORE ANY CONSTRUCTION CONTACT THE OHIO UTILITY PROTECTION SERVICE (1/800-362-2764) FOR THE LOCATION OF ANY UNMARKED UTILITY LINES.

**Plat of** SURVEY OF A 0.138 ACRE TRACT

Scale: 1" = 40'

Surveyed for: ROBERT J. & SALLY JO WILEY Date: 12/07/06

Subdivision LOT 47, 48 AND LOT 65, VILLAGE OF ALBANY

Township LEE Section 2 Town 10 Range 15

Corporation VILLAGE OF ALBANY County ATHENS Ohio

Thomas C. Trantina Job No. 11012306

Thomas C. Trantina Reg. P.L.S. No. 8320



# SOUTHEASTERN LAND SURVEYS

THOMAS C. TRANTINA  
REGISTERED PROFESSIONAL LAND SURVEYOR

RM.301 SCCA BLDG., 2380 OLD RT.33  
SHADE, OHIO 45776 740/593-8701

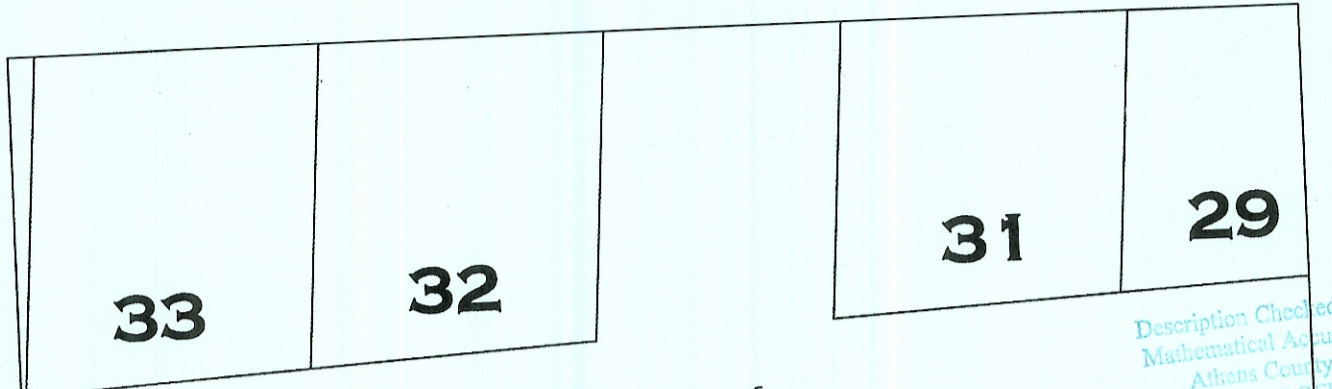

## ALTON ST.

Description Checked for  
Mathematical Accuracy  
Athens County  
ENGINEER'S OFFICE

BY: *S. Blausch*  
DATE: 11-20-06

POINT OF COMMENCEMENT:  
N.W. CORNER OF LOT 48

P.O.B.

(JOHNNY LEE  
SWEARINGEN  
278-147)

EAST LOT LINE  
R/W LINE

ROBERT L. & SALLY J.  
WILEY  
399-2146 D. R.

0.159 ACRES  
(6940.342 SQ. FT)

46

47

48

(0.124 AC.)

65  
(0.035 AC)

GENERAL TELEPHONE COMPANY  
OF OHIO  
247-579

# WASHINGTON ROAD

LINE	BEARING	DISTANCE
L1	N 87°00'00" E	36.02'
L2	S 53°50'35" E	54.29'
L3	S 31°31'25" W	101.16'
L4	N 56°30'19" W	62.32'
L5	N 33°06'36" E	40.06'
L6	N 03°45'00" E	48.54'
L7	N 87°00'00" E	26.49'

### SURVEY NOTES:

- ALL SET IRON PINS ARE 5/8" DIA. REBAR, 30" LONG WITH YELLOW PLASTIC I. D. CAP INSCRIBED: "TOM TRANTINA RLS-8320"
- BASIS OF BEARING IS N 87°00' E ALONG ALTON STREET.
- BEARINGS ARE TO AN ASSUMED MERIDIAN AND USED TO DENOTE ANGULAR RELATIONSHIP ONLY.
- REFERENCES USED: SURVEYS BY HAROLD WHALEY, GERALD BAYHA, MICHAEL KINNISON, E. H. MOORE & S. B. PRUDEN AND A SURVEY MADE IN APRIL 23, 1907 BY S. H. HIBBARD, ATHENS COUNTY SURVEYOR, & OTHER COUNTY SURVEYS OF RECORD. -TAX PLATS AND DEEDS OF RECORD -EXISTING MONUMENTATION

SCALE: 1" = 40'

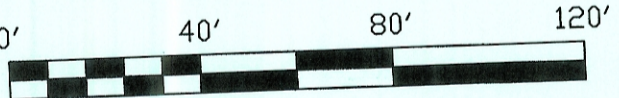

- = IRON PIN SET
- = IRON PIN FOUND
- ⊙ = CONCRETE R/W MONUMENT FOUND
- = A CORNER POINT

⊙ (CONC. R/W MONT.)



Plat of SURVEY OF A 0.159 ACRE TRACT Scale: 1" = 40'

Surveyed for: ROBERT J. & SALLY JO WILEY Date: 11/20/06

Subdivision: LOT 48 AND LOT 65, VILLAGE OF ALBANY

Township: LEE Section: 2 Town: 10 Range: 15

Corporation: VILLAGE OF ALBANY County: ATHENS Ohio

*Thomas C. Trantina* Job No. 11012306

Thomas C. Trantina Reg. P.L.S. No. 8320