

Parcel 2

Description of 0.333 acres

Situated in Section 2, town 10, Range 15, Lee Township, Athens County, Ohio and begin more particularly described as follows;

Commencing at the Northeast Corner of Lot #1 of the Colburn Subdivision;

Thence N 23°53'22" W 173.63' to the centerline of Clinton Street;

Thence along the centerline of Clinton Street N 65°54'00" E 143.06 feet to the True Point of Beginning of the tract herein described;

Thence continuing along the centerline of Clinton Street N 65°54'00" E 48.47 feet to a point;

Thence leaving the road along a new line across Parcel Two as described in Volume 413, Page 1778 Official Records of Athens County S 23°44'38" E 299.81 feet to an iron pin set on the line common to Willoughby (OR 413-1778) and Ploutz (OR 327-1358), passing an iron pin set at 30.00 feet;

Thence along said the line common to Willoughby (OR 413-1778) and Ploutz (OR 327-1358), S 58°16'08" W 47.98 feet to an iron pin found;

Thence leaving said line along the line common to Willoughby (OR 413-1778) and Willoughby (OR 437-2524), N 23°55'18" W 306.18 feet to the True Point of Beginning (passing an iron pin found at 276.05 feet).

The above described tract contains 0.333 acres and is part of the parcel having Auditor's Permanent Parcel No. H020010000704.

Iron pins set are 30" x 5/8" rebar capped "Newman 8043".

*Gregory K. Wright*  
Gregory K. Wright  
11684 Channingway Blvd.  
The Plains, OH 45780  
S-6535

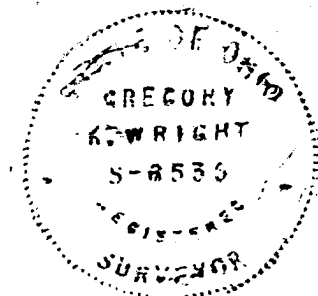

Description Checked for  
Mathematical Accuracy  
Athens County  
ENGINEER'S OFFICE  
BY: *S. Blausen*  
DATE: *6-18-10*

N24°00'10"W  
318.59'

Kenneth E. Willoughby and  
Mona B. Willoughby  
OR 437-2524

93.06'

N23°55'18"W  
306.18'

Parcel 2  
14,542 sq. ft.  
0.333 acres

S23°44'38"E  
299.81'

Parcel 1  
14,545 sq. ft.  
0.333 acres

S23°58'25"E  
293.15'

Clinton Street

174.29'

Kenneth E. Willoughby and  
Mona B. Willoughby  
OR 413-1778

268.47'  
S26°05'05"E

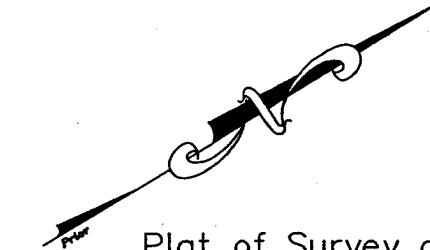

Plat of Survey of Two Tracts  
Situated in Section 2, Town 10, Range 15  
Lee Township, Athens County,  
Surveyed June 10, 2010

*Gregory K. Wright*  
Gregory K. Wright  
S-6535

GRAPHIC SCALE

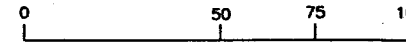

1 inch = 50 ft.

⊙ = Iron Pin Found

● = 5/8" Rebar Set  
capped "Newman 8043"



Description Checked for  
Mathematical Accuracy  
Athens County  
ENGINEER'S OFFICE  
BY: *S. Blouse*  
DATE: *6-18-10*

93.47'

S58°16'08"W

Paul F. & Geri J. Ploutz  
OR 327-1358

47.98'

50.13'

186.39'  
S58°14'27"W



Gregory K. Wright

Professional Engineer  
Professional Surveyor

11684 Channingway Blvd  
The Plains, Ohio 45780  
740-797-4777  
MOBILE 740-590-0529