

DESCRIPTION OF A 79.51 ACRE TRACT

EXHIBIT A, p. 1

Situated in Sections 5,6,12, T.4, R.13, Lodi Township, Athens County, Ohio and being all of the Second Tract (Parts 1,2,3,4) as recorded in 456-1457 of the Official Records of Athens County, Ohio and being more particularly described as follows:

Beginning at a stone found at the South-west corner of Section 6,  
 Thence, along the west-line of said section and the lines of Deeter (303-814 O.R.)  
 N 2° 55' 34" E, 378.73 feet to an iron pin set;  
 N 87° 10' 44" W, 1341.75 feet to an iron pin set;  
 S 3° 09' 36" W, 372.16 feet to an iron pin set in the South-line of Section 12;  
 Thence, along said section-line and the North-line of O'Brien (190-170 O.R.)  
 N 86° 53' 55" W, 1341.66 feet to an iron pin set;  
 Thence, along the East-line of Coppola (58-630 O.R.)  
 N 2° 59' 13" E, 1339.54 feet to a stone found;  
 Thence, through the R.K Retreat LLC land  
 S 87° 10' 44" E, 2683.50 feet to an iron pin found;  
 Thence, along the line of Pennington (125-519 O.R.)  
 S 86° 48' 44" E, 83.39 feet to a point in Lehoe Road;  
 Thence, along said road:  
 S 45° 51' 55" E, 125.59 feet;  
 S 23° 14' 35" E, 75.78 feet;  
 S 6° 42' 53" E, 131.61 feet;  
 S 0° 33' 15" E, 318.75 feet;  
 S 6° 44' 50" W, 308.26 feet;  
 S 5° 46' 10" E, 150.56 feet;  
 S 15° 03' 47" E, 109.13 feet;  
 Thence, leaving said road and along the South-line of Pennington 440-2004 O.R.  
 S 87° 15' 18" E, 117.64 feet to an iron pin found;  
 Thence, along the west-line of Bartlett (359-241 D.R.)  
 S 8° 27' 40" E, 327.79 feet;  
 Thence, along the lines of Songer (368-2019 O.R.)  
 N 86° 53' 55" W, 19.14 feet;  
 N 7° 18' 18" W, 128.20 feet;  
 N 86° 53' 55" W, 429.05 feet to the point of beginning and containing 79.51 acres.

Subject to all easements and rights of way of record  
 Iron pins set are 5/8" by 30" long rebar  
 Bearings: Grid North N.A.D. 83

The above description is based on a field survey completed August 2012 by  
 John M. Branner P.S. 6805

*John M. Branner*

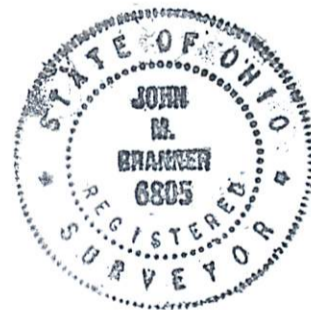

Description Approved  
 Jill A. Thompson  
 Athens County Auditor

1/4/13

Description Checked for  
 Mathematical Accuracy  
 Athens County  
 ENGINEER'S OFFICE  
 BY: S. Blause  
 DATE: 9-7-12

LOT # 5

COPPOLA  
JOSEPH M  
58-630

N 2° 59' 13" E  
1339.54'

S 87° 10' 44" E 2683.50'

PENNINGTON  
125-519 OR.

S 45° 51' 55" E 125.59'  
S 23° 14' 35" E 75.78'  
S 6° 42' 53" E 131.61'

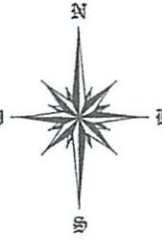

**RK RETREAT L.L.C.**

456-1457 O.R.

79.51 Acres

2nd Tract  
Part#3

2nd Tract  
Part 4

(71.38 AC.) (8.08 AC.)

LEHOE RD.  
318.75'

ANTHONY AND DIANNE PENNINGTON  
440-2004 O.R.

2nd tract  
Part#1

LEHOE RD.  
M 0.5° 44' 09" S  
308.26'

N 87° 10' 44" W  
1341.75'

DEETER WILLIAM  
& PENNY  
303-814OR

S 5° 46' 10" E 150.56'  
S 15° 03' 47" E 109.13'  
S 87° 15' 18" E 117.64'

N 86° 53' 55" W  
1341.66'

O'BRIEN  
190-170 OR.

SEC. 12 SEC. 6 429.05'

BARTLETT VIRGIL H  
359-241

SEC. 11 SEC. 5  
N 2° 55' 34" E 378.73'  
N 86° 53' 55" W 128.20'  
N 7° 18' 18" W 327.79'

SONGER  
WILLIAM E  
368-2019 O.R.

N 86° 53' 55" W  
19.14'

2nd Tract  
Part#2 (0.05 AC.)

SAND RIDGE RD

0' 300' 600' 900'



Scale 1 inch = 300 feet

Survey of a 79.51 Acre Tract  
in Sections 5,6,12,T.4, R.13, Lodi Twp.  
Athens County, Ohio  
Surveyed August 2012

*John M. Branner*  
John M. Branner P.S. 6805  
62 East First Street  
The Plains, Ohio 45780

Description Checked for  
Mathematical Accuracy  
Athens County  
ENGINEER'S OFFICE

BY: *S. Blause*  
DATE: 9-7-12



- △ Iron pin found
  - Iron pin set 5/8"x30" rebar w/ I.D. Cap
  - Stone Found
- Bearings: Grid North, N.A.D. 83  
Ref Docs.: Tax Plat, Deeds

EXHIBIT A, p. 2