



ROBINSON SURVEYING

MEMBER-PROFESSIONAL LAND SURVEYORS OF OHIO
12355 LIARS CORNER ROAD, MILLFIELD, OHIO 45761

ALAN D. ROBINSON
Registered Land Surveyor

TELEPHONE
(740) 593-8774

DESCRIPTION OF A 1.144 ACRE TRACT

Situated in Section 25, Town 6, Range 12, Rome Township, Athens County, Ohio, and being a part of a 25.390 acre tract Surveyed by Alan D. Robinson P.S. 8049 March 26, 2001 and being more particularly described as follows:

Commencing at an iron pin found at the Southeast corner of lot 30 in the Village of Guysville; thence South 2 degrees 28 minutes 14 seconds West, a distance of 375.70 feet to a point in the North Bank of the Hocking river; thence, following the North Bank of said River, South 87 degrees 28 minutes 55 seconds East, a distance of 49.50 feet to an iron pin set; thence North 2 degrees 27 minutes 59 seconds East, a distance of 401.31 feet to an iron pin found; thence, North 2 degrees 27 minutes 59 seconds East along said line, a distance of 104.36 feet to an iron pin found, said iron pin found being the point of curvature of a non-tangent curve, concave to the north, having a radius of 5679.58 feet, a central angle of 2 degrees 13 minutes 34 seconds, and a chord of 220.65 feet bearing North 74 degrees 37 minutes 54 seconds East; thence east along said curve, a distance of 220.66 feet to an iron pin found, said iron pin found being the POINT OF BEGINNING; thence North 16 degrees 43 minutes 21 seconds West, a distance of 69.82 feet to a point in State Route 329, passing an iron pin set at 36.82 feet; thence, following said State Route, North 66 degrees 56 minutes 31 seconds East, a distance of 386.19 feet to a point; thence North 65 degrees 58 minutes 44 seconds East, a distance of 147.83 feet to a point; thence, leaving said Road, South 24 degrees 13 minutes 01 second East, a distance of 108.28 feet to a point, said point being the point of curvature of a non-tangent curve, concave to the north, having a radius of 5679.58 feet, a central angle of 5 degrees 30 minutes 04 seconds, and a chord of 545.11 feet bearing South 70 degrees 46 minutes 05 seconds West; thence west along said curve, a distance of 545.32 feet to the POINT OF BEGINNING, passing an iron pin set at 50.00 feet; said described tract containing 1.144 acres (49,818.7179 square feet).

Bearings are based on previous Surveys and are used to denote angles only.

Subject to all easements and right-of-way of record.

All iron pins set are 5/8 inch by 30-inch long rebar with a yellow cap stamped Alan Robinson RLS 8049.

Alan D. Robinson P.S. 8049 bases the above description on a field Survey completed March 26, 2001,

Alan D. Robinson

Description checked for
Mathematical Accuracy
ATHENS COUNTY
ENGINEER'S OFFICE
BY: *S. Blause*
DATE: *3-26-01*





ROBINSON SURVEYING

MEMBER-PROFESSIONAL LAND SURVEYORS OF OHIO
12355 LIARS CORNER ROAD, MILLFIELD, OHIO 45761

ALAN D. ROBINSON
Registered Land Surveyor

TELEPHONE
(740) 593-8774

DESCRIPTION OF A 25 FEET WIDE EASEMENT FOR INGRESS AND EGRESS

Situated in Section 25, Town 6, Range 12, Rome Township, Athens County, Ohio, and lying in a 1.144 acre tract Surveyed by Alan D. Robinson P.S. 8049 March 26, 2001 and being more particularly described as follows:

Commencing at an iron pin found at the Southeast corner of Lot 30 in the Village of Guysville; thence South 2 degrees 28 minutes 14 seconds West, a distance of 375.70 feet to a point on the North Bank of the Hocking river; thence, following the North Bank of said River, South 87 degrees 28 minutes 55 seconds East, a distance of 49.50 feet to an iron pin set; thence, leaving said RiverBank, North 2 degrees 27 minutes 59 seconds East, a distance of 401.31 feet to an iron pin set; thence, North 2 degrees 27 minutes 59 seconds East along said line, a distance of 104.36 feet to an iron pin found, said iron pin found being the point of curvature of a non-tangent curve, concave to the north, having a radius of 5679.58 feet, a central angle of 2 degrees 13 minutes 34 seconds, and a chord of 220.65 feet bearing North 74 degrees 37 minutes 54 seconds East; thence east along said curve, a distance of 220.66 feet to an iron pin found; thence, North 16 degrees 43 minutes 21 seconds West, a distance of 69.82 feet to a point in State Route 329, passing an iron pin set at 36.82 feet; thence, following said state Route, North 66 degrees 56 minutes 31 seconds East, a distance of 386.19 feet to a point; thence North 65 degrees 58 minutes 44 seconds East, a distance of 64.54 feet to a point, said point being the POINT OF BEGINNING of the following described easement for ingress and egress purposes 25 feet wide lying 12.50 feet on each side of the following described line; thence, leaving said Road, South 42 degrees 35 minutes 26 seconds East, a distance of 112.21 feet to a to the POINT OF ENDING.

Bearings are based on previous Surveys and are used to denote angles only.

Subject to all easements and right-of-way of record.

All iron pins set are 5/8 inch by 30-inch long rebar with a yellow cap stamped Alan Robinson RLS 8049.

Alan D. Robinson P.S. 8049 bases the above description on a field Survey completed March 26, 2001,

Alan D. Robinson



ROBINSON SURVEYING



12355 Liars Corner Rd.
Millfield, Ohio 45761
(740) 593-8774
1-800-296-9984

Darin M. &
Kellie L.
Hayden
266-1136 O.R.

Darin M. &
Kellie L.
Hayden
207-278 O.R.

Richard L.
Hines
241-480 O.R.

Steve E. & Tamara K.
Lucas
142-4 O.R.
376-569 D.R.

State Route 329

1.144 Acres

Steve E. & Tamara K.
Lucas 218-334 O.R.
1.695 Acres Survey
(1.704 Acres Deed)

James B.
Hays
113-754 O.R.

25.390 acres Surveyed
By Alan D. Robinson P.S. 8049
3/26/2001

Southeast corner
of Lot 30 in the
Village of Guyssville

Curve	Delta Angle	Radius	Arc	Tangent	Chord	Chord Bearing
1	2°13'34"	5679.56	220.66	110.35	220.65	N 74°37'54" E
2	5°30'04"	5679.58	545.32	272.87	545.11	S 70°46'05" W
3	7°32'24"	5779.58	760.59	380.85	760.05	S 72°16'14" W

Line	Bearing	Distance
1	S 87°28'55" E	49.50'
2	N 16°43'21" W	69.82'

S 2°28'14" W
375.70'

N 2°27'59" E
401.31'

- = Iron Pin Set W/A Yellow Cap
Stamped Alan Robinson RLS 8049
- = Iron Pin Found
- △ = Rail Road Spike Set
- ▲ = Rail Road Spike found
- ⊠ = Stone Found
- M = Measured
- D = Deed
- C = Calculated

Description checked for
Mathematical Accuracy
ATHENS COUNTY
ENGINEER'S OFFICE
BY: *S. Blauzer*
DATE: *3-26-01*

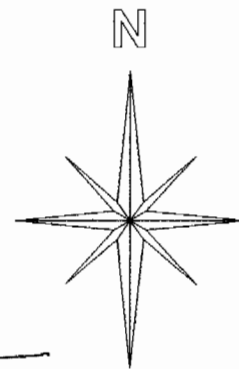

Graphic Scale



1 INCH = 100 FEET

References

Deeds as Noted
Previous Surveys
Current Tax Plats
Existing Monumentation

BEARING REFERENCE

BASED ON PREVIOUS SURVEYS AND
ARE USED TO DENOTE ANGLES ONLY

Plat of Survey of a 1.144 Acre tract

Surveyed for: James Hays Date 03/26/2001

Subdivision:-----

Section 25, Town 6, Range 12, Rome Township

Athens County, State of Ohio

Alan D. Robinson Registered Professional Land Surveyor No. 8049

Alan D. Robinson

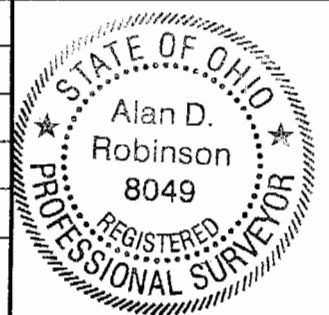

Rom #25