

SCALE 1 INCH = 100 FEET
 ● = IRON PIN SET
 ○ = IRON PIN FD.
 ASSUMED BEARINGS
 TO BE USED TO DENOTE
 INTERIOR ANGLE ONLY

**SURVEY OF A 11.995 ACRE TRACT
 IN SECTION 34, T.6, R.12,
 ROME TOWNSHIP
 ATHENS COUNTY, OHIO
 SURVEYED MAY, 2005**

BY: *John M. Branner*
**JOHN M. BRANNER P.S. 6805
 12500 N. PEACH RIDGE ROAD
 ATHENS, OHIO 45701
 (740) 592-5778**

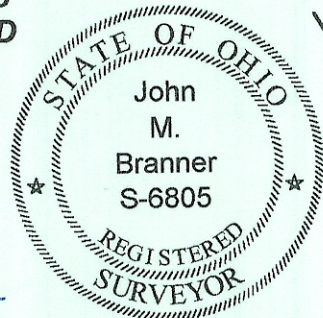

Description Checked for
 Mathematical Accuracy
 Athens County
 ENGINEER'S OFFICE

BY: *S. Blause*
 DATE: 5-26-05

EAST COPELAND RD
 TWP. RD 229

BRENDA MCPHERSON
 2.31 AC.
 195-301 O.R.

PART OF
 1ST TRACT
 4TH LOT
 214-283
 (3.19 AC.)

11.995 Acres

1ST TRACT
 6TH LOT
 214-283

1ST TRACT
 1ST LOT
 214-283

KENDREE
 SAMPSON
 48.386 AC.
 287-1352 O.R.

P.O.B
 BEARS
 N 62-54-02W
 2107.72'
 FROM THE
 S.E. COR. OF
 SEC. 34

REFERENCE
 TO THIS PARCEL
 NOT LOCATED

N 88°38'05"E
 259.85'

S 86°42'36"E
 178.36'

S 82°51'11"E
 227.50'

+424.09'

+30.00'

N 25°51'11"E
 446.09'

S 1°00'57"E
 651.81'

COUNTY RD 48
 NEW ENGLAND ROAD

+25.00'

N 47°20'33"W
 66.19'

N 39°26'39"W
 82.13'

N 31°30'10"W
 173.20'

N 25°21'54"W
 51.47'

+626.55'

S 88°16'07"W
 656.55'

34.481 AC.