

PLAT OF DESCRIPTION OF A 3.20 ACRE TRACT
 IN FRACTIONS #2, AND #6, T-6, R-12, ROME
 TOWNSHIP, ATHENS, COUNTY, OHIO

John M. Branner
 JOHN M. BRANNER P.S. 6805
 12500 N. PEACH RIDGE ROAD
 ATHENS, OHIO 592-5778

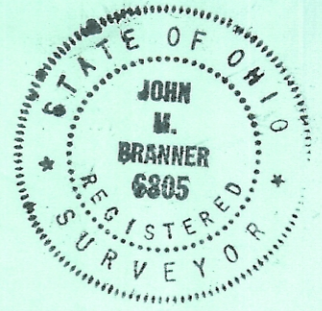

SCALE 1 INCH = 100 FEET



ESTEP
 45 55
 S 67°00'00"E 1324.30'
 3.20 ACRES
 TRANSFER BETWEEN ADJOINING OWNERS
 N 67°00'00"W 1461.94'

*Transfer between adjoining owners.
 No Planning Commission approval required
 Bob Eichenberg
 11/13/92*

