

ENVELOPE: 55A

SCOTT ERVIN SUBDIVISION -
SECTION 14
ATHENS TWP

David Elliot
354-161
10.36 Ac.

Julia M. Deeter
342-203
0.46 Ac.

THE SCOTT ERVIN SUBDIVISION
(6.4 Ac.)

Scale 1" = 50'

- = iron pin set
- = iron pin found
- = stone found

Scott Ervin
790 Ac.
220-602,222-253 & 273-287

Carl L. & Bernice Pratt
Shermer
232-130
335-309
26.59 Ac.

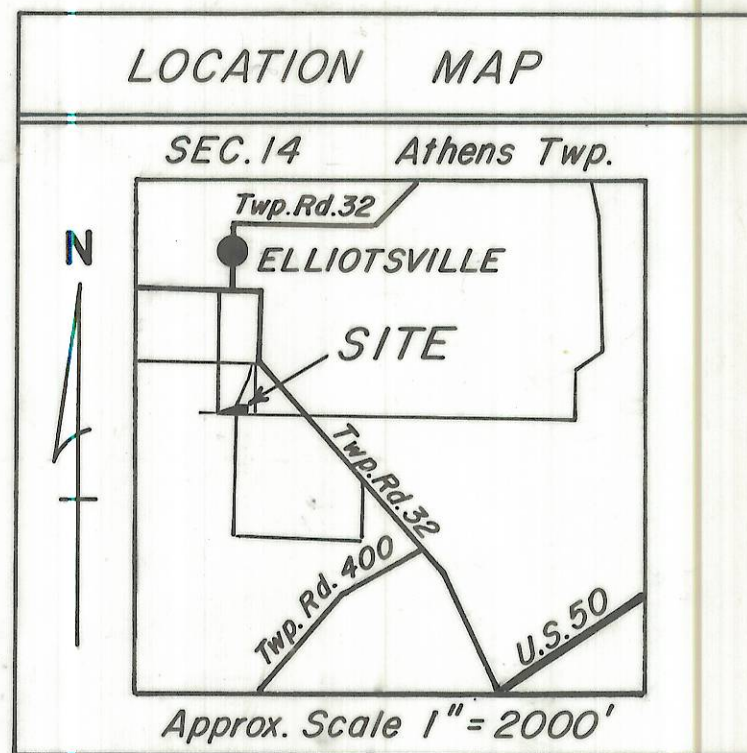

The undersigned SCOTT & PAULINE ERVIN hereby certify that the attached plat correctly represents THE SCOTT ERVIN SUBDIVISION, a subdivision of Lot 1, do hereby accept this plat of same and dedicate to private use the easement shown herein and not heretofore dedicated.

The undersigned further agrees that any use of improvements made on this land shall be in conformity with all existing valid zoning, platting, health, or other lawful rules and regulations including the applicable off-street parking and loading requirements of Athens County, Ohio, for the benefit of himself and all other subsequent owners or assigns taking title from, under or through the undersigned.

In Witness thereof the 13th day of January 1989
Witness William L. Lovelle signed Scott Ervin
John P. Lovelle Pauline Ervin

We do hereby certify that we have surveyed the premises and prepared the attached plat and that said plat is correct.

By Leonard F. Swayer II
Leonard F. Swayer II, Registered Land Surveyor No. 6765

State of Ohio
County of Athens

Before me a Notary Public in and for said County personally came SCOTT & PAULINE ERVIN who acknowledged the signing of the foregoing instrument to be their voluntary act and deed for the purposes therein expressed.

In Witness whereof I have hereunto set my hand and affixed my official seal this 13th day of JAN, 1989

By John P. Lovelle
LIFETIME COMMISSION
NOTARY PUBLIC
STATE OF OHIO

Plat of Lot 1 of THE SCOTT ERVIN SUBDIVISION containing 0.5037 Acre
Situated in Section 14, Town 9, Range 14, Athens Township, Athens County, Ohio.

Grantor claims title to the above by Deed Recorded in Volume 273
Page 287 Athens County Deed Records. & 220-602,222-253

Prepared By
SOUTHEASTERN LAND SURVEYS

For Ronnie and Sharon Ervin - October 18, 1983

Approved this 12th day of December 1983.

James Woodruff
Service Safety Director

Approved this 6th day of February 1983.

Karl W. Pinner
County Regional Planning Commission

Approved this 12th day of December 1983.

Joe Wash
County Board of Health

Approved this 12th day of DECEMBER 1983.

Orville W. Blaylock
County Engineer

Reviewed this 2nd day of MARCH 1985.

Paul W. Weibert
John Alden
Kathryn Walken
Township Trustees

Approved this 2nd day of March 1983

Ronnie Ervin
Sharon Ervin
County Commissioners

Transferred this 30th day of JANUARY 1989

Peter J. Conrads
County Auditor

Filed for Record this 2 day of Feb 1989
at 3:00 m. Recorded this 2 day of Feb 1989
in Plat Book 10 Page No. 108

Env. 55-A
Julius Michael Antz
County Recorder

Approved this 12th day of DECEMBER 1983

George F. Rutherford
City Planning Commission

Stone fd.
laid over