

SEDALIA

# SEDALIA

Sedalia is situated in Fraction 89 2, 3, & 12. Section 89 9 Town 89 11 Range 89 14. Main Street runs with the South line of Fraction 89 12 and all the Streets, lots, and Alleys are either parallel or at right angles with Main Street unless their courses are noted on the plat. The distances are marked in feet. Stones are set at the corners marked on the plat.

Surveyors Office, Athens County Ohio

Scale of 60 ft. to an inch

Athens Ohio Apr. 8. 1882.

I hereby certify that the foregoing is a correct plat and notes of a Survey of the Town of Sedalia.

John Ackley, Co. Surveyor

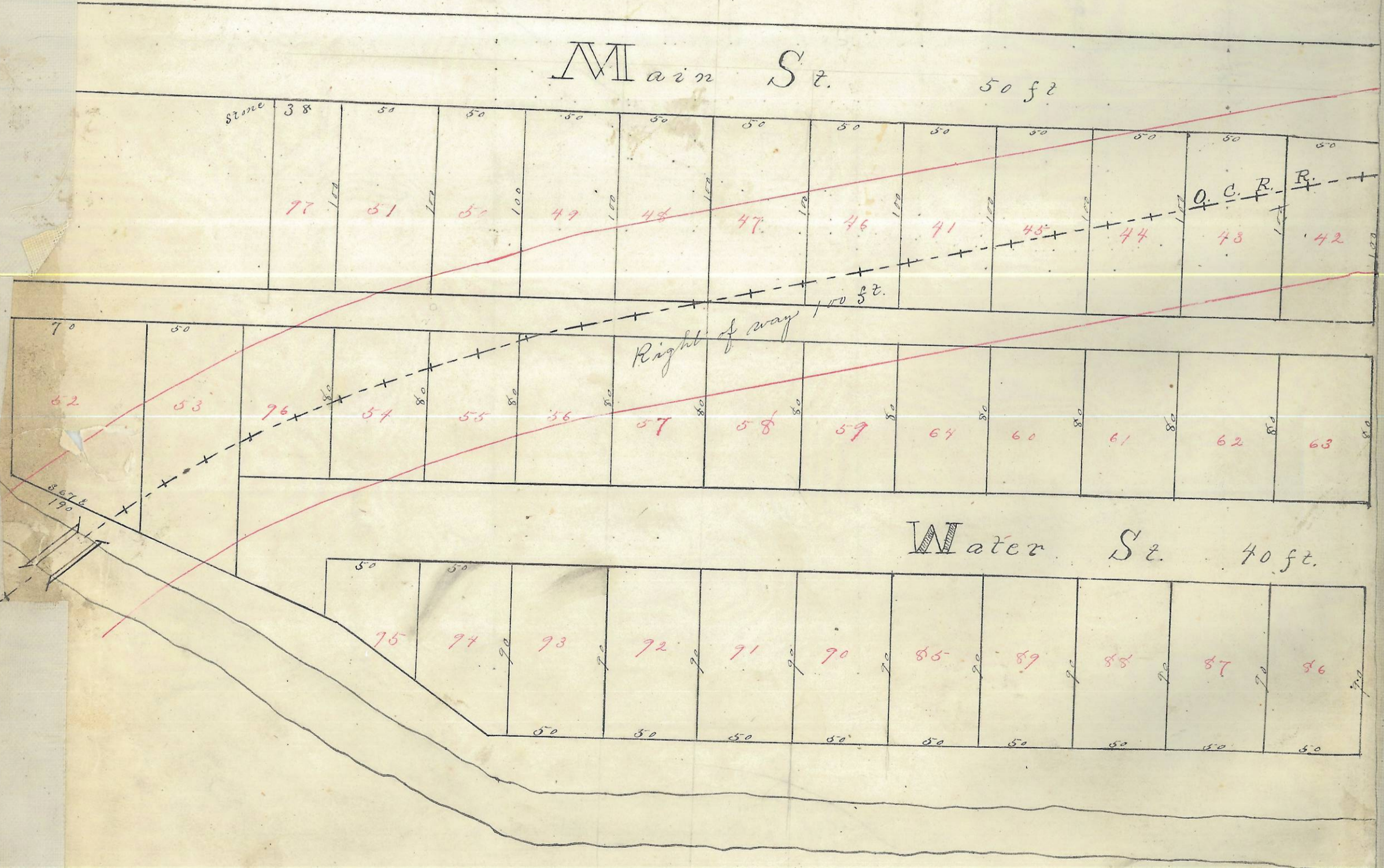

State of Ohio Athens County SS

On the 22<sup>nd</sup> day of May A. D. 1882. Before me a  
 in and for said County personally appeared A. A. Allen, Joel J.  
 Allen, A. J. Allen, J. M. Reutter, and Perley Reutter proprietors  
 of the within described town of Sedalia, and acknowledged the foregoing  
 Plat and Survey to be his voluntary act and deed for the uses and purposes  
 herein designated. Witness my hand and Official Seal at  
 and year above written.

James Reutter  
Notary Public