

Phone 740-753-1264  
Fax 740-753-1264

**Description of a 11.673 Acre Tract**

Situated in the City of Nelsonville and being in Sections 12 and 18, T-12, R-15, York Township, Athens County, State of Ohio and being a part of a tract as described in Volume 324, Page 905 of the Deed Records of Athens County and being more particularly described as follows:

BEGINNING at a PK Nail set in the center of a bridge over Monday Creek on CR-5 that bears South 90°00'00"East, 957.08 feet (calc. from deed), South 0°00'00"West, 1584.57 feet (calc. from deed), and South 79°19'27"West, 524.30 feet (calc. from deed) from the Northwest corner of Section 12,

THENCE along the center of said creek the following 6 courses,  
North 11°42'01"West, 298.96 feet to a point,  
North 0°12'04"East, 199.33 feet to a point,  
North 3°01'09"West, 103.57 feet to a point,  
North 36°46'54"West, 282.19 feet to a point,  
North 48°12'59"West, 405.55 feet to a point,  
North 34°14'41"West, 216.38 feet to a point,

THENCE leaving said creek North 83°29'31"West, 55.00 feet to a Railroad Rail found,

THENCE along a new line South 9°58'48"East, 724.10 feet to an iron pin set on a ridge at the base of a Highwall,

THENCE continuing along said new line South 10°54'51"East, 661.66 feet to a point in the center of CR-5 (passing an iron Pin set at 645.52 feet),

THENCE along the center of said road North 79°27'52"East, 470.32 feet to the point of beginning and containing 11.673 acres of which 7.786 acres is in Section 12 and 3.887 acres is in Section 18.

Bearings are to an assumed meridian and are for angular determination only

Subject to all Easements and Rights of Way of record

Description checked for  
Mathematical Accuracy  
ATHENS COUNTY  
ENGINEERS OFFICE  
BY: *[Signature]*  
DATE: 4/20/00

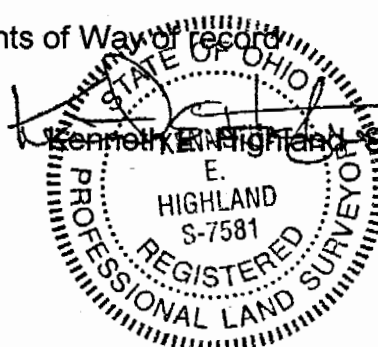

*Nails City # 12*

000058

N.W. corner of  
Section 12

Section 18  
Section 12

USA  
179-319

S 90°00'00"E  
957.08" (Deed)



Scale 1"=200'

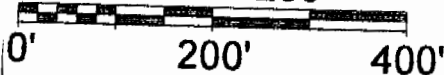

Line	Bearing	Distance
1	N 83°29'31"W	55.00"

○ = Iron Pin Set

⊙ = Railroad Rail Found

▲ = PK Nail Set

S 0°00'00"W  
1584.57" (Deed)

Sullivan  
324-905

11.673 Ac.  
(7.786 Ac.)

Sullivan  
324-905

Sullivan  
324-905

CR-5

+ 645.52' N 79°27'52"E  
470.32"

S 79°19'27"W  
524.30" (Deed)

Description checked for  
Mathematical Accuracy  
ATHENS COUNTY  
ENGINEERS OFFICE  
BY: *K. Anthony*  
DATE: 4/20/00

PLAT OF SURVEY OF A 11.673 Ac. TRACT

SURVEYED FOR MARK FIORELLA

SUBDIVISION -

TOWNSHIP YORIK SECTION 12 & 18 TOWN 12 RANGE 15

CORPORATION NELSONVILLE COUNTY ATHENS STATE OHIO

SCALE 1"= 200 DATE APR. 2000

Kenneth E. Highland  
80 Fayette St.  
Nelsonville, Ohio 45764  
740-753-1264



Kenneth E. Highland S-7581

000059