

BY: Barney J. Fullin  
DATE: 2/12/19

EXHIBIT A  
Description of 0.677 Acres

Description of a tract of land situate the Ohio Company Purchase Town 11, Range 14, Section 8,  
Trimble Township, Athens County, Village of Trimble, Ohio.  
Being the lands deeded to Sherolyn K. Hartley  
Official Record Book 412 pages 19-20,  
Parcel M060020001600, and being more fully described as follows:

Commencing at the southeast corner of Fraction 7 of Section 14, Trimble Township;  
Thence N00°00'00"E 452.64 feet to a 1.5" diameter iron pin;  
Thence S89°00'00"E 1585.00 feet to an iron pin found;  
Thence N74°15'00"E 159.05 feet to an iron pin found at the northeast corner of a 3.04-acre parcel and  
being the point of beginning of the tract herein described;

- 1.) Thence N71°54'08"E 131.08 feet to an iron pin set at the northwest corner of D. Hartley 323-187;
- 2.) Thence S33°23'52"E 207.03 feet along a common boundary to S. Hartley 412-19 and D. Hartley  
323-187 to a point in Center Street, passing an iron pin set at 177.03 feet;
- 3.) Thence S48°41'02"W 127.65 feet to a railroad spike found in Center Street;
- 4.) Thence N33°23'52"W 259.20 feet, passing an iron pin set at 30.00 feet to the point of beginning  
containing a total of 0.677 acres.

Plat of Survey is attached herewith and made a part thereof.  
Subject to all easements, rights-of-way, covenants and agreements of record.  
Basis of bearings the east boundary of a prior survey as denoted on survey plat.  
A True Meridian has NOT been determined.  
The above boundary description was based on an actual field survey and completed by  
Charles T. Newman Professional Surveyor Registered PS-8043 on February 12, 2019.

  
Charles T. Newman  
Professional Surveyor  
66 Elmwood Place  
Athens, Ohio 45701

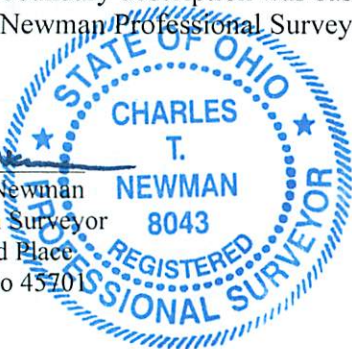

Legal Description Pre-Approval  
**APPROVED**  
All transfers are subject to  
Athens County Conveyance Standards

FEB 12 2019

Jill Thompson  
Athens County Auditor

C. TIM NEWMAN

Professional Surveyor

66 Elmwood Place  
Athens, Ohio 45701

740-594-1884  
FAX 740-594-9413

Plat of Survey of 0.677 Acres  
Situat Ohio Company Purchase Town 11, Range 14,  
Section 8, Trimble Township, Athens County, Villiage of Trimble, Ohio.  
Being dedded to Sherolyn K. Hartley,  
Official Record Book 412, pages 19-20.  
Parcel M060020001600

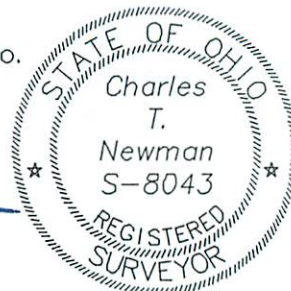

*Charles T. Newman*  
Charles T. Newman  
Surveyed 2/12/2019

Basis of Bearings:  
Prior Survey of 3.04 Acres  
Denoted east boundary of survey  
A True Meridain has NOT been determined



Prior Survey

Terrace Drive

Swoyer Survey 1991  
Palmer  
208-833  
0.289 Acres

David  
Hartley  
323-187

0.677 ACRES

Sherolyn  
Hartley  
412-19

+177.03

+30.00

Fox 458-496  
3.04 Acres  
Southeastern Land Surveys 2011

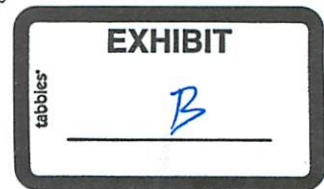

Description Checked for  
Mathematical Accuracy  
Athens County  
ENGINEER'S OFFICE

BY: *Perceval Miller*  
DATE: 2/12/19

Center Street

N 00°00'00" E  
452.64'

S 89°00'00" E  
1585.00'

N 74°15'00" E  
159.05'

N 71°54'08" E  
131.08'

N 33°23'52" W  
259.20'

S 48°41'02" W  
127.65'

S 33°23'52" E  
207.03'

Southeast  
Corner  
Fraction 7  
Section 14  
Trimble Twp.

- ⊙ 1.5" Diameter Iron Pin
- △ Iron Pin Found capped TRANTINA
- ▲ Railroad Spike Found
- ⊙ Iron Pin Found capped SWOYER
- Iron Pin Set capped NEWMAN

GRAPHIC SCALE



( IN FEET )  
1 inch = 100 ft.