



ROBINSON SURVEYING

MEMBER-PROFESSIONAL LAND SURVEYORS OF OHIO
12355 LIARS CORNER ROAD, MILLFIELD, OHIO 45761

ALAN D. ROBINSON
Registered Land Surveyor

TELEPHONE
(740) 593-8774

DESCRIPTION OF TRACT "B" 0.647 ACRE TRACT

Situated in the Village of Glouster, Section 10, Town 11, Range 14, Trimble Township, Athens County, Ohio, and being a part of a 11 acre tract now belonging to John Williams and described in Volume 300 Page 1553 Official Records of Athens County and being more particularly described as follows:

Commencing at a Rail monument found at the Southwest corner of Section 10; thence, following the West line of said Section, North 4 degrees 00 minutes 00 seconds East, a distance of 217.91 feet to an iron pin set; thence, North 4 degrees 00 minutes 00 seconds East along said line, a distance of 372.27 feet to an iron pin set, said iron pin set being the POINT OF BEGINNING of the following described tract; thence, North 4 degrees 00 minutes 00 seconds East along said line, a distance of 127.94 feet to an iron pin set at the Southwest corner of a 0.73 acre tract described in Volume 114 Page 59 Official Records of Athens County; thence, leaving said Section line and following said 0.73 acre tract, South 86 degrees 08 minutes 43 seconds East, a distance of 256.41 feet to an iron pin set in the West side of County Road 31; thence, leaving said 0.73-acre tract and following said West Side of said County Road 31, South 33 degrees 17 minutes 34 seconds East, a distance of 83.65 feet to an iron pin set; thence, leaving said Road, South 82 degrees 34 minutes 39 seconds West, a distance of 313.30 feet to the POINT OF BEGINNING; said described tract containing 0.647 acre (28,193.4367 square feet), and is to be continuous and contiguous with the aforementioned 0.73 acre tract.

Bearings are based on previous Surveys and are used to denote angles only.

Subject to all easements and right-of-way of record.

All iron pins set are 5/8 inch by 30-inch long rebar with a yellow cap stamped Alan Robinson RLS 8049.

Alan D. Robinson P.S. 8049 bases the above description on a field Survey completed September 16, 2000,

Alan D Robinson

Description checked for
Mathematical Accuracy
ATHENS COUNTY
ENGINEER'S OFFICE
BY: *S. Blause*
DATE: *9-18-00*





ROBINSON SURVEYING

12355 Liars Corner Rd.
Millfield, Ohio 45761
(740) 593-8774

"both tracts accessible to public
sewerage"
Ok. to transfer per Athens City Co.
Health Dept.

Chad C. Adams R.S.
9/20/00

OR0324 PAGE 2482

Gregory & Josephine Sikorski 58-521 O.R.
Gary Bragun 90-917 O.R.
Betty Lee & John J. Williams 223-44 D.R. & 114-59 O.R. 0.73 Acres

Tract "B"
0.647 Acres

to be continuous and contiguous with a 0.73 acre tract described in Volume 223 Page 44 D.R. & Volume 114 Page 59 O.R.

Line	Bearing	Distance
1	N 12°17'02"W	117.00'
2	N 8°17'02"W	57.00'
3	S 74°42'58"W	60.00'
4	S 8°59'42"E	31.90'
5	S 86°12'58"W	97.34'
6	S 3°06'47"W	64.27'
7	N 4°00'00"E	127.94'
8	S 33°17'34"E	83.65'
9	N 4°00'00"E	110.20'
10	N 85°30'00"E	91.20'
11	S 25°30'00"E	13.00'
12	N 64°30'00"E	60.00'

Donald J. Eing 283-223
James F. Graham 145-685 O.R.

Tract "A"
9.657 Acres

Margaret Covelle et al. 131-840 & 136-39 O.R.

Checked for
Accuracy
ATHENS COUNTY
ENGINEERING OFFICE

S. Blausie 9-18-00

Rail Monument Found at the Southwest Corner of Section 10

Section 10 6.875 Acres
Section 9 2.782 Acres

Drill Hole in old Concrete Slab
Jeffery A. Eing & Mary T. Hooper 66-256 O.R.

Evelyn Roberts 314-91 D.R.

William F. Dodson 285-475 O.R.

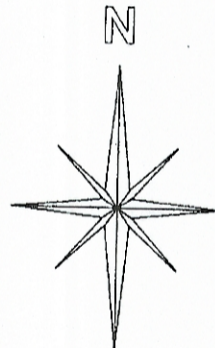

- = IRON PINS SET
- = IRON PINS FOUND
- = DRILL HOLE SET
- ▲ = RAIL MOMUMENT FOUND
- ☒ = STONE FOUND

BEARING REFERENCE
BASED ON PREVIOUS SURVEYS AND ARE USED TO DENOTE ANGLES ONLY

References
Deeds as Noted
Current Tax Plats
Existing Monumentation

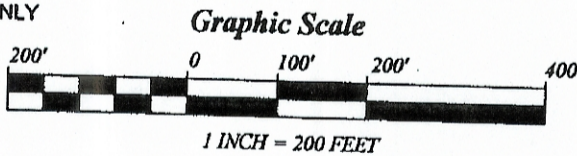

Plat of Survey of Tract "A" 9.657 Acres & Tract "B" 0.647 Acres

Surveyed for: John Williams Date 9/16/00

Village of Glouster

Section 10, Town 11, Range 14, Trimble Township

Athens County, State of Ohio

Alan D. Robinson Registered Professional Land Surveyor No. 8049

Alan D. Robinson

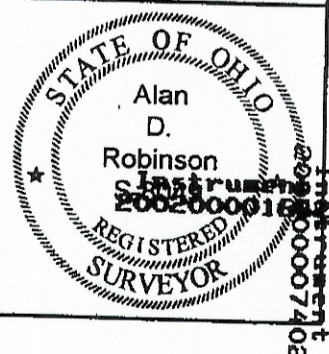

Instrument # 2002000016